

# SF-ASD 16 SET - Battery-powered screwdriver set



1200295

<https://www.phoenixcontact.com/us/products/1200295>

Please be informed that the data shown in this PDF document is generated from our online catalog. Please find the complete data in the user documentation. Our general terms of use for downloads are valid.



Cordless screwdriver in case, incl. battery, charging device 100 ... 240 V, 2 bits, two-speed gearbox, forward/reverse running and 16-stage clutch up to 450 rpm, hexagonal fast connection.

### Your advantages

- 3.6 V
- Cordless screwdriver with two-speed gearbox, forward/reverse running and 16-stage clutch with drilling speed of up to 450 rpm
- Adjustable from 0.2 ... 4.3 Nm
- Comfortable one-handed operation in a straight or angled position
- 6.3 mm hexagonal fast connection
- Compact design
- The set includes: screw bit, E6,3-1/4" drive, crosshead PH 2 x 75 mm and slotted, 0.8 mm x 5 mm x 75 mm

### Commercial data

Item number	1200295
Packing unit	1 pc
Minimum order quantity	1 pc
Sales key	BH32
Product key	BH3243
Catalog page	Page 454 (C-3-2019)
GTIN	4055626666433
Weight per piece (including packing)	1,850 g
Weight per piece (excluding packing)	1,750 g
Customs tariff number	84672920
Country of origin	TW

# SF-ASD 16 SET - Battery-powered screwdriver set



1200295

<https://www.phoenixcontact.com/us/products/1200295>

## Set consists of

### SF-ASD 16 - Cordless screwdriver

1200294

<https://www.phoenixcontact.com/us/products/1200294>



Cordless screwdriver, incl. battery, two-speed gearbox, forward/reverse running and 16-stage clutch up to 450 rpm, hexagonal quick connection.

---

### SF-ASD 16/CHARGER - Charger

1200296

<https://www.phoenixcontact.com/us/products/1200296>



Charger, for 100 ... 240 V mains voltage, recognition of battery and parameter check, rapid charging, short-circuit resistant, polarized, operating mode display

# SF-ASD 16 SET - Battery-powered screwdriver set

1200295

<https://www.phoenixcontact.com/us/products/1200295>



## Technical data

### Notes

Environmental Product Compliance	
California Proposition 65	Further information on California's prop. 65 is available under "Downloads" in the manufacturer's declaration

### Product properties

Product type	Torque tool
Type of packaging	Case
Battery-operated voltage	3.6 V
Battery charging	60 min.

Insulation characteristics	
Protection class	II

### Electrical properties

Power consumption	7.2 W
Nominal voltage U <sub>N</sub>	3.6 V DC
	3.6 V DC

Battery	
Battery charging	60.00 min.
Battery-operated voltage	3.60 V DC
Battery capacity	2.00 Ah

### Connection data

Torque range	0.2 Nm ... 4.3 Nm
Output	Universal, replaceable

### Dimensions

Dimensional drawing	
Width	45 mm
Height	172 mm
Length	266 mm

### Environmental and real-life conditions

Ambient conditions
--------------------

# SF-ASD 16 SET - Battery-powered screwdriver set



1200295

<https://www.phoenixcontact.com/us/products/1200295>

Ambient temperature (operation)	5 °C ... 40 °C
Ambient temperature (storage/transport)	-25 °C ... 60 °C
Permissible humidity (operation)	95 % (<)

# SF-ASD 16 SET - Battery-powered screwdriver set

1200295

<https://www.phoenixcontact.com/us/products/1200295>



## Drawings

Schematic diagram

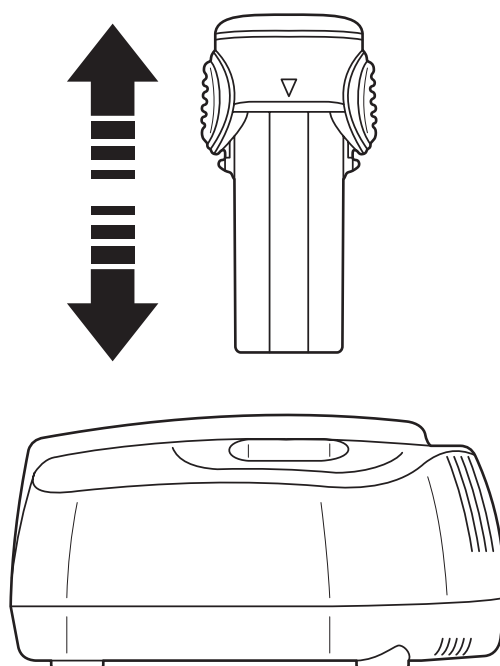

Schematic diagram

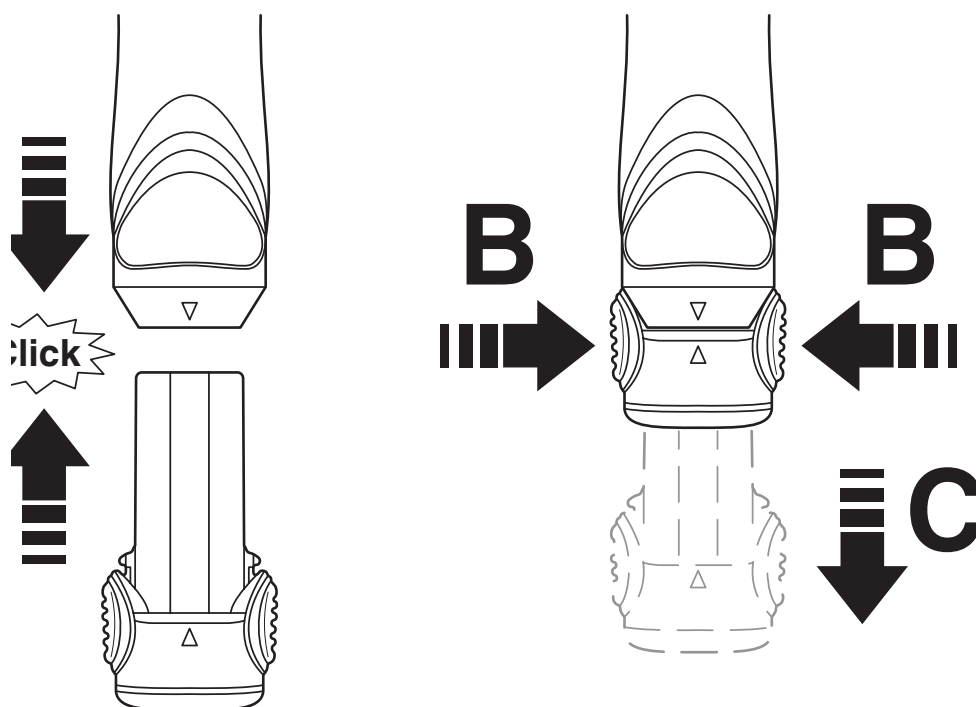

# SF-ASD 16 SET - Battery-powered screwdriver set

1200295

<https://www.phoenixcontact.com/us/products/1200295>



Dimensional drawing

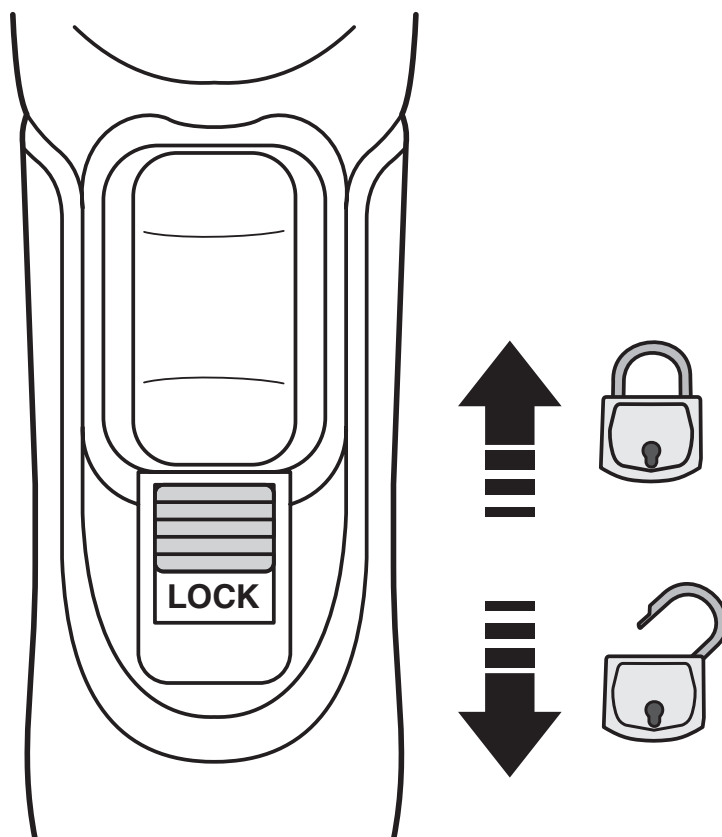

Schematic diagram

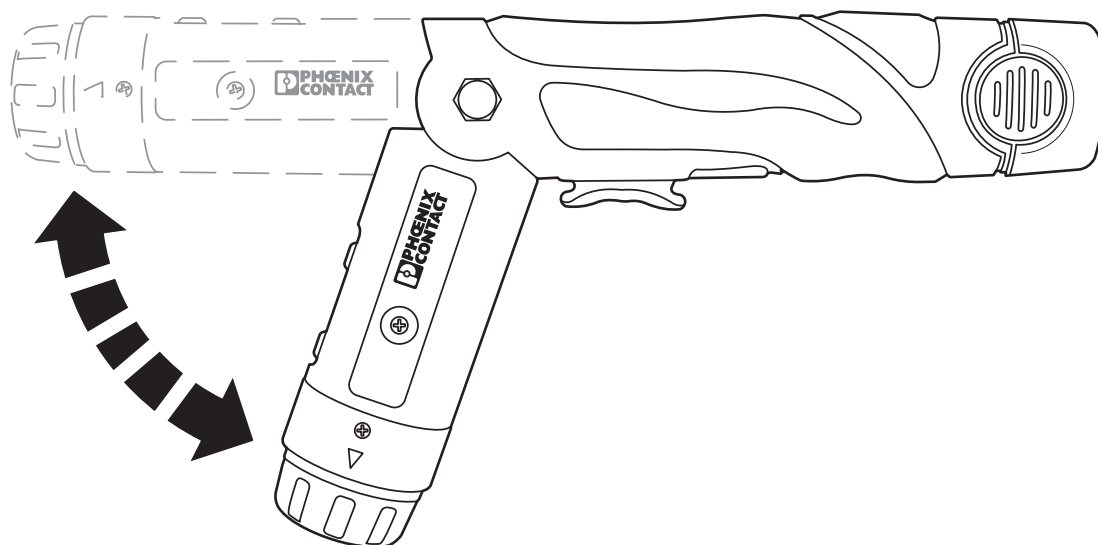

# SF-ASD 16 SET - Battery-powered screwdriver set

1200295

<https://www.phoenixcontact.com/us/products/1200295>



Schematic diagram

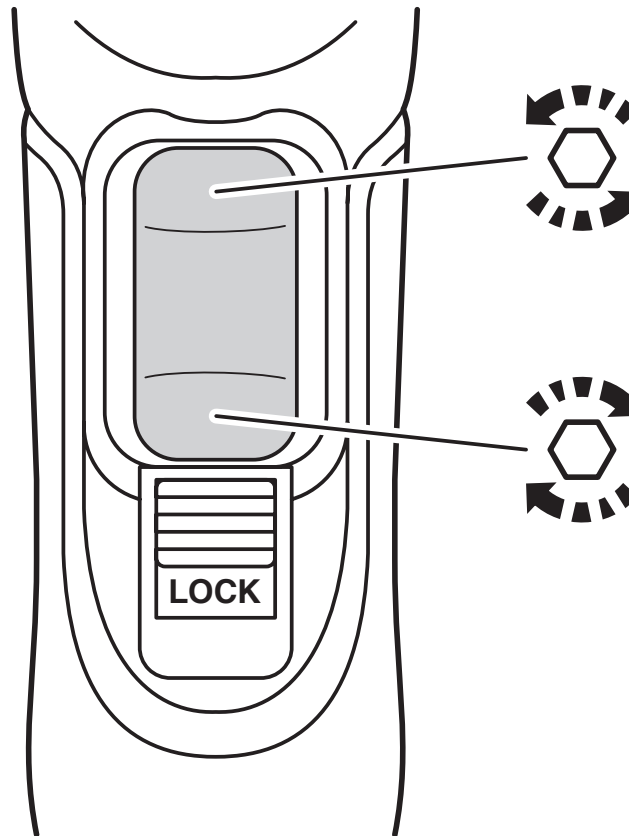

# SF-ASD 16 SET - Battery-powered screwdriver set



1200295

<https://www.phoenixcontact.com/us/products/1200295>

## Approvals

🔗 To download certificates, visit the product detail page: <https://www.phoenixcontact.com/us/products/1200295>



**EAC**

Approval ID: RU C-DE.BE02.B.03066

# SF-ASD 16 SET - Battery-powered screwdriver set



1200295

<https://www.phoenixcontact.com/us/products/1200295>

## Classifications

### ECLASS

ECLASS-11.0	21052190
ECLASS-12.0	21052190
ECLASS-13.0	21050890

### ETIM

ETIM 9.0	EC001395
----------	----------

### UNSPSC

UNSPSC 21.0	27111700
-------------	----------

# SF-ASD 16 SET - Battery-powered screwdriver set



1200295

<https://www.phoenixcontact.com/us/products/1200295>

## Environmental product compliance

REACH SVHC	Lead 7439-92-1
China RoHS	Environmentally Friendly Use Period = 5
	For information on hazardous substances, refer to the manufacturer's declaration available under "Downloads"

Phoenix Contact 2024 © - all rights reserved  
<https://www.phoenixcontact.com>

Phoenix Contact USA  
586 Fulling Mill Road  
Middletown, PA 17057, United States  
(+717) 944-1300  
[info@phoenixcon.com](mailto:info@phoenixcon.com)