

# HC-ADV-B06-HHWH-1TGM25-PL - Housing



1404225

<https://www.phoenixcontact.com/il/products/1404225>

Please be informed that the data shown in this PDF document is generated from our online catalog. Please find the complete data in the user documentation. Our general terms of use for downloads are valid.



Sleeve housing B6, with screw locking, material: PA, cable outlets: 1, straight, M25, height: 93.7 mm, cable gland: with, Standard

## Your advantages

- Integrated screw connection
- Lower costs than metal version
- Low weight
- Lower risk of condensation

## Commercial data

Item number	1404225
Packing unit	1 pc
Minimum order quantity	1 pc
Product key	BF7APG
Catalog page	Page 596 (C-2-2019)
GTIN	4046356681964
Weight per piece (including packing)	125.1 g
Weight per piece (excluding packing)	124.95 g
Customs tariff number	85389099
Country of origin	DE

# HC-ADV-B06-HHWH-1TGM25-PL - Housing



1404225

<https://www.phoenixcontact.com/il/products/1404225>

## Technical data

### Notes

General	for contact inserts HC-B06, BB10, DD24, M
---------	---

### Product properties

Product type	Housing with screw locking
Housing type	Sleeve housing
Application	Standard
Type	B6
No. of cable outlets	1
Type of the screw connection	M25
Type	Tall design
Fixing screws	M6 (screw head: 5 mm Allen screw)
Shielded	no
Cable outlet	straight
Pg screw connection	with

### Connection data

External cable diameter	9 mm ... 17 mm
Tightening torque	3 Nm ... 5 Nm (for M6 mounting screws on the sleeve housing)
Tightening torque, union nut	5.00 Nm

### Dimensions

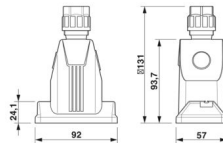
Dimensional drawing	
Width	57 mm
Height	93.7 mm
Length	92 mm
Wrench size, union nut	26 mm

### Installation dimensions

Width of the assembly cutout	35 mm
Length of the assembly cutout	52 mm

### Material specifications

Material Pressure screw	PA
Flammability rating according to UL 94	V0 (Housing)
Seal material Profile gasket	NBR
Seal material Cable seal	NBR
Housing material	PA

# HC-ADV-B06-HHWH-1TGM25-PL - Housing



1404225

<https://www.phoenixcontact.com/il/products/1404225>

Locking latch material	Stainless steel
Material of locking screw	Stainless steel

## Environmental and real-life conditions

### Ambient conditions

Degree of protection	IP66
	IP67
Impact strength	IK08
Ambient temperature (operation)	-40 °C ... 100 °C

## Mechanical properties

### Mechanical data

Type of the screw connection	M25
Locking type	Screw

## Cable/line

External cable diameter Cable 1	9 mm ... 17 mm
---------------------------------	----------------

## Mounting

Assembly note	M6 locking screw, with 5 mm Allen screw head
Fixing screws	M6 (screw head: 5 mm Allen screw)

## Drawings

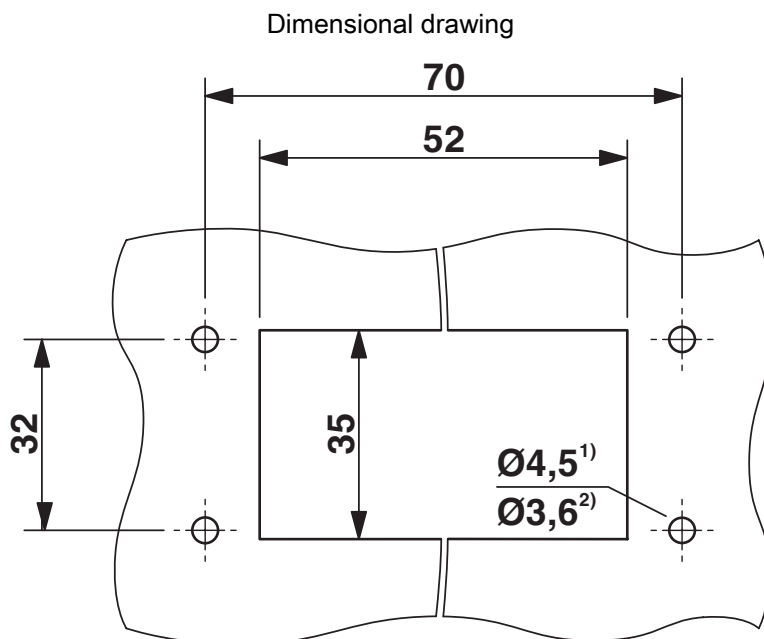

### Mounting cutout

1) when M4 screws are used

2) when self-tapping Torx® screws are used (Torx® 20, M4)

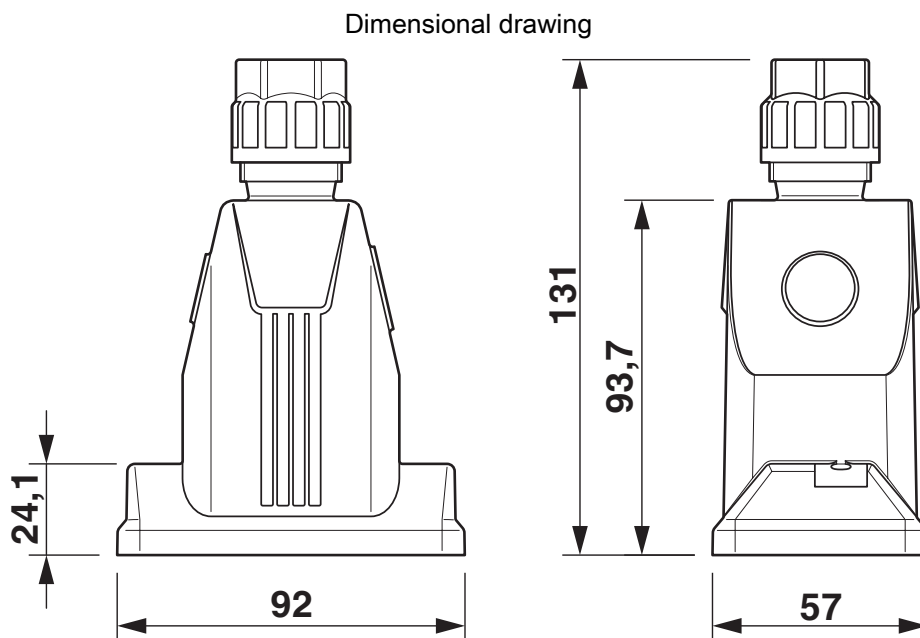

### Dimensional drawing

# HC-ADV-B06-HHWH-1TGM25-PL - Housing





1404225

<https://www.phoenixcontact.com/il/products/1404225>

## Approvals

To download certificates, visit the product detail page: <https://www.phoenixcontact.com/il/products/1404225>

**DNV**  
Approval ID: TAE000037S

**EAC**  
Approval ID: RU C-DE.BL08.B.00511

**cUL Recognized**  
Approval ID: E255026

**UL Recognized**  
Approval ID: E255026

**cULus Recognized**

# HC-ADV-B06-HHWH-1TGM25-PL - Housing



1404225

<https://www.phoenixcontact.com/il/products/1404225>

## Classifications

### ECLASS

ECLASS-11.0	27440202
ECLASS-12.0	27440202
ECLASS-13.0	27440202

### ETIM

ETIM 9.0	EC000437
----------	----------

### UNSPSC

UNSPSC 21.0	31261500
-------------	----------

Environmental product compliance

EU RoHS	
Fulfills EU RoHS substance requirements	Yes, No exemptions
China RoHS	
Environment friendly use period (EFUP)	EFUP-E
	No hazardous substances above the limits
EU REACH SVHC	
REACH candidate substance (CAS No.)	No substance above 0.1 wt%

Phoenix Contact 2024 © - all rights reserved  
<https://www.phoenixcontact.com>

PHOENIX CONTACT Israel Ltd.  
P.O.B. 1799 Industrial Park Hasharon  
Quadima 60920  
+972-9-8915700  
[info@phoenixcontact.co.il](mailto:info@phoenixcontact.co.il)