

HC-ADV-B10-HHWH-1TGM25-PL - Housing



1404227

<https://www.phoenixcontact.com/pc/products/1404227>

Please be informed that the data shown in this PDF document is generated from our online catalog. Please find the complete data in the user documentation. Our general terms of use for downloads are valid.



Sleeve housing B10, with screw locking, material: PA, cable outlets: 1, straight, M25, height: 95 mm, cable gland: with, Standard

Your advantages

- Integrated screw connection
- Lower costs than metal version
- Low weight
- Lower risk of condensation

Commercial data

| | |
|--------------------------------------|---------------------|
| Item number | 1404227 |
| Packing unit | 1 pc |
| Minimum order quantity | 1 pc |
| Product key | BF7APG |
| Catalog page | Page 602 (C-2-2019) |
| GTIN | 4046356681988 |
| Weight per piece (including packing) | 137 g |
| Weight per piece (excluding packing) | 22 g |
| Customs tariff number | 85389099 |
| Country of origin | DE |

HC-ADV-B10-HHWH-1TGM25-PL - Housing



1404227

<https://www.phoenixcontact.com/pc/products/1404227>

Technical data

Notes

| | |
|---------|--|
| General | For contact inserts HC-B10, BB18, DD42, M, K8/24, HV03-I-PT, HC- 3-E...C |
|---------|--|

Product properties

| | |
|------------------------------|-----------------------------------|
| Type | B10 |
| Product type | Housing with screw locking |
| Application | Standard |
| No. of cable outlets | 1 |
| Type of the screw connection | M25 |
| Fixing screws | M6 (screw head: 5 mm Allen screw) |
| Housing type | Sleeve housing |
| Shielded | no |
| Cable outlet | straight |
| Pg screw connection | with |

Connection data

| | |
|------------------------------|--|
| External cable diameter | 9 mm ... 17 mm |
| Tightening torque | 3 Nm ... 5 Nm (for M6 mounting screws on the sleeve housing) |
| Tightening torque, union nut | 5.00 Nm |

Dimensions

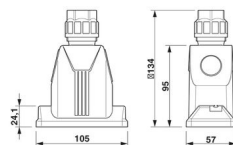
| | |
|------------------------|--|
| Dimensional drawing |  |
| Width | 57 mm |
| Height | 95 mm |
| Length | 105 mm |
| Wrench size, union nut | 26 mm |

Installation dimensions

| | |
|-------------------------------|-------|
| Width of the assembly cutout | 35 mm |
| Length of the assembly cutout | 65 mm |

Material specifications

| | |
|--|-----------------|
| Material Pressure screw | PA |
| Flammability rating according to UL 94 | V0 (Housing) |
| Seal material Profile gasket | NBR |
| Seal material Cable seal | NBR |
| Locking latch material | Stainless steel |

HC-ADV-B10-HHWH-1TGM25-PL - Housing



1404227

<https://www.phoenixcontact.com/pc/products/1404227>

| | |
|---------------------------|-----------------|
| Material of locking screw | Stainless steel |
| Impact strength | IK08 |
| Housing material | PA |

Environmental and real-life conditions

Ambient conditions

| | |
|---------------------------------|-------------------|
| Degree of protection | IP66 |
| | IP67 |
| Impact strength | IK08 |
| Ambient temperature (operation) | -40 °C ... 100 °C |

Mechanical properties

Mechanical data

| | |
|------------------------------|-------|
| Type of the screw connection | M25 |
| Locking type | Screw |

Cable/line

| | |
|-----------------------------------|----------------|
| External cable diameter (Cable 1) | 9 mm ... 17 mm |
| Tightening torque, union nut | 5.00 Nm |

Mounting

| | |
|-----------------------|--|
| Assembly instructions | M6 locking screw, with 5 mm Allen screw head |
| Fixing screws | M6 (screw head: 5 mm Allen screw) |

Drawings

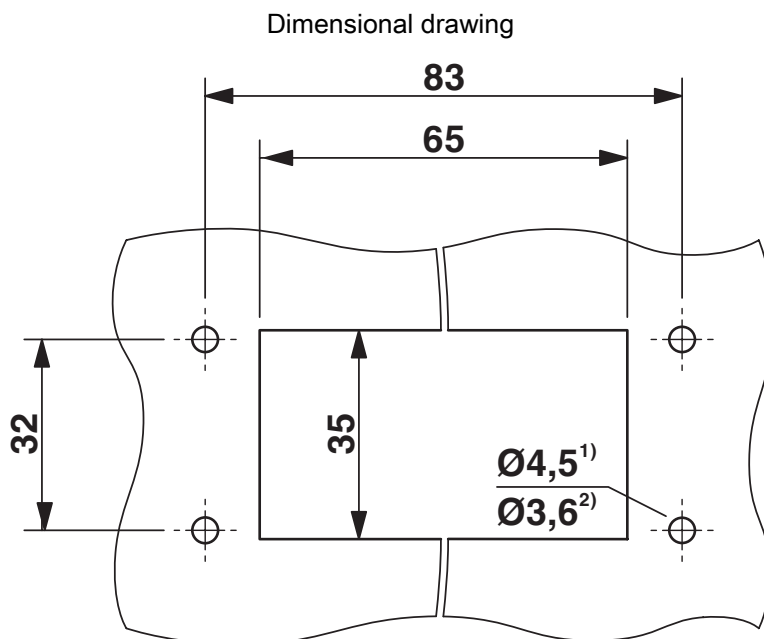

Mounting cutout

1) when M4 screws are used

2) when self-tapping Torx® screws are used (Torx® 20, M4)

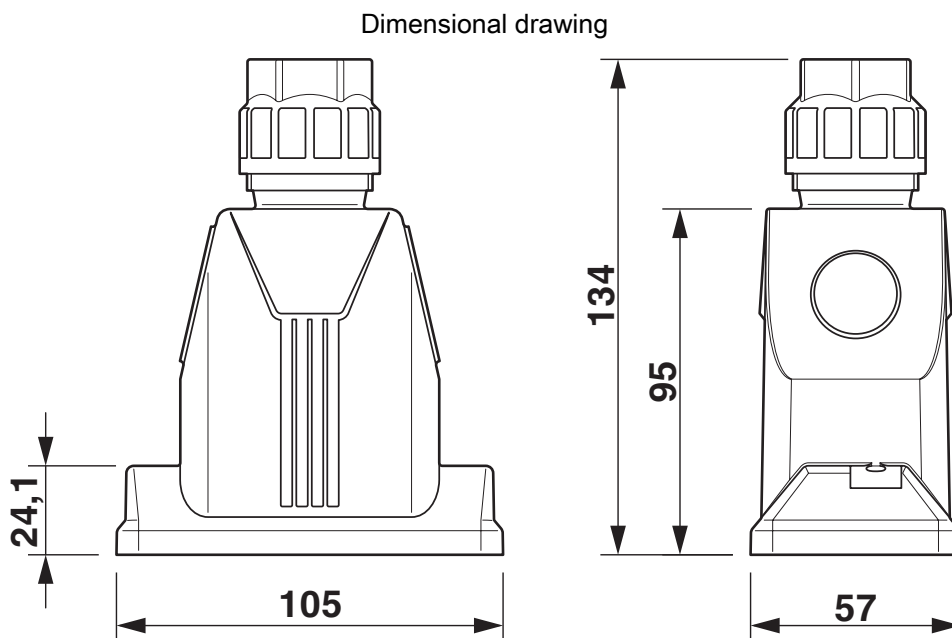

Dimensional drawing

HC-ADV-B10-HHWH-1TGM25-PL - Housing



1404227

<https://www.phoenixcontact.com/pc/products/1404227>

Approvals

🔗 To download certificates, visit the product detail page: <https://www.phoenixcontact.com/pc/products/1404227>

DNV

Approval ID: TAE000037S



EAC

Approval ID: RU C-DE.BL08.B.00511



cUL Recognized

Approval ID: E255026

HC-ADV-B10-HHWH-1TGM25-PL - Housing



1404227

<https://www.phoenixcontact.com/pc/products/1404227>

Classifications

ECLASS

| | |
|-------------|----------|
| ECLASS-11.0 | 27440202 |
| ECLASS-12.0 | 27440202 |
| ECLASS-13.0 | 27440202 |

ETIM

| | |
|----------|----------|
| ETIM 9.0 | EC000437 |
|----------|----------|

UNSPSC

| | |
|-------------|----------|
| UNSPSC 21.0 | 31261500 |
|-------------|----------|

Environmental product compliance

| | |
|------------|---|
| China RoHS | Environmentally friendly use period: unlimited = EFUP-e |
| | No hazardous substances above threshold values |

Phoenix Contact 2024 © - all rights reserved
<https://www.phoenixcontact.com>

PHOENIX CONTACT GmbH & Co. KG
Flachsmarktstraße 8
D-32825 Blomberg
+49 (0) 5235-3 00
info@phoenixcontact.com