

HC-STA-B16-SLWD-2SSM32-ELC-AL - Housing



1412856

<https://www.phoenixcontact.com/us/products/1412856>

Please be informed that the data shown in this PDF document is generated from our online catalog. Please find the complete data in the user documentation. Our general terms of use for downloads are valid.



Box mounting bases B16, with double locking latch, material: Die-cast aluminum, salt water resistant, cable outlets: 2, lateral, 2x M32, height: 68 mm, cable gland: none, Standard

Your advantages

- Good shielding in the event of electromagnetic interference

Commercial data

Item number	1412856
Packing unit	1 pc
Minimum order quantity	1 pc
Sales key	BF56
Product key	BF7APB
Catalog page	Page 623 (C-2-2019)
GTIN	4055626060774
Weight per piece (including packing)	299.2 g
Weight per piece (excluding packing)	288.5 g
Customs tariff number	85389099
Country of origin	PL

HC-STA-B16-SLWD-2SSM32-ELC-AL - Housing



1412856

<https://www.phoenixcontact.com/us/products/1412856>

Technical data

Notes

General	For contact inserts HC-B16, BB32, D40, DD72, HS6, HV6, M, K
General	also available as a powder-coated or color version: 1372644 HC-STA-B16-SLWD-2SSM32-EL/.../...

Product properties

Product type	Housing with locking latch
Housing type	Box mounting bases
Application	Standard
Type	B16
No. of cable outlets	2
Type of the screw connection	2x M32
Type	Low design
Cable outlet	lateral
Pg screw connection	none

Dimensions

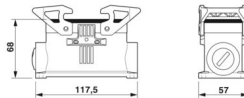
Dimensional drawing	
Width	57 mm
Height	68 mm
Length	117.5 mm
Hole diameter	5.5 mm

Material specifications

Flammability rating according to UL 94	V0 (Interlock)
Seal material	NBR, conductive
Housing material	Die-cast aluminum, salt water resistant
Housing surface material	uncoated
Locking latch material	PA

Mechanical properties

Mechanical data

Type of the screw connection	2x M32
Locking type	Latch

Connection data

Tightening torque	2 Nm ... 3 Nm (for M5 mounting screws on the surface-mount housing)
-------------------	---

Mounting

Assembly note	One opening is sealed with a plastic filler plug and can be opened using a screwdriver.
---------------	---

Environmental and real-life conditions

Ambient conditions	
Degree of protection	IP66
	IP67
Enclosure rating (NEMA)	4 (UL 50e)
	4X (UL 50e)
	12 (UL 50e)
Impact strength	IK09
Ambient temperature (operation)	-40 °C ... 125 °C

HC-STA-B16-SLWD-2SSM32-ELC-AL - Housing

1412856

<https://www.phoenixcontact.com/us/products/1412856>



Drawings

Dimensional drawing

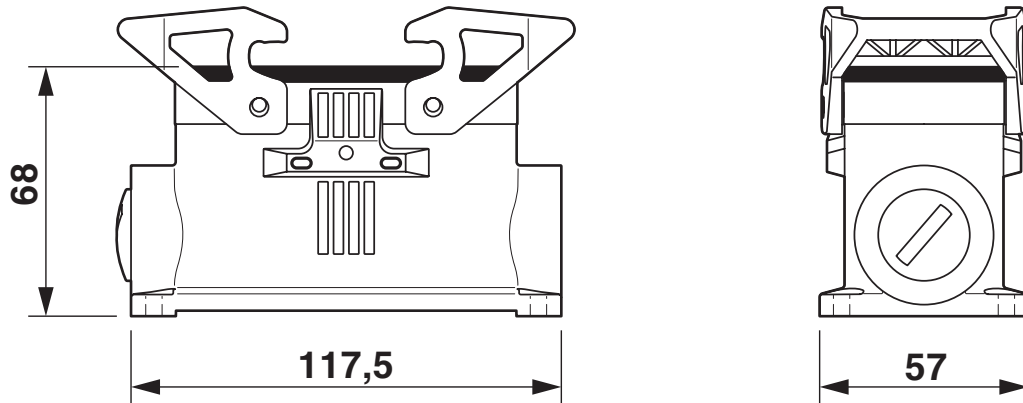

Dimensional drawing

1412856

<https://www.phoenixcontact.com/us/products/1412856>

Approvals

To download certificates, visit the product detail page: <https://www.phoenixcontact.com/us/products/1412856>

**DNV**
Approval ID: TAE000037S

**cUL Recognized**
Approval ID: E255026

**UL Recognized**
Approval ID: E255026

**EAC**
Approval ID: RU C-DE.BL08.B.00511

cULus Recognized

1412856

<https://www.phoenixcontact.com/us/products/1412856>

Classifications

ECLASS

ECLASS-11.0	27440202
ECLASS-12.0	27440202
ECLASS-13.0	27440202

ETIM

ETIM 9.0	EC000437
----------	----------

UNSPSC

UNSPSC 21.0	31261500
-------------	----------

Environmental product compliance

EU RoHS	
Fulfills EU RoHS substance requirements	Yes, No exemptions
China RoHS	
Environment friendly use period (EFUP)	EFUP-E
	No hazardous substances above the limits
EU REACH SVHC	
REACH candidate substance (CAS No.)	No substance above 0.1 wt%

1412856

<https://www.phoenixcontact.com/us/products/1412856>

Accessories

G-INS-M32-M68N-NNES-S - Cable gland

1411166

<https://www.phoenixcontact.com/us/products/1411166>



Cable gland, material for screw connection: Brass, nickel-plated, application: Standard, external cable diameter 15 mm ... 21 mm, shielding: no, connecting thread: M32 x 1.5, color: silver, with O-ring

G-INSEC-M32-M68N-NCRS-S - Cable gland

1411191

<https://www.phoenixcontact.com/us/products/1411191>



Cable gland, material for screw connection: Brass, nickel-plated, application: EMC, external cable diameter 14 mm ... 21 mm, shielding: yes, connecting thread: M32 x 1.5, color: silver, with O-ring

HC-STA-B16-SLWD-2SSM32-ELC-AL - Housing



1412856

<https://www.phoenixcontact.com/us/products/1412856>

HC-B16-SP-CBK - Profile gasket

1411480

<https://www.phoenixcontact.com/us/products/1411480>



Profile gasket for HEAVYCON EVO supporting base element type B16, conductive

HC-STA-B10-24-DL-PLBK - Housing brackets

1412886

<https://www.phoenixcontact.com/us/products/1412886>



Double locking latch for B10 / B16 / B24 housing, HC-EVO....AL and HC-STA....AL

HC-STA-B16-SLWD-2SSM32-ELC-AL - Housing



1412856

<https://www.phoenixcontact.com/us/products/1412856>

HC-B16-BC-HI-PLBK - Protective cover

1407694

<https://www.phoenixcontact.com/us/products/1407694>

Protective cover B16, for single locking latch, protective cover material: PC, height: 19 mm, seal: no



HC-B16-BCFD-P-BK - Protective cover

1346539

<https://www.phoenixcontact.com/us/products/1346539>

Protective cover B16, for double locking latch, protective cover material: PC, height: 26.4 mm, seal: no



HC-STA-B16-SLWD-2SSM32-ELC-AL - Housing

1412856

<https://www.phoenixcontact.com/us/products/1412856>



HC-STA-B16-DC-PL - Protective cover

1421102

<https://www.phoenixcontact.com/us/products/1421102>



Protective cover, design: B16

WP-G HF IP66 M32 BK - Screw connection

3240900

<https://www.phoenixcontact.com/us/products/3240900>



Cable gland, metric thread, IP66 protection, straight

HC-STA-B16-SLWD-2SSM32-ELC-AL - Housing

1412856

<https://www.phoenixcontact.com/us/products/1412856>



WP-G HF IP69K M32 BK - Screw connection

3240886

<https://www.phoenixcontact.com/us/products/3240886>

Cable gland, metric thread, IP68/69k protection, straight



WP-GA HF IP66 M32 BK - Screw connection

3240928

<https://www.phoenixcontact.com/us/products/3240928>

Cable gland, metric thread, IP66 protection, angled



HC-STA-B16-SLWD-2SSM32-ELC-AL - Housing

1412856

<https://www.phoenixcontact.com/us/products/1412856>



WP-GA HF IP69K M32 BK - Screw connection

3240914

<https://www.phoenixcontact.com/us/products/3240914>

Cable gland, metric thread, IP68/69k protection, angled



WP-GR HF IP66 M32 BK - Screw connection

3240956

<https://www.phoenixcontact.com/us/products/3240956>

Cable gland, metric thread, IP66 protection, with strain relief



HC-STA-B16-SLWD-2SSM32-ELC-AL - Housing

1412856

<https://www.phoenixcontact.com/us/products/1412856>



WP-GR HF IP69K M32 BK - Screw connection

3240942

<https://www.phoenixcontact.com/us/products/3240942>



Cable gland, metric thread, IP68/69k protection, with strain relief

WP-G PP HF M32 - Screw connection

3241000

<https://www.phoenixcontact.com/us/products/3241000>



Cable gland made from PP with metric thread, IP65 protection

HC-STA-B16-SLWD-2SSM32-ELC-AL - Housing



1412856

<https://www.phoenixcontact.com/us/products/1412856>

WP-GT PP HF M32 - Screw connection

3241014

<https://www.phoenixcontact.com/us/products/3241014>



Cable gland made from PP with metric thread, rotatable, IP54 protection

WP-G BRASS IP40 M32 - Screw connection

3241049

<https://www.phoenixcontact.com/us/products/3241049>



Cable gland made from brass with metric thread, IP40 protection

HC-STA-B16-SLWD-2SSM32-ELC-AL - Housing



1412856

<https://www.phoenixcontact.com/us/products/1412856>

WP-GT BRASS M32 - Screw connection

3241035

<https://www.phoenixcontact.com/us/products/3241035>

Cable gland made from brass with metric thread, rotatable, IP40 protection



WP-G BRASS IP65 M32 - Screw connection

3241063

<https://www.phoenixcontact.com/us/products/3241063>

Cable gland made from brass with metric thread, IP65 protection



Phoenix Contact 2024 © - all rights reserved
<https://www.phoenixcontact.com>

Phoenix Contact USA
586 Fulling Mill Road
Middletown, PA 17057, United States
(+717) 944-1300
info@phoenixcon.com