

HC-ADV-B24-1TM32-1SM25-EMC-PS - Housing



1423228

<https://www.phoenixcontact.com/us/products/1423228>

Please be informed that the data shown in this PDF document is generated from our online catalog. Please find the complete data in the user documentation. Our general terms of use for downloads are valid.



Sleeve housing B24, Screw locking mechanism, material: Die-cast aluminum, salt water resistant, cable outlets: 2, straight, lateral, 1x M32 / 1x M25, height: 93.7 mm, cable gland: none, Offshore/EMC

Commercial data

Item number	1423228
Packing unit	1 pc
Note	Made to order (non-returnable)
Sales key	BF58
Product key	BF7APH
GTIN	4055626327907
Weight per piece (including packing)	375 g
Weight per piece (excluding packing)	375 g
Customs tariff number	85389099
Country of origin	PL

HC-ADV-B24-1TM32-1SM25-EMC-PS - Housing



1423228

<https://www.phoenixcontact.com/us/products/1423228>

Technical data

Notes

General	for contact inserts HC-B24, BB46, D64, DD108, HV10/16, M
---------	--

Product properties

Product type	Housing with screw locking
Housing type	Sleeve housing
Application	Offshore/EMC
Type	B24
No. of cable outlets	2
Type of the screw connection	1x M32 / 1x M25
Fixing screws	M6 (screw head: Pozidrive)
Shielded	yes
Cable outlet	straight, lateral
Pg screw connection	none

Connection data

Tightening torque	3 Nm ... 5 Nm (for M6 mounting screws on the sleeve housing)
-------------------	--

Dimensions

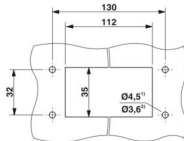
Dimensional drawing	
Width	57 mm
Height	93.7 mm
Length	152 mm

Installation dimensions

Width of the assembly cutout	35 mm
Length of the assembly cutout	112 mm

Material specifications

Seal material	NBR, conductive
Housing material	Die-cast aluminum, salt water resistant
Housing surface material	uncoated
Locking latch material	Stainless steel

Environmental and real-life conditions

Ambient conditions

Degree of protection	IP66
	IP68 (0.2 bar/24 h)

HC-ADV-B24-1TM32-1SM25-EMC-PS - Housing



1423228

<https://www.phoenixcontact.com/us/products/1423228>

Enclosure rating (NEMA)	4 (NEMA 250)
	4X (NEMA 250)
	6P (NEMA 250)
	12 (NEMA 250)
Impact strength	IK09
Ambient temperature (operation)	-40 °C ... 125 °C

Mechanical properties

Mechanical data

Type of the screw connection	1x M32 / 1x M25
------------------------------	-----------------

Mounting

Assembly note	M6 locking screw, with Pozidrive head
	To ensure optimum shielding, any insulating power coating must be removed from the profile gasket area on the control cabinet panel. Tightening torque of locking screw: 3 Nm.
Fixing screws	M6 (screw head: Pozidrive)

Drawings

Dimensional drawing

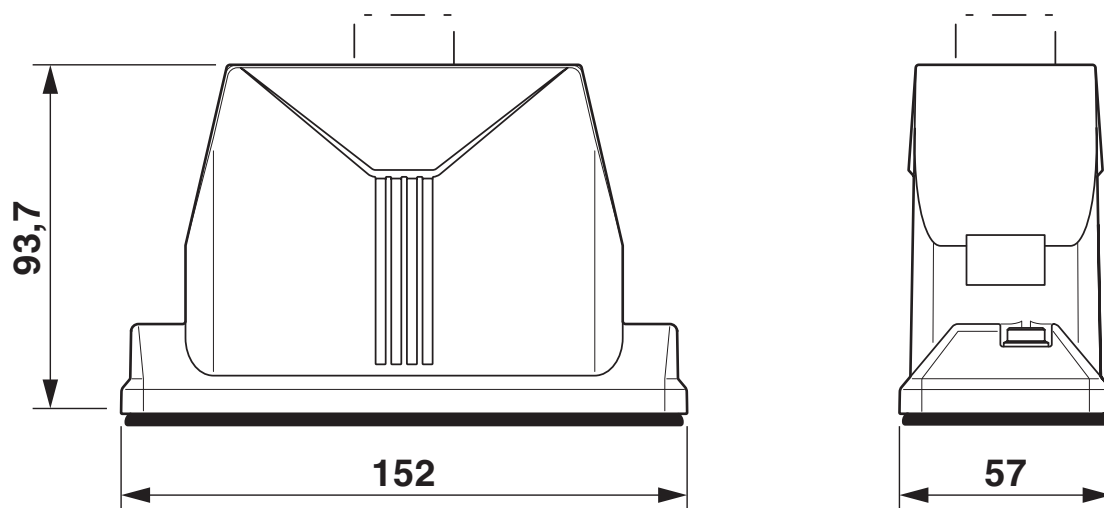

Dimensional drawing

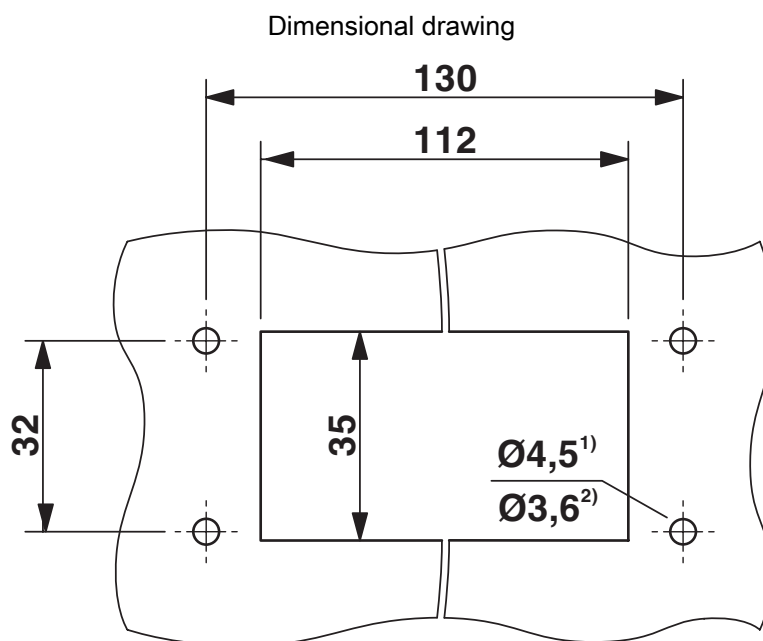

Mounting cutout

1) when M4 screws are used

2) when self-tapping Torx® screws are used (Torx® 20, M4)

HC-ADV-B24-1TM32-1SM25-EMC-PS - Housing



1423228

<https://www.phoenixcontact.com/us/products/1423228>

Classifications

ECLASS

ECLASS-11.0	27440202
ECLASS-13.0	27440202

ETIM

ETIM 8.0	EC000437
----------	----------

UNSPSC

UNSPSC 21.0	31261500
-------------	----------

Environmental product compliance

EU RoHS	
Fulfills EU RoHS substance requirements	Yes, No exemptions
China RoHS	
Environment friendly use period (EFUP)	EFUP-E
	No hazardous substances above the limits
EU REACH SVHC	
REACH candidate substance (CAS No.)	No substance above 0.1 wt%

HC-ADV-B24-1TM32-1SM25-EMC-PS - Housing



1423228

<https://www.phoenixcontact.com/us/products/1423228>

Accessories

HC-B-AF - Panel-mount flange

1686533

<https://www.phoenixcontact.com/us/products/1686533>



Panel-mount flange for HEAVYCON ADVANCE housing

HC-B-AF-SET - Panel-mount flange

1604638

<https://www.phoenixcontact.com/us/products/1604638>

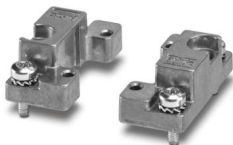

Panel-mount flange for HEAVYCON ADVANCE housing, set consisting of:
2 panel-mount flanges with 4 self-tapping screws (M4, Torx®) and 4 fan-type washers

HC-ADV-B24-1TM32-1SM25-EMC-PS - Housing



1423228

<https://www.phoenixcontact.com/us/products/1423228>

HC-B 24-TMS-SD-IP50 - Protective cover

1690765

<https://www.phoenixcontact.com/us/products/1690765>



Protective cover B24, with clip locking, protective cover material: PA, height: 31.2 mm, seal: no, with lanyard

HC-B 24-TMS-SD-IP66 - Protective cover

1411520

<https://www.phoenixcontact.com/us/products/1411520>



HEAVYCON ADVANCE, IP66, B24 protective cover for panel mounting side, with screw locking, with retaining cord, diameter of retaining cord eyelet: 3 mm

HC-ADV-B24-1TM32-1SM25-EMC-PS - Housing

1423228

<https://www.phoenixcontact.com/us/products/1423228>



G-INS-M25-M68N-NNES-S - Cable gland

1411165

<https://www.phoenixcontact.com/us/products/1411165>



Cable gland, material for screw connection: Brass, nickel-plated, application: Standard, external cable diameter 11 mm ... 17 mm, shielding: no, connecting thread: M25 x 1.5, color: silver, with O-ring

G-INSEC-M25-S68N-NCRS-S - Cable gland

1411190

<https://www.phoenixcontact.com/us/products/1411190>



Cable gland, material for screw connection: Brass, nickel-plated, application: EMC, external cable diameter 11 mm ... 16 mm, shielding: yes, connecting thread: M25 x 1.5, color: silver, with O-ring

HC-ADV-B24-1TM32-1SM25-EMC-PS - Housing



1423228

<https://www.phoenixcontact.com/us/products/1423228>

G-INS-M32-M68N-NNES-S - Cable gland

1411166

<https://www.phoenixcontact.com/us/products/1411166>



Cable gland, material for screw connection: Brass, nickel-plated, application: Standard, external cable diameter 15 mm ... 21 mm, shielding: no, connecting thread: M32 x 1.5, color: silver, with O-ring

G-INSEC-M32-M68N-NCRS-S - Cable gland

1411191

<https://www.phoenixcontact.com/us/products/1411191>



Cable gland, material for screw connection: Brass, nickel-plated, application: EMC, external cable diameter 14 mm ... 21 mm, shielding: yes, connecting thread: M32 x 1.5, color: silver, with O-ring

HC-ADV-B24-1TM32-1SM25-EMC-PS - Housing



1423228

<https://www.phoenixcontact.com/us/products/1423228>

US-EMLP (20X9) CUS - Plastic label

0830085

<https://www.phoenixcontact.com/us/products/0830085>

Plastic label, can be ordered: by card, white, labeled according to customer specifications, mounting type: adhesive, lettering field size: 20 x 9 mm, Number of individual labels: 75



HC-B-TMS-ERSSCHR - Screw

1584198

<https://www.phoenixcontact.com/us/products/1584198>

Replacement locking screw, M6, stainless steel, for HEAVYCON ADVANCE housing type HC-B...TMS...STA, head: Pozidrive



HC-ADV-B24-1TM32-1SM25-EMC-PS - Housing



1423228

<https://www.phoenixcontact.com/us/products/1423228>

SF-BIT-HEXB 5-89 - Screw insert

1208911

<https://www.phoenixcontact.com/us/products/1208911>



Screw bit, hexagonal with ball head, E6.3-1/4" drive, size: Hex 5 x 89 mm, hardened, suitable for holder according to DIN 3126-F 6.3/ISO 1173

SF-M BH - Screwdriver

1212070

<https://www.phoenixcontact.com/us/products/1212070>



Bit screwdriver, with 1/4" quick-action chuck, handle length 119 mm, 2-component handle, with non-slip grip, suitable for bits according to DIN 3126-C 6.3 and E 6.3/ISO 1173, magnetic

Phoenix Contact 2024 © - all rights reserved
<https://www.phoenixcontact.com>

Phoenix Contact USA
586 Fulling Mill Road
Middletown, PA 17057, United States
(+717) 944-1300
info@phoenixcon.com