

# HC-B 10-TFQ-N-O1STM25S - Housing



1460067

<https://www.phoenixcontact.com/us/products/1460067>

Please be informed that the data shown in this PDF document is generated from our online catalog. Please find the complete data in the user documentation. Our general terms of use for downloads are valid.



HEAVYCON B10 sleeve housing, for double locking latch, height: 56 mm, with 1 x M25 thread, lateral cable outlet

## Commercial data

Item number	1460067
Packing unit	1 pc
Note	Made to order (non-returnable)
Sales key	BF55
Product key	BF7AAC
Catalog page	Page 498 (C-4-2013)
GTIN	4046356695688
Weight per piece (including packing)	140.35 g
Weight per piece (excluding packing)	110 g
Customs tariff number	85389099
Country of origin	DE



# HC-B 10-TFQ-N-O1STM25S - Housing



1460067

<https://www.phoenixcontact.com/us/products/1460067>

## Technical data

### Notes

General	For contact inserts HC-B10, BB18, DD42, M, K8/24
---------	--

### Product properties

Product type	Housing with locking latch
Housing type	Sleeve housing
Application	Standard
Type	B10
No. of cable outlets	1
Type of the screw connection	1x M25
Shielded	no
Cable outlet	lateral
Pg screw connection	none

### Dimensions

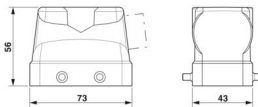
Dimensional drawing	
Width	43 mm
Height	56 mm
Length	73 mm

### Material specifications

Housing material	die-cast aluminum
Housing surface material	Powder-coated, gray

### Mechanical properties

Mechanical data	
Type of the screw connection	1x M25
Locking type	Pin

### Environmental and real-life conditions

Ambient conditions	
Degree of protection	IP65
Ambient temperature (operation)	-40 °C ... 125 °C



# HC-B 10-TFQ-N-O1STM25S - Housing

1460067

<https://www.phoenixcontact.com/us/products/1460067>



## Drawings

Dimensional drawing

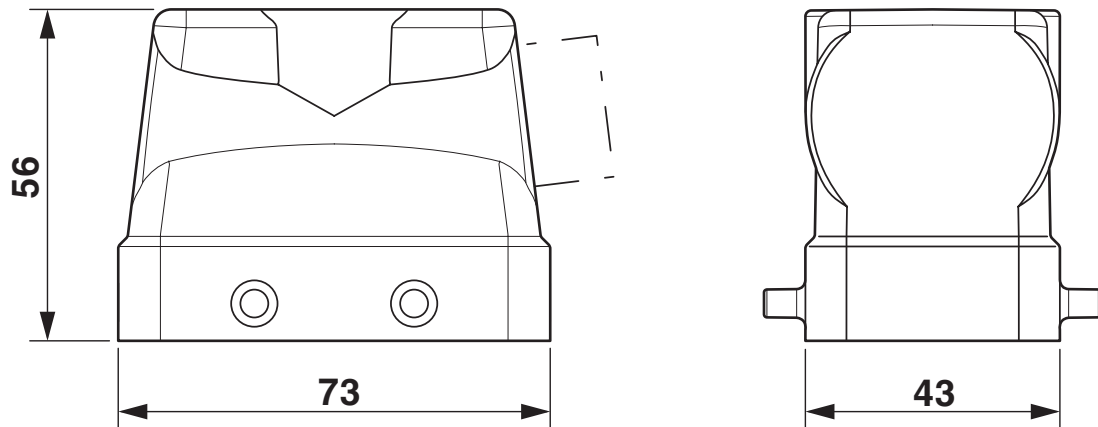

Dimensional drawing



# HC-B 10-TFQ-N-O1STM25S - Housing



1460067

<https://www.phoenixcontact.com/us/products/1460067>

## Classifications

### ECLASS

ECLASS-11.0	27440202
ECLASS-13.0	27440202

### UNSPSC

UNSPSC 21.0	31261501
-------------	----------



Environmental product compliance

China RoHS	
Environment friendly use period (EFUP)	EFUP-E
	No hazardous substances above the limits
EU REACH SVHC	
REACH candidate substance (CAS No.)	No substance above 0.1 wt%



# HC-B 10-TFQ-N-O1STM25S - Housing



1460067

<https://www.phoenixcontact.com/us/products/1460067>

## Accessories

### G-INS-M25-M68N-PNES-GY - Cable gland

1411126

<https://www.phoenixcontact.com/us/products/1411126>



Cable gland, material for screw connection: PA, application: Standard, external cable diameter 11 mm ... 17 mm, shielding: no, connecting thread: M25 x 1.5, color: silver-grey RAL 7001

---

### G-INS-M25-M68N-PNES-BK - Cable gland

1411134

<https://www.phoenixcontact.com/us/products/1411134>



Cable gland, material for screw connection: PA, application: Standard, external cable diameter 11 mm ... 17 mm, shielding: no, connecting thread: M25 x 1.5, color: jet black RAL 9005



## HC-B 10-TFQ-N-O1STM25S - Housing

1460067

<https://www.phoenixcontact.com/us/products/1460067>



## G-INS-M25-M68N-NNES-S - Cable gland

1411165

<https://www.phoenixcontact.com/us/products/1411165>



Cable gland, material for screw connection: Brass, nickel-plated, application: Standard, external cable diameter 11 mm ... 17 mm, shielding: no, connecting thread: M25 x 1.5, color: silver, with O-ring

---

## HC-M-KV-M25(14-21) - Cable gland

1646007

<https://www.phoenixcontact.com/us/products/1646007>



Metal screw connection up to 5 bar, thread length: 7 mm, cable diameter: 14 - 21 mm, WAF 34, screw connection: M25



# HC-B 10-TFQ-N-O1STM25S - Housing

1460067

<https://www.phoenixcontact.com/us/products/1460067>



## G-INSEC-M25-S68N-NCRS-S - Cable gland

1411190

<https://www.phoenixcontact.com/us/products/1411190>



Cable gland, material for screw connection: Brass, nickel-plated, application: EMC, external cable diameter 11 mm ... 16 mm, shielding: yes, connecting thread: M25 x 1.5, color: silver, with O-ring

---

## G-INESR-M25-M68N-NEPDS-S - Cable gland

1415193

<https://www.phoenixcontact.com/us/products/1415193>



Cable gland, material for screw connection: Brass, nickel-plated, application: Standard, external cable diameter 9 mm ... 17 mm, shielding: no, connecting thread: M25 x 1.5, color: silver, with external strain relief, with O-ring



## HC-B 10-TFQ-N-O1STM25S - Housing

1460067

<https://www.phoenixcontact.com/us/products/1460067>



## HC-M-KV-T-M25 - Cable gland

1646191

<https://www.phoenixcontact.com/us/products/1646191>

Metal screw connection with cable bend protection and strain relief, thread length: 7 mm, cable sealing area: 10 - 19 mm, clamping area: 14 - 21 mm, SW 30, screw connection: M25



---

## REDUC-M-KV-M25/M20 - Reducing adapter

1647624

<https://www.phoenixcontact.com/us/products/1647624>

Reducing adapter, connecting thread: M25 x 1.5, color: silver, with O-ring





## HC-B 10-TFQ-N-O1STM25S - Housing

1460067

<https://www.phoenixcontact.com/us/products/1460067>



## ENLAR-M-KV-M25/M32 - Extension adapter

1647679

<https://www.phoenixcontact.com/us/products/1647679>

Extension adapter, connecting thread: M25 x 1.5, color: silver, with O-ring



---

## HC-M-BS-M25 - Screw plug

1645859

<https://www.phoenixcontact.com/us/products/1645859>

Screw plug, material for screw connection: Brass, nickel-plated, connecting thread: M25 x 1.5, color: silver



---

Phoenix Contact 2024 © - all rights reserved  
<https://www.phoenixcontact.com>

Phoenix Contact USA  
586 Fulling Mill Road  
Middletown, PA 17057, United States  
(+717) 944-1300  
[info@phoenixcon.com](mailto:info@phoenixcon.com)