

HC-B 32-TMS-100-O1STM32G-EEE - Housing



1580516

<https://www.phoenixcontact.com/us/products/1580516>

Please be informed that the data shown in this PDF document is generated from our online catalog. Please find the complete data in the user documentation. Our general terms of use for downloads are valid.



HEAVYCON ADVANCE B32 sleeve housing, for increased environmental requirements, EMC conductive, with Allen screw locking, 1 x M32 x 1.5, with straight cable outlet

Commercial data

Item number	1580516
Packing unit	1 pc
Note	Made to order (non-returnable)
Sales key	BF58
Product key	BF7AAA
Catalog page	Page 618 (C-4-2015)
GTIN	4046356463126
Weight per piece (including packing)	686.4 g
Weight per piece (excluding packing)	686.4 g
Customs tariff number	85389099
Country of origin	DE

HC-B 32-TMS-100-O1STM32G-EEE - Housing



1580516

<https://www.phoenixcontact.com/us/products/1580516>

Technical data

Notes

General	For contact inserts HC-B16, BB32, D40, DD72, HS6, HV6, M, K
---------	---

Product properties

Product type	Housing with screw locking
Housing type	Sleeve housing
Application	Offshore/EMC
Type	B32
No. of cable outlets	1
Type of the screw connection	1x M32
Fixing screws	M6 (screw head: 5 mm Allen screw)
Shielded	yes
Cable outlet	straight
Pg screw connection	none

Connection data

Tightening torque	3 Nm (Locking screw)
-------------------	----------------------

Dimensions

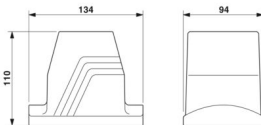
Dimensional drawing	
Width	94 mm
Height	110 mm
Length	126 mm

Installation dimensions

Width of the assembly cutout	71 mm
Length of the assembly cutout	86 mm

Material specifications

Seal material	NBR, conductive
Housing material	Die-cast aluminum, salt water resistant
Housing surface material	uncoated
Locking latch material	Stainless steel

Environmental and real-life conditions

Ambient conditions

Degree of protection	IP66
	IP68 (0.2 bar/24 h)

HC-B 32-TMS-100-O1STM32G-EEE - Housing



1580516

<https://www.phoenixcontact.com/us/products/1580516>

	IP69K
Enclosure rating (NEMA)	4 (NEMA 250)
	4X (NEMA 250)
	6P (NEMA 250)
	12 (NEMA 250)
Ambient temperature (operation)	-40 °C ... 125 °C

Mechanical properties

Mechanical data

Type of the screw connection	1x M32
Locking type	Screw

Mounting

Assembly note	In order to guarantee that the protective conductor contact functions even when plugged in at an angle, the two panel-mount flanges must have sufficient electrical contact with the metal mounting panel.
	To ensure optimum shielding, any insulating power coating must be removed from the profile gasket area on the control cabinet panel. Tightening torque of locking screw: 3 Nm.
Fixing screws	M6 (screw head: 5 mm Allen screw)

Drawings

Dimensional drawing

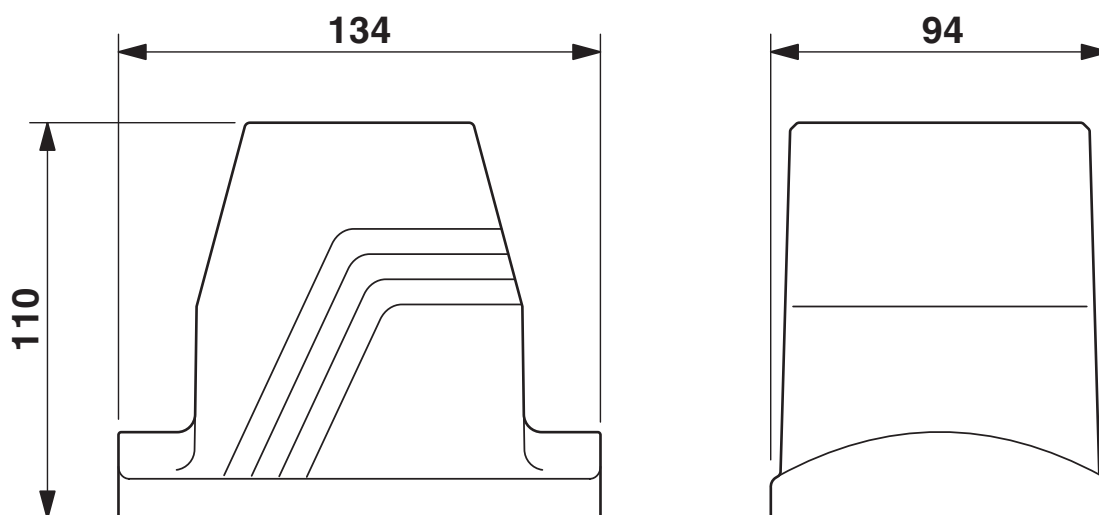

Dimensional drawing

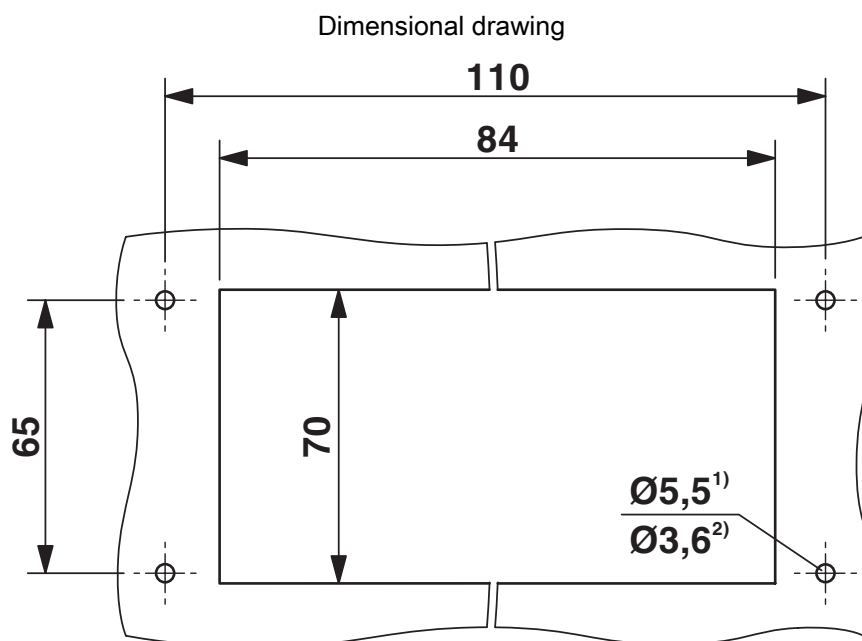

Mounting cutout

- 1) Standard M5 screw
- 2) Self-tapping (Torx® 20, M4)

HC-B 32-TMS-100-O1STM32G-EEE - Housing

1580516

<https://www.phoenixcontact.com/us/products/1580516>



Classifications

ECLASS

ECLASS-11.0	27440202
ECLASS-13.0	27440202

HC-B 32-TMS-100-O1STM32G-EEE - Housing



1580516

<https://www.phoenixcontact.com/us/products/1580516>

Environmental product compliance

EU REACH SVHC

REACH candidate substance (CAS No.)	No substance above 0.1 wt%
-------------------------------------	----------------------------

HC-B 32-TMS-100-O1STM32G-EEE - Housing



1580516

<https://www.phoenixcontact.com/us/products/1580516>

Accessories

HC-B 32/48-AF - Panel-mount flange

1580524

<https://www.phoenixcontact.com/us/products/1580524>



HEAVYCON-ADVANCE mounting flange for screw locking HC B 32/48

HC-B 32-TMS-SD-IP65 - Protective cover

1580539

<https://www.phoenixcontact.com/us/products/1580539>



HEAVYCON ADVANCE B32 IP65 protective cover, for panel mounting side, screw locking with 2 Allen screws, with seal, 3 mm retaining cord eyelet

HC-B 32-TMS-100-O1STM32G-EEE - Housing

1580516

<https://www.phoenixcontact.com/us/products/1580516>



G-INS-M32-M68N-PNES-GY - Cable gland

1411127

<https://www.phoenixcontact.com/us/products/1411127>



Cable gland, material for screw connection: PA, application: Standard, external cable diameter 15 mm ... 21 mm, shielding: no, connecting thread: M32 x 1.5, color: silver-grey RAL 7001

G-INS-M32-M68N-PNES-BK - Cable gland

1411136

<https://www.phoenixcontact.com/us/products/1411136>



Cable gland, material for screw connection: PA, application: Standard, external cable diameter 15 mm ... 21 mm, shielding: no, connecting thread: M32 x 1.5, color: jet black RAL 9005

HC-B 32-TMS-100-O1STM32G-EEE - Housing

1580516

<https://www.phoenixcontact.com/us/products/1580516>



G-INS-M32-M68N-NNES-S - Cable gland

1411166

<https://www.phoenixcontact.com/us/products/1411166>



Cable gland, material for screw connection: Brass, nickel-plated, application: Standard, external cable diameter 15 mm ... 21 mm, shielding: no, connecting thread: M32 x 1.5, color: silver, with O-ring

HC-M-KV-M32(19-27) - Cable gland

1646010

<https://www.phoenixcontact.com/us/products/1646010>



Metal screw connection up to 5 bar, thread length: 8 mm, cable diameter: 19 - 27 mm, WAF 43, screw connection: M32

HC-B 32-TMS-100-O1STM32G-EEE - Housing

1580516

<https://www.phoenixcontact.com/us/products/1580516>



G-INSEC-M32-M68N-NCRS-S - Cable gland

1411191

<https://www.phoenixcontact.com/us/products/1411191>



Cable gland, material for screw connection: Brass, nickel-plated, application: EMC, external cable diameter 14 mm ... 21 mm, shielding: yes, connecting thread: M32 x 1.5, color: silver, with O-ring

HC-M-KV-Z-M32 - Cable gland

1646162

<https://www.phoenixcontact.com/us/products/1646162>



Metal screw connection with strain relief clamp, thread length: 8 mm, cable sealing area: 18 - 27 mm, clamping area: 19 - 30 mm, SW 40, screw connection: M32

HC-B 32-TMS-100-O1STM32G-EEE - Housing

1580516

<https://www.phoenixcontact.com/us/products/1580516>



HC-M-KV-T-M32 - Cable gland

1646201

<https://www.phoenixcontact.com/us/products/1646201>

Metal screw connection with cable bend protection and strain relief, thread length: 8 mm, cable sealing area: 18 - 27 mm, clamping area: 20 - 30 mm, SW 40, screw connection: M32



REDUC-M-KV-M32/M25 - Reducing adapter

1647637

<https://www.phoenixcontact.com/us/products/1647637>

Reducing adapter, connecting thread: M32 x 1.5, color: silver, with O-ring



HC-B 32-TMS-100-O1STM32G-EEE - Housing

1580516

<https://www.phoenixcontact.com/us/products/1580516>



ENLAR-M-KV-M32/M40 - Extension adapter

1647682

<https://www.phoenixcontact.com/us/products/1647682>

Extension adapter, connecting thread: M32 x 1.5, color: silver, with O-ring



HC-M-BS-M32 - Screw plug

1645862

<https://www.phoenixcontact.com/us/products/1645862>

Screw plug, material for screw connection: Brass, nickel-plated, connecting thread: M32 x 1.5, color: silver



HC-B 32-TMS-100-O1STM32G-EEE - Housing

1580516

<https://www.phoenixcontact.com/us/products/1580516>



HC-B 32-TMS-EEE-PR-DI - Profile gasket

1409833

<https://www.phoenixcontact.com/us/products/1409833>

Profile gasket for sleeve housing type B32.....EEE



SF-BIT-HEXB 5-89 - Screw insert

1208911

<https://www.phoenixcontact.com/us/products/1208911>

Screw bit, hexagonal with ball head, E6.3-1/4" drive, size: Hex 5 x 89 mm, hardened, suitable for holder according to DIN 3126-F 6.3/ISO 1173



HC-B 32-TMS-100-O1STM32G-EEE - Housing

1580516

<https://www.phoenixcontact.com/us/products/1580516>



SF-M BH - Screwdriver

1212070

<https://www.phoenixcontact.com/us/products/1212070>



Bit screwdriver, with 1/4" quick-action chuck, handle length 119 mm, 2-component handle, with non-slip grip, suitable for bits according to DIN 3126-C 6.3 and E 6.3/ISO 1173, magnetic

Phoenix Contact 2024 © - all rights reserved

<https://www.phoenixcontact.com>

Phoenix Contact USA
586 Fulling Mill Road
Middletown, PA 17057, United States
(+717) 944-1300
info@phoenixcon.com