

HC-B 32-TMS-100-O1STM50S-EEE - Housing



1580521

<https://www.phoenixcontact.com/sg/products/1580521>

Please be informed that the data shown in this PDF document is generated from our online catalog. Please find the complete data in the user documentation. Our general terms of use for downloads are valid.



HEAVYCON-ADVANCE sleeve housing B 32, for increased environmental requirements, EMC-conductive, with Allen wrench screw locking, with 1x M50x1.5 lateral cable outlet

Commercial data

Item number	1580521
Packing unit	6 pc
Minimum order quantity	1 pc
Note	Made to order (non-returnable)
Sales key	*****
Product key	BF7AAA
Catalog page	Page 618 (C-4-2015)
GTIN	4046356463171
Weight per piece (including packing)	628 g
Weight per piece (excluding packing)	620 g
Customs tariff number	85389099
Country of origin	DE

HC-B 32-TMS-100-O1STM50S-EEE - Housing



1580521

<https://www.phoenixcontact.com/sg/products/1580521>

Technical data

Notes

General	For contact inserts HC-B16, BB32, D40, DD72, HS6, HV6, M, K
---------	---

Product properties

Product type	Housing with screw locking
Housing type	Sleeve housing
Application	Offshore/EMC
Type	B32
No. of cable outlets	1
Type of the screw connection	1x M50
Fixing screws	M6 (screw head: 5 mm Allen screw)
Shielded	yes
Cable outlet	lateral
Pg screw connection	none

Connection data

Tightening torque	3 Nm (Locking screw)
-------------------	----------------------

Dimensions

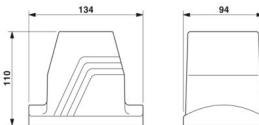
Dimensional drawing	
Width	94 mm
Height	110 mm
Length	126 mm

Installation dimensions

Width of the assembly cutout	71 mm
Length of the assembly cutout	86 mm

Material specifications

Seal material	NBR, conductive
Housing material	Die-cast aluminum, salt water resistant
Housing surface material	uncoated
Locking latch material	Stainless steel

Environmental and real-life conditions

Ambient conditions

Degree of protection	IP66
	IP68 (0.2 bar/24 h)

HC-B 32-TMS-100-O1STM50S-EEE - Housing



1580521

<https://www.phoenixcontact.com/sg/products/1580521>

	IP69K
Enclosure rating (NEMA)	4 (NEMA 250)
	4X (NEMA 250)
	6P (NEMA 250)
	12 (NEMA 250)
Ambient temperature (operation)	-40 °C ... 125 °C

Mechanical properties

Mechanical data

Type of the screw connection	1x M50
Locking type	Screw

Mounting

Assembly note	In order to guarantee that the protective conductor contact functions even when plugged in at an angle, the two panel-mount flanges must have sufficient electrical contact with the metal mounting panel.
	To ensure optimum shielding, any insulating power coating must be removed from the profile gasket area on the control cabinet panel. Tightening torque of locking screw: 3 Nm.
Fixing screws	M6 (screw head: 5 mm Allen screw)

Drawings

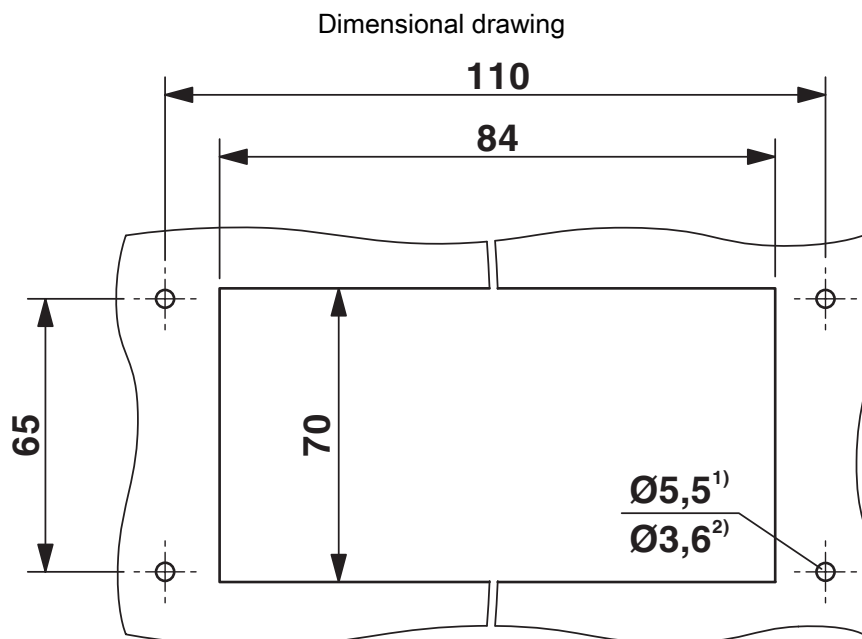

Mounting cutout

1) Standard M5 screw

2) Self-tapping (Torx® 20, M4)

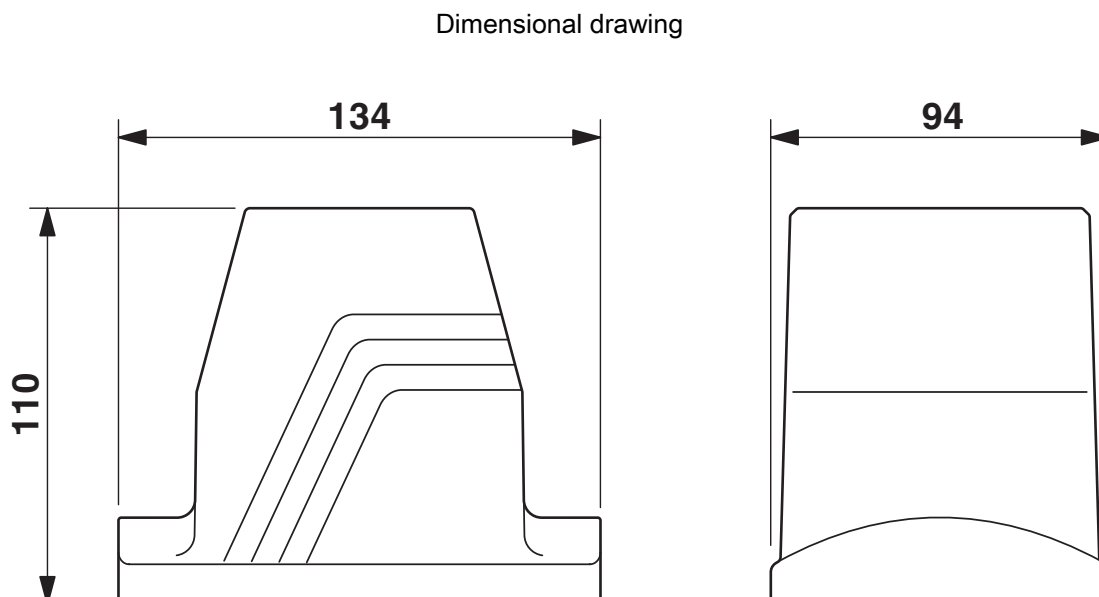

Dimensional drawing

HC-B 32-TMS-100-O1STM50S-EEE - Housing

1580521

<https://www.phoenixcontact.com/sg/products/1580521>



Classifications

ECLASS

ECLASS-11.0	27440202
ECLASS-13.0	27440202

HC-B 32-TMS-100-O1STM50S-EEE - Housing



1580521

<https://www.phoenixcontact.com/sg/products/1580521>

Environmental product compliance

EU REACH SVHC

REACH candidate substance (CAS No.)	No substance above 0.1 wt%
-------------------------------------	----------------------------

Phoenix Contact 2024 © - all rights reserved
<https://www.phoenixcontact.com>

PHOENIX CONTACT SEA Pte. Ltd.
105 Eunos Avenue 3, #04-00
Singapore 409836
+65 6228 4900
marketing@phoenixcontact.com.sg