

1603731

<https://www.phoenixcontact.com/gb/products/1603731>

Please be informed that the data shown in this PDF document is generated from our online catalog. Please find the complete data in the user documentation. Our general terms of use for downloads are valid.



M23, Device connector rear mounting, series: RC, straight, shielded: yes, Screw locking mechanism, No. of pos.: 6+3, Direction of rotation: Standard, contact connection type: Socket, Solder cup, Axial O-ring, Central fastening M25 x 1.5, Panel thickness min.: 0.8 mm, Panel thickness max.: 6.5 mm, coding: N

Commercial data

| | |
|--------------------------------------|--------------------------------|
| Item number | 1603731 |
| Packing unit | 20 pc |
| Minimum order quantity | 1 pc |
| Note | Made to order (non-returnable) |
| Product key | ABRAFR |
| GTIN | 4046356246835 |
| Weight per piece (including packing) | 57.05 g |
| Weight per piece (excluding packing) | 57.05 g |
| Country of origin | DE |

RC-63S1N12H000 - Device connector rear mounting



1603731

<https://www.phoenixcontact.com/gb/products/1603731>

Technical data

Product properties

| | |
|--------------|-----------------------------------|
| Product type | Circular connectors (device side) |
|--------------|-----------------------------------|

Connector

Insulating body

| | |
|---|----------------------|
| Coding | N |
| Insertion/withdrawal cycles | 50 |
| Connection method | Solder cup |
| Contact switching type | Socket |
| Application | Signal |
| Number of positions | 9 |
| Direction of rotation | Standard |
| Connection profile | 6+3 |
| Contact diameter Power contacts | 2 mm |
| Litz wire cross-section Power contacts min. | 0.08 mm ² |
| Litz wire cross-section Power contacts max. | 2.5 mm ² |
| Rated current Power contacts | 20 A |
| Rated voltage | 48 V AC |
| | 74 V DC |
| Rated surge voltage | 1.5 kV |
| Overvoltage category | III |
| Degree of pollution | 3 |
| Contact diameter Signal contacts | 1 mm |
| Litz wire cross-section Signal contacts min. | 0.08 mm ² |
| Litz wire cross-section Signal contacts max. | 1 mm ² |
| Nominal current per signal contact | 8 A |

Housing

| | |
|-----------------------------------|-------------------------|
| Housing material | Metal |
| Type of locking | Screw locking mechanism |
| Pg screw connection | none |
| Degree of protection (plugged in) | IP67 |
| Thread type | M23 |

Drawings

Schematic diagram

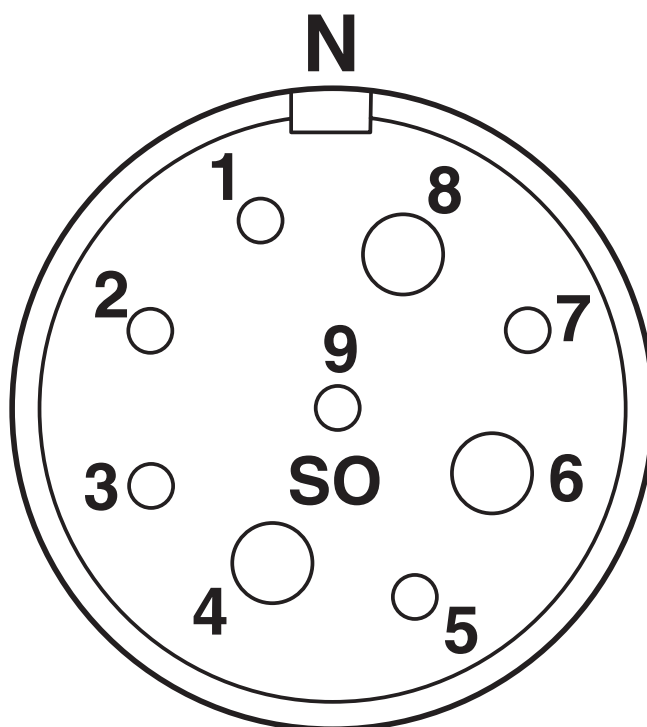

Connector pin assignment

RC-63S1N12H000 - Device connector rear mounting



1603731

<https://www.phoenixcontact.com/gb/products/1603731>

Dimensional drawing

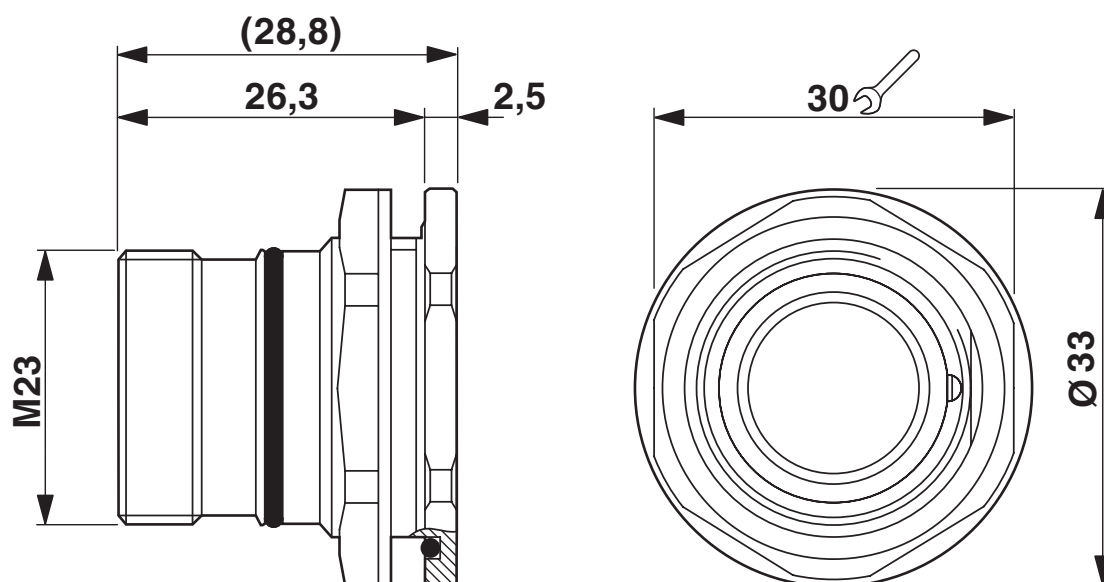

Dimensional drawing

Dimensional drawing

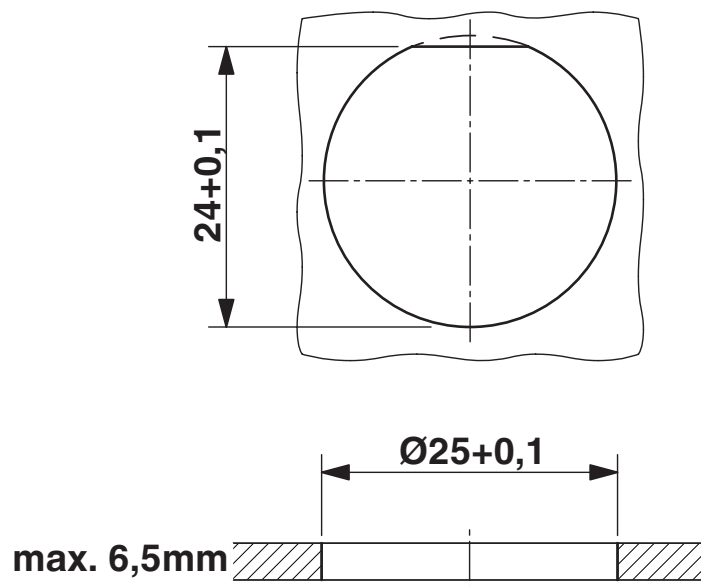

Installation dimensions

Environmental product compliance

| | |
|--|---|
| China RoHS | |
| Environment friendly use period (EFUP) | <div>EFUP-50</div> <div>An article-related China RoHS declaration table can be found in the download area for the respective article under "Manufacturer declaration". For all articles with EFUP-E, no China RoHS declaration table issued and required.</div> |
| EU REACH SVHC | |
| REACH candidate substance (CAS No.) | No substance above 0.1 wt% |