

# HC-B 6-SML-52/O2M20 - Housing

1604723

<https://www.phoenixcontact.com/us/products/1604723>



Please be informed that the data shown in this PDF document is generated from our online catalog. Please find the complete data in the user documentation. Our general terms of use for downloads are valid.



HEAVYCON box mounting base B6, with single locking latch. Height 52 mm, with supports 2xM20

## Commercial data

Item number	1604723
Packing unit	1 pc
Note	Made to order (non-returnable)
Sales key	BF55
Product key	BF7AAC
Catalog page	Page 488 (C-4-2013)
GTIN	4017918881641
Weight per piece (including packing)	210.09 g
Weight per piece (excluding packing)	205.55 g
Customs tariff number	85389099
Country of origin	DE

# HC-B 6-SML-52/O2M20 - Housing

1604723

<https://www.phoenixcontact.com/us/products/1604723>



## Technical data

### Notes

General	For contact inserts HC-B6, BB10, DD24, M
---------	--

### Product properties

Product type	Housing with locking latch
Housing type	Box mounting bases
Application	Standard
Type	B6
No. of cable outlets	2
Type of the screw connection	2x M20
Shielded	no
Cable outlet	lateral
Pg screw connection	none

### Dimensions

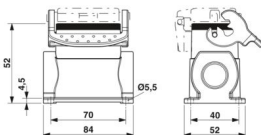
Dimensional drawing	
Width	52 mm
Height	52 mm
Length	84 mm

### Material specifications

Seal material	NBR
Housing material	die-cast aluminum
Housing surface material	Powder-coated, gray
Locking latch material	Stainless steel, handle: PA

### Mechanical properties

#### Mechanical data

Type of the screw connection	2x M20
Locking type	Latch

### Environmental and real-life conditions

#### Ambient conditions

Degree of protection	IP65
Ambient temperature (operation)	-40 °C ... 125 °C

# HC-B 6-SML-52/O2M20 - Housing

1604723

<https://www.phoenixcontact.com/us/products/1604723>



## Drawings

Dimensional drawing

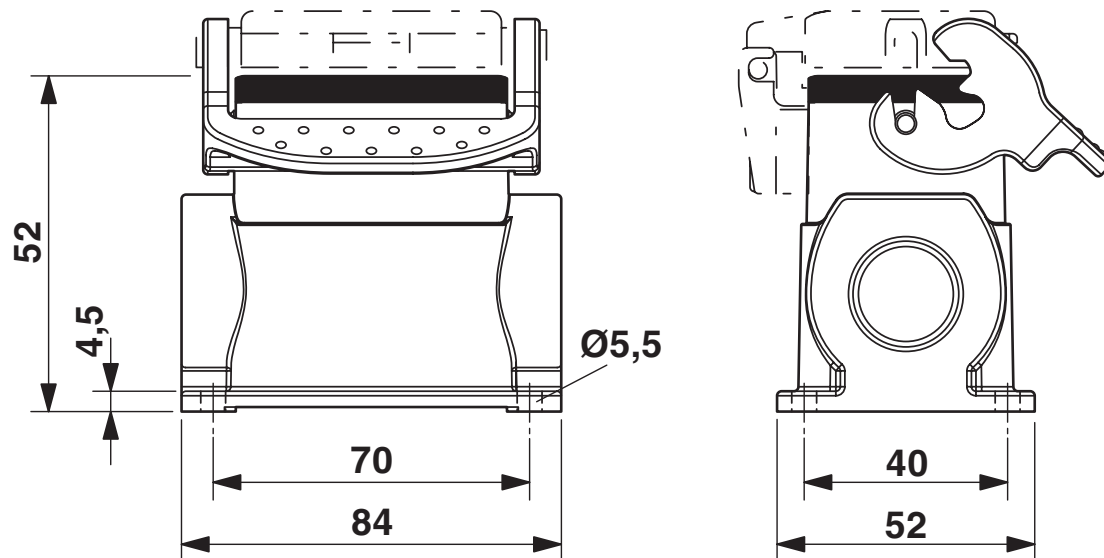

Dimensional drawing

# HC-B 6-SML-52/O2M20 - Housing

1604723

<https://www.phoenixcontact.com/us/products/1604723>



Schematic diagram

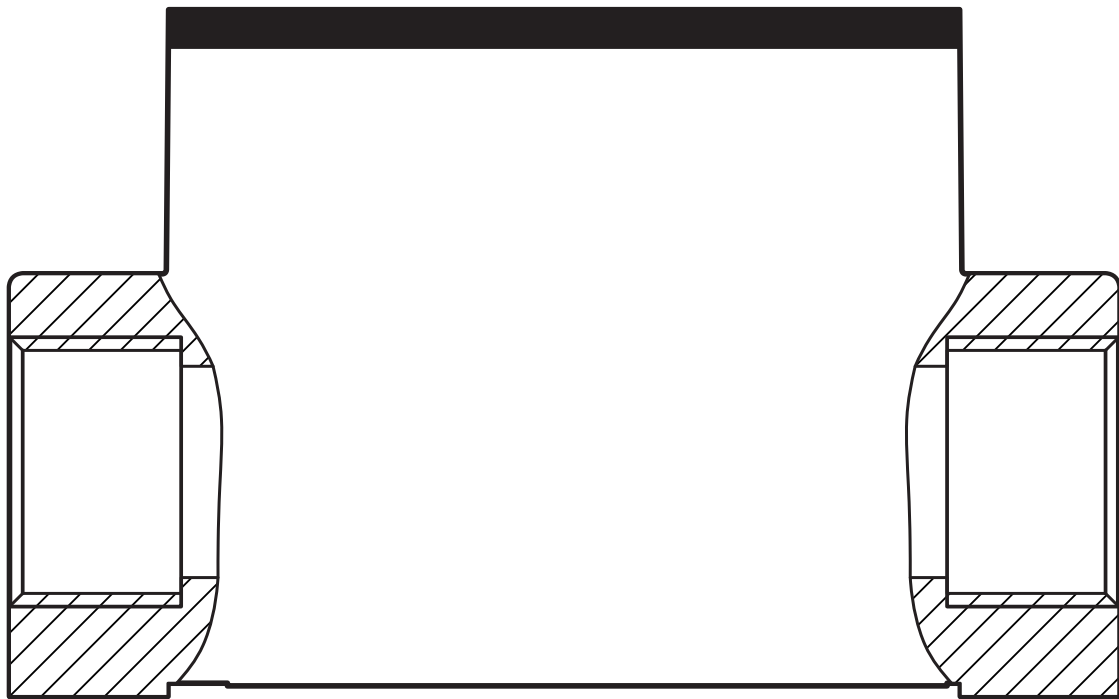

# HC-B 6-SML-52/O2M20 - Housing



1604723

<https://www.phoenixcontact.com/us/products/1604723>

## Classifications

### ECLASS

ECLASS-11.0	27440202
ECLASS-13.0	27440202

### UNSPSC

UNSPSC 21.0	31261501
-------------	----------

Environmental product compliance

China RoHS

Environment friendly use period (EFUP)	EFUP-E
	No hazardous substances above the limits

EU REACH SVHC

REACH candidate substance (CAS No.)	No substance above 0.1 wt%
-------------------------------------	----------------------------

# HC-B 6-SML-52/O2M20 - Housing

1604723

<https://www.phoenixcontact.com/us/products/1604723>



## Accessories

### G-INS-M20-S68N-PNES-GY - Cable gland

1411125

<https://www.phoenixcontact.com/us/products/1411125>



Cable gland, material for screw connection: PA, application: Standard, external cable diameter 6 mm ... 12 mm, shielding: no, connecting thread: M20 x 1.5, color: silver-grey RAL 7001

---

### G-INS-M20-S68N-PNES-BK - Cable gland

1411133

<https://www.phoenixcontact.com/us/products/1411133>



Cable gland, material for screw connection: PA, application: Standard, external cable diameter 6 mm ... 12 mm, shielding: no, connecting thread: M20 x 1.5, color: jet black RAL 9005

## HC-B 6-SML-52/O2M20 - Housing

1604723

<https://www.phoenixcontact.com/us/products/1604723>



## G-INS-M20-S68N-NNES-S - Cable gland

1411163

<https://www.phoenixcontact.com/us/products/1411163>



Cable gland, material for screw connection: Brass, nickel-plated, application: Standard, external cable diameter 6 mm ... 12 mm, shielding: no, connecting thread: M20 x 1.5, color: silver, with O-ring

---

## HC-M-KV-M20(11-16) - Cable gland

1645998

<https://www.phoenixcontact.com/us/products/1645998>



Metal screw connection up to 5 bar, thread length: 6 mm, cable diameter: 11 - 16 mm, WAF 27, screw connection: M20



## HC-B 6-SML-52/O2M20 - Housing

1604723

<https://www.phoenixcontact.com/us/products/1604723>



### G-INSEC-M20-S68N-NCRS-S - Cable gland

1411189

<https://www.phoenixcontact.com/us/products/1411189>



Cable gland, material for screw connection: Brass, nickel-plated, application: EMC, external cable diameter 9 mm ... 13 mm, shielding: yes, connecting thread: M20 x 1.5, color: silver, with O-ring

---

### G-INESR-M20-S68N-NEPDS-S - Cable gland

1415192

<https://www.phoenixcontact.com/us/products/1415192>



Cable gland, material for screw connection: Brass, nickel-plated, application: Standard, external cable diameter 6 mm ... 13 mm, shielding: no, connecting thread: M20 x 1.5, color: silver, with external strain relief, with O-ring

## HC-B 6-SML-52/O2M20 - Housing

1604723

<https://www.phoenixcontact.com/us/products/1604723>



## HC-M-KV-T-M20 - Cable gland

1646188

<https://www.phoenixcontact.com/us/products/1646188>

Metal screw connection with cable bend protection and strain relief, thread length: 6 mm, cable sealing area: 7.5 - 15 mm, clamping area: 10 - 16 mm, SW 24, screw connection: M20



---

## REDUC-M-KV-M20/M16 - Reducing adapter

1647611

<https://www.phoenixcontact.com/us/products/1647611>

Reducing adapter, connecting thread: M20 x 1.5, color: silver, with O-ring



## HC-B 6-SML-52/O2M20 - Housing

1604723

<https://www.phoenixcontact.com/us/products/1604723>



## ENLAR-M-KV-M20/M25 - Extension adapter

1647666

<https://www.phoenixcontact.com/us/products/1647666>

Extension adapter, connecting thread: M20 x 1.5, color: silver, with O-ring



---

## HC-M-BS-M20 - Screw plug

1645846

<https://www.phoenixcontact.com/us/products/1645846>

Screw plug, material for screw connection: Brass, nickel-plated, connecting thread: M20 x 1.5, color: silver



---

Phoenix Contact 2024 © - all rights reserved  
<https://www.phoenixcontact.com>

Phoenix Contact USA  
586 Fulling Mill Road  
Middletown, PA 17057, United States  
(+717) 944-1300  
[info@phoenixcon.com](mailto:info@phoenixcon.com)