

HC-B 6-AMLD-AL - Housing

1645464

<https://www.phoenixcontact.com/us/products/1645464>



Please be informed that the data shown in this PDF document is generated from our online catalog. Please find the complete data in the user documentation. Our general terms of use for downloads are valid.



Panel mounting base B6, with single locking latch, material: die-cast aluminum, protective cover material: Al, height: 29 mm, cable gland: none, protective cover: yes, Standard, with flat gasket

Commercial data

Item number	1645464
Packing unit	1 pc
Note	Made to order (non-returnable)
Sales key	BF55
Product key	BF7AAC
Catalog page	Page 488 (C-4-2013)
GTIN	4046356028615
Weight per piece (including packing)	151.8 g
Weight per piece (excluding packing)	151.8 g
Customs tariff number	85389099
Country of origin	DE

HC-B 6-AMLD-AL - Housing

1645464

<https://www.phoenixcontact.com/us/products/1645464>



Technical data

Notes

General	For contact inserts HC-B6, BB10, DD24, M
---------	--

Product properties

Product type	Housing with locking latch
Housing type	Panel mounting base
Application	Standard
Type	B6
Protective cover	yes
Shielded	no
Pg screw connection	none

Dimensions

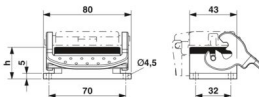
Dimensional drawing	
Width	43 mm
Height	29 mm
Length	80 mm

Installation dimensions

Width of the assembly cutout	35 mm
Length of the assembly cutout	52 mm

Material specifications

Seal material	NBR
	CR
Housing material	die-cast aluminum
Housing surface material	Powder-coated, gray
Material, protective cover	Al
Locking latch material	Stainless steel, handle: PA

Mechanical properties

Mechanical data

Locking type	Latch
--------------	-------

Connection data

Tightening torque	1.5 Nm ... 2 Nm (Mounting screw)
-------------------	----------------------------------

Environmental and real-life conditions

HC-B 6-AMLD-AL - Housing



1645464

<https://www.phoenixcontact.com/us/products/1645464>

Ambient conditions

Degree of protection	IP65 (When plugged in)
	IP54 (with closed protective cover)
Ambient temperature (operation)	-40 °C ... 125 °C

HC-B 6-AMLD-AL - Housing

1645464

<https://www.phoenixcontact.com/us/products/1645464>



Drawings

Dimensional drawing

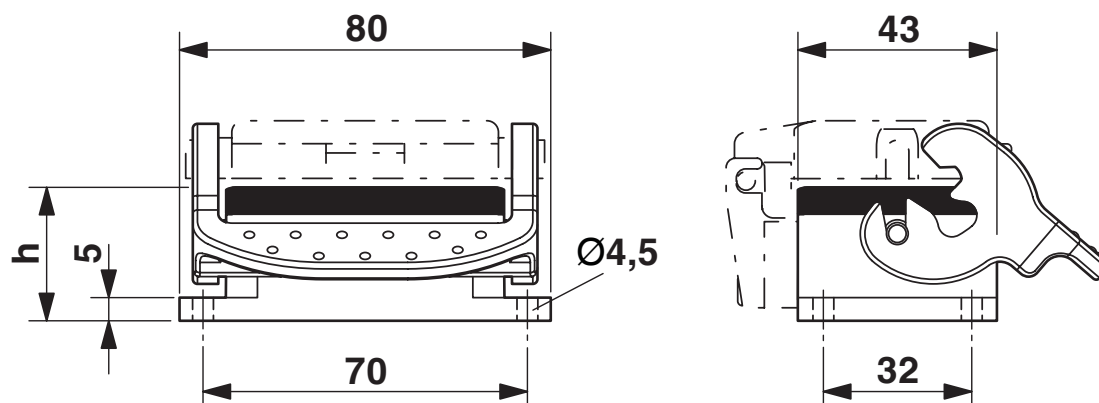

Dimensional drawing

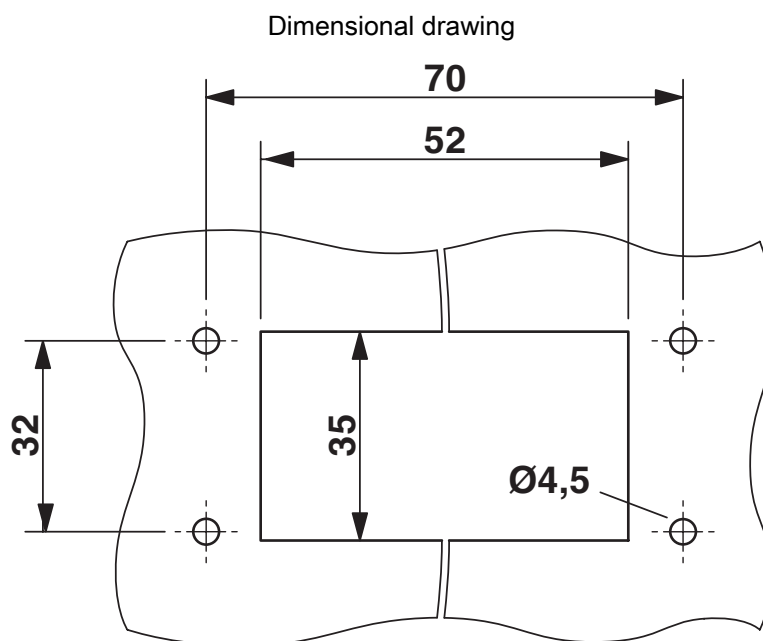

Mounting cutout

HC-B 6-AMLD-AL - Housing



1645464

<https://www.phoenixcontact.com/us/products/1645464>

Classifications

ECLASS

ECLASS-11.0	27440202
ECLASS-13.0	27440202

ETIM

ETIM 8.0	EC000437
----------	----------

UNSPSC

UNSPSC 21.0	31261500
-------------	----------

Environmental product compliance

EU RoHS	
Fulfills EU RoHS substance requirements	Yes, No exemptions
China RoHS	
Environment friendly use period (EFUP)	EFUP-E
	No hazardous substances above the limits
EU REACH SVHC	
REACH candidate substance (CAS No.)	No substance above 0.1 wt%

HC-B 6-AMLD-AL - Housing

1645464

<https://www.phoenixcontact.com/us/products/1645464>



Accessories

HC-B 6-PR-DI - Profile gasket

1663022

<https://www.phoenixcontact.com/us/products/1663022>

Profile gasket for type B6 supporting base element



HC-B 6-FL-DI-N - Seal

1411436

<https://www.phoenixcontact.com/us/products/1411436>

Replacement flange seal, for HEAVYCON type B6 panel mounting base, latching, for panel mounting base with snapped-on flat gaskets, not for HC-.... EMV housing, color: black



HC-B 6-AMLD-AL - Housing

1645464

<https://www.phoenixcontact.com/us/products/1645464>



HC-B 6-FL-DI - Flat gasket

1663019

<https://www.phoenixcontact.com/us/products/1663019>

Replacement flange seal, for HEAVYCON panel mounting base of type B 6, self-adhesive, not for HC-....EMC housings, color: Black



Phoenix Contact 2024 © - all rights reserved

<https://www.phoenixcontact.com>

Phoenix Contact USA
586 Fulling Mill Road
Middletown, PA 17057, United States
(+717) 944-1300
info@phoenixcon.com