

# HC-B 10-SMLD-74/O2M32 - Housing

1646476

<https://www.phoenixcontact.com/us/products/1646476>



Please be informed that the data shown in this PDF document is generated from our online catalog. Please find the complete data in the user documentation. Our general terms of use for downloads are valid.



HEAVYCON box mounting base B10, with single locking latch, height 74 mm, with supports 2xM32, with cover

## Commercial data

Item number	1646476
Packing unit	1 pc
Note	Made to order (non-returnable)
Sales key	BF55
Product key	BF7AAC
Catalog page	Page 496 (C-4-2013)
GTIN	4017918985219
Weight per piece (including packing)	334.8 g
Weight per piece (excluding packing)	334 g
Customs tariff number	85389099
Country of origin	DE

# HC-B 10-SMLD-74/O2M32 - Housing



1646476

<https://www.phoenixcontact.com/us/products/1646476>

## Technical data

### Notes

General	For contact inserts HC-B10, BB18, DD42, M, K8/24
---------	--

### Product properties

Product type	Housing with locking latch
Housing type	Box mounting bases
Application	Standard
Type	B10
No. of cable outlets	2
Type of the screw connection	2x M32
Protective cover	yes
Shielded	no
Cable outlet	lateral
Pg screw connection	none

### Dimensions

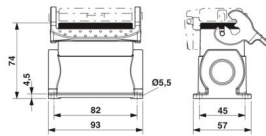
Dimensional drawing	
Width	57 mm
Height	74 mm
Length	93 mm

### Material specifications

Seal material	NBR
Housing material	die-cast aluminum
Housing surface material	Powder-coated, gray
Material, protective cover	PA
Locking latch material	High-grade steel, handle: PA-GF

### Mechanical properties

Mechanical data	
Type of the screw connection	2x M32
Locking type	Latch

### Environmental and real-life conditions

Ambient conditions	
Degree of protection	IP65 (When plugged in)
	IP54 (with closed protective cover)

# HC-B 10-SMLD-74/O2M32 - Housing

1646476

<https://www.phoenixcontact.com/us/products/1646476>



Ambient temperature (operation)	-40 °C ... 125 °C
---------------------------------	-------------------

# HC-B 10-SMLD-74/O2M32 - Housing

1646476

<https://www.phoenixcontact.com/us/products/1646476>



## Drawings

Dimensional drawing

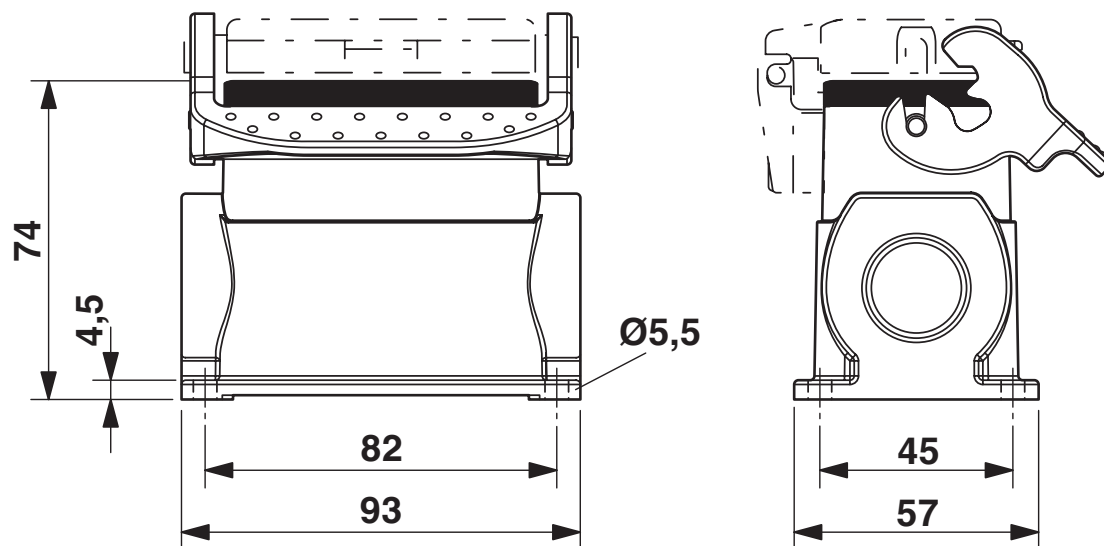

Dimensional drawing

# HC-B 10-SMLD-74/O2M32 - Housing



1646476

<https://www.phoenixcontact.com/us/products/1646476>

## Classifications

### ECLASS

ECLASS-11.0	27440202
ECLASS-13.0	27440202

### UNSPSC

UNSPSC 21.0	31261501
-------------	----------

# HC-B 10-SMLD-74/O2M32 - Housing



1646476

<https://www.phoenixcontact.com/us/products/1646476>

## Environmental product compliance

China RoHS	
Environment friendly use period (EFUP)	EFUP-E
	No hazardous substances above the limits
EU REACH SVHC	
REACH candidate substance (CAS No.)	No substance above 0.1 wt%

# HC-B 10-SMLD-74/O2M32 - Housing

1646476

<https://www.phoenixcontact.com/us/products/1646476>



## Accessories

### G-INS-M32-M68N-PNES-GY - Cable gland

1411127

<https://www.phoenixcontact.com/us/products/1411127>



Cable gland, material for screw connection: PA, application: Standard, external cable diameter 15 mm ... 21 mm, shielding: no, connecting thread: M32 x 1.5, color: silver-grey RAL 7001

---

### G-INS-M32-M68N-PNES-BK - Cable gland

1411136

<https://www.phoenixcontact.com/us/products/1411136>



Cable gland, material for screw connection: PA, application: Standard, external cable diameter 15 mm ... 21 mm, shielding: no, connecting thread: M32 x 1.5, color: jet black RAL 9005

## HC-B 10-SMLD-74/O2M32 - Housing

1646476

<https://www.phoenixcontact.com/us/products/1646476>



## G-INS-M32-M68N-NNES-S - Cable gland

1411166

<https://www.phoenixcontact.com/us/products/1411166>



Cable gland, material for screw connection: Brass, nickel-plated, application: Standard, external cable diameter 15 mm ... 21 mm, shielding: no, connecting thread: M32 x 1.5, color: silver, with O-ring

---

## HC-M-KV-M32(19-27) - Cable gland

1646010

<https://www.phoenixcontact.com/us/products/1646010>



Metal screw connection up to 5 bar, thread length: 8 mm, cable diameter: 19 - 27 mm, WAF 43, screw connection: M32

## HC-B 10-SMLD-74/O2M32 - Housing

1646476

<https://www.phoenixcontact.com/us/products/1646476>



## G-INSEC-M32-M68N-NCRS-S - Cable gland

1411191

<https://www.phoenixcontact.com/us/products/1411191>



Cable gland, material for screw connection: Brass, nickel-plated, application: EMC, external cable diameter 14 mm ... 21 mm, shielding: yes, connecting thread: M32 x 1.5, color: silver, with O-ring

---

## HC-M-KV-Z-M32 - Cable gland

1646162

<https://www.phoenixcontact.com/us/products/1646162>



Metal screw connection with strain relief clamp, thread length: 8 mm, cable sealing area: 18 - 27 mm, clamping area: 19 - 30 mm, SW 40, screw connection: M32

## HC-B 10-SMLD-74/O2M32 - Housing

1646476

<https://www.phoenixcontact.com/us/products/1646476>



## HC-M-KV-T-M32 - Cable gland

1646201

<https://www.phoenixcontact.com/us/products/1646201>

Metal screw connection with cable bend protection and strain relief, thread length: 8 mm, cable sealing area: 18 - 27 mm, clamping area: 20 - 30 mm, SW 40, screw connection: M32



---

## REDUC-M-KV-M32/M25 - Reducing adapter

1647637

<https://www.phoenixcontact.com/us/products/1647637>

Reducing adapter, connecting thread: M32 x 1.5, color: silver, with O-ring



## HC-B 10-SMLD-74/O2M32 - Housing

1646476

<https://www.phoenixcontact.com/us/products/1646476>



## ENLAR-M-KV-M32/M40 - Extension adapter

1647682

<https://www.phoenixcontact.com/us/products/1647682>

Extension adapter, connecting thread: M32 x 1.5, color: silver, with O-ring



---

## HC-M-BS-M32 - Screw plug

1645862

<https://www.phoenixcontact.com/us/products/1645862>

Screw plug, material for screw connection: Brass, nickel-plated, connecting thread: M32 x 1.5, color: silver



---

Phoenix Contact 2024 © - all rights reserved  
<https://www.phoenixcontact.com>

Phoenix Contact USA  
586 Fulling Mill Road  
Middletown, PA 17057, United States  
(+717) 944-1300  
[info@phoenixcon.com](mailto:info@phoenixcon.com)