



Contactor relays,aux.cont.mod.,2-pole

Part no. DILA-XHI20

Article no. 276422



Delivery programme

Product range			Accessories
Accessories			Auxiliary contact modules
Description			with interlocked opposing contacts
Function			for standard applications
Connection technique			Screw terminals
Pole			2 pole
Contacts			
N/O = Normally open			2 N/O
Contact sequence			
Can be combined with basic unit			DILM(C)7... DILM(C)9... DILM(C)12... DILM(C)15... DILM(C)17... DILM(C)25... DILM(C)32... DILM38... DILMP20... DILMP32... DILMP45... DILL...
AC-15			
AC-15			
220 V 230 V 240 V	I <sub>e</sub>	A	4
380 V 400V 415 V	I <sub>e</sub>	A	4
Rated operational current			
AC-1			
Conventional free air thermal current, 3 pole, 50 - 60 Hz			
Open			
at 60 °C	I <sub>th</sub> = I <sub>e</sub>	A	16
Instructions			Interlocked opposing contacts according to IEC/EN 60947-5-1 appendix L, inside the auxiliary contact modules, also for the integrated auxiliary contacts of the DILM 7 - DILM32 Auxiliary contacts used as mirror contacts according to IEC/EN 60947-4-1 Appendix F (not N/C late open)
Code number and version of combination			
DILA(C)-40			60E
DILA(C)-31			51
DILA(C)-22			42

Approbationen

Product Standards	IEC/EN 60947-4-1; UL 508; CSA-C22.2 No. 14-05; CE marking
UL File No.	E29184
UL CCN	NKCR
CSA File No.	012528
CSA Class No.	3211-03
NA Certification	UL Listed, CSA certified
Specially designed for NA	No

Auxiliary contacts

Interlocked opposing contacts within an auxiliary contact module (to IEC 60947-5-1 Annex L)			Yes
N/C contact (not late-break contact) suitable as a mirror contact (to IEC/ EN 60947-4-1 Annex F)			DILM7 - DILM32
Rated impulse withstand voltage	U <sub>imp</sub>	V AC	6000
Overvoltage category/pollution degree			III/3
Rated insulation voltage	U <sub>i</sub>	V AC	690
Rated operational voltage	U <sub>e</sub>	V AC	500
Safe isolation to VDE 0106 Part 101 and Part 101/A1			
between coil and auxiliary contacts		V AC	400
between the auxiliary contacts		V AC	400
Rated operational current	I <sub>e</sub>	A	
AC-15			
230 V	I <sub>e</sub>	A	4
380/415 V	I <sub>e</sub>	A	4
500 V	I <sub>e</sub>	A	1.5
DC L/R $\leq$ 15 ms			
24 V	I <sub>e</sub>	A	10
60 V	I <sub>e</sub>	A	6
110 V	I <sub>e</sub>	A	3
220 V	I <sub>e</sub>	A	1
Rated operational current			
Conventional free air thermal current, 3 pole, 50 - 60 Hz			
Open			
at 60 °C	I <sub>th</sub> = I <sub>e</sub>	A	16
Control circuit reliability (at U <sub>e</sub> = 24 V DC, U <sub>min</sub> = 17 V, I <sub>min</sub> = 5.4 mA)	Failure rate	λ	<10 <sup>-8</sup> , < 1 one failure at 100 million operations
Component lifespan			
at U <sub>e</sub> = 230 V, AC-15, 3 A	Operations	x 10 <sup>6</sup>	1.3
Short-circuit rating without welding			
max. fuse		A gG/gL	10

### Technische Daten nach ETIM 4.0

Suitable for earth leakage circuit breaker			No
Type of electric connection			Screw connection
Rated operation current Ie at AC-15, 230 V		A	4
Mounting type			Front mount
Suitable for pendant switch			No
Suitable for front element			No
Suitable for circuit-breakers			No
Suitable for safety position switches			No
Suitable for step switches			No
Suitable for pressure switch/selector switch actuator			No
Suitable for cam switches			No
Suitable for motor protective circuit breakers			No
Suitable for series-mounting relays			No
Suitable for solenoid			No
Suitable for compact switch-disconnector			No
Suitable for miniature circuit-breakers			No
Suitable for pulse relay			No
Suitable for contactor relay relay			YES
Suitable for pendant pushbutton			No
Suitable for residual current device			No
Number of contacts as change-over contact			0
Number of contacts as N/O			2

Number of contacts as NC		0
Suitable for impulse relays		No
Suitable for position switches		No
Suitable for switch-disconnector/residual current device		No
Suitable for contactors		YES
Suitable for installation contactor / installation relay		No

**CAD-Daten**  
 Product standards CAD data:

<http://eaton-moeller.partcommunity.com>

Dimensions

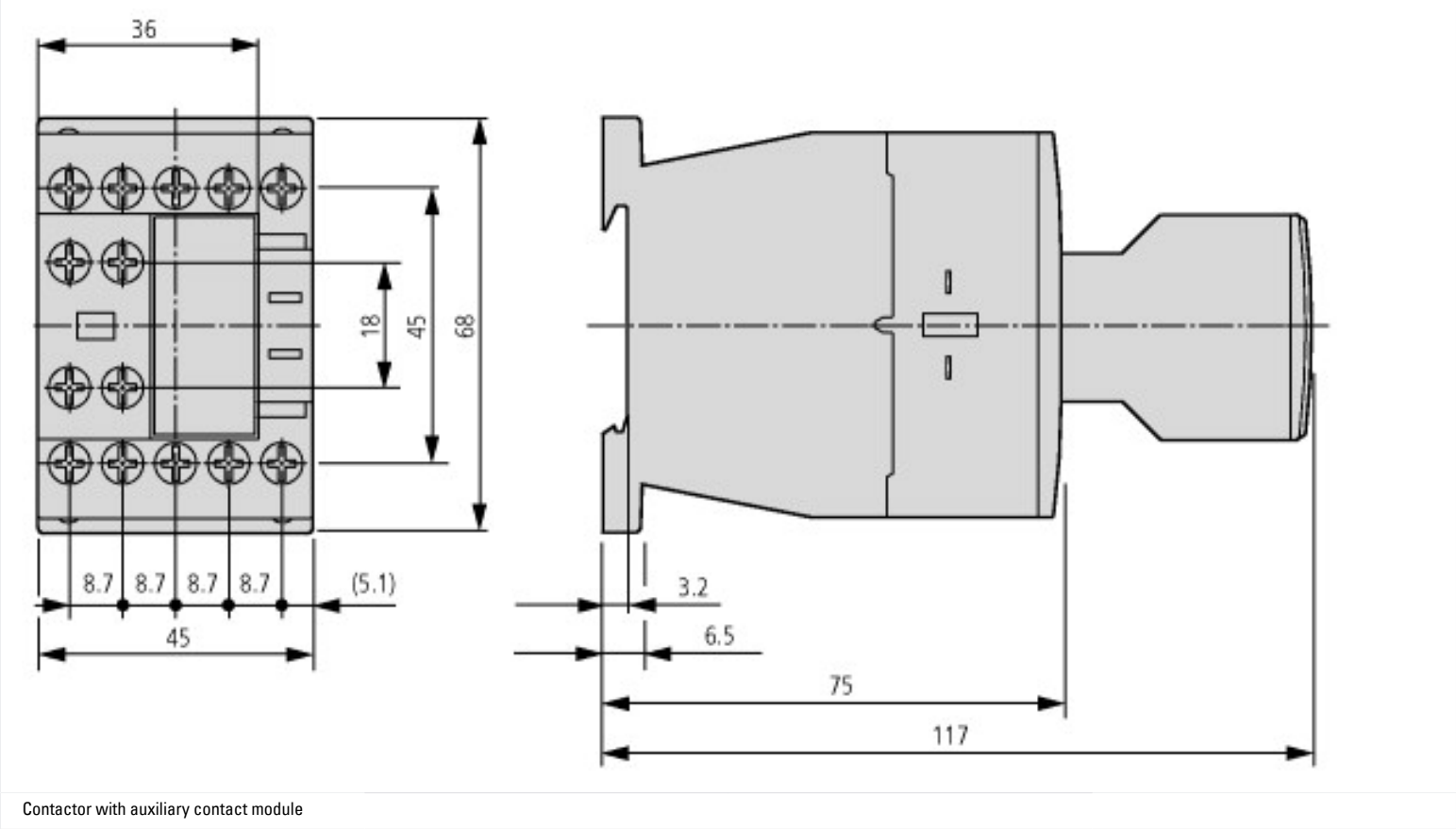

Contactor with auxiliary contact module

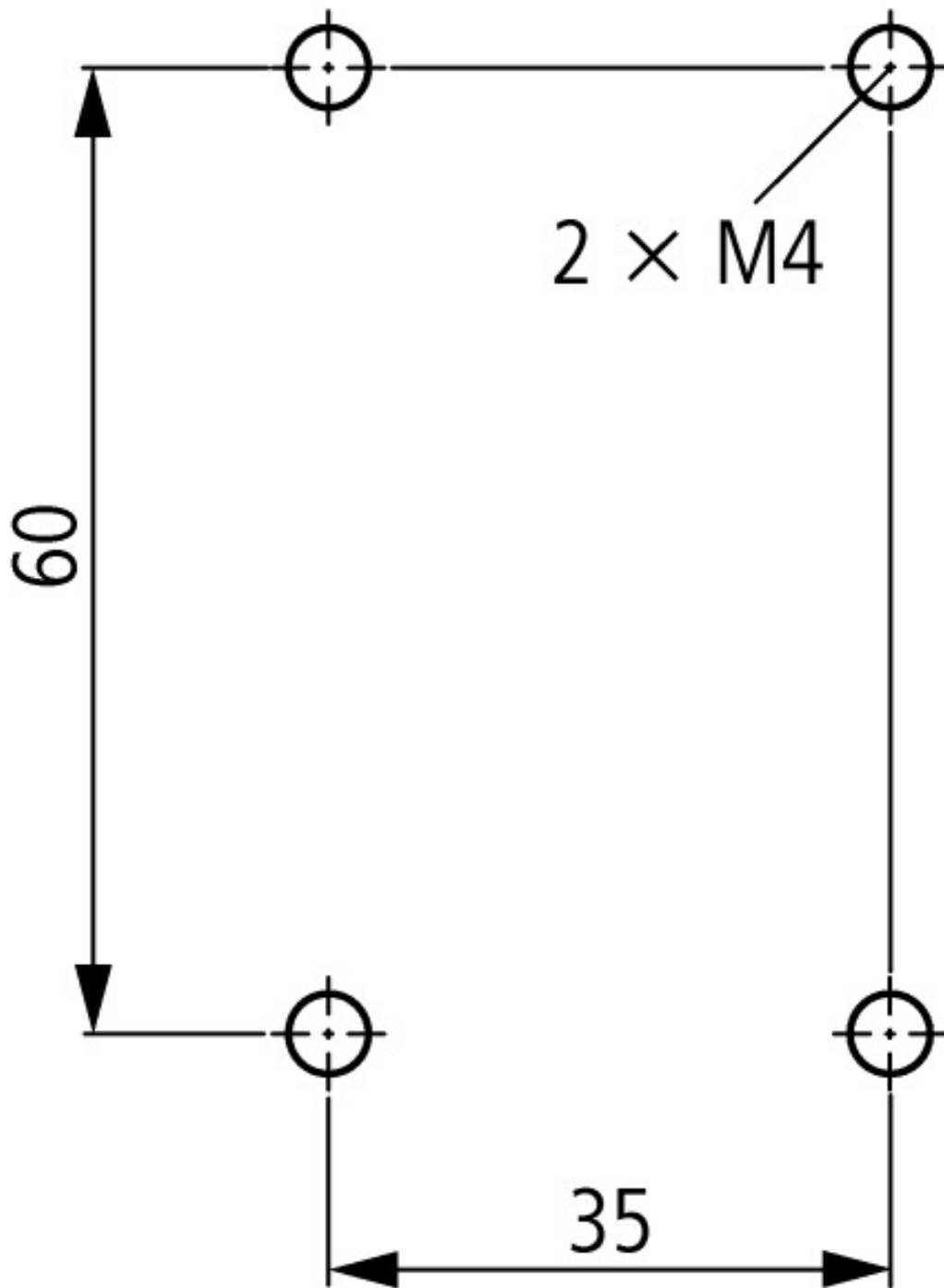

#### Additional product information (links)

IL03407013Z (AWA2100-2126) contactors

[ftp://ftp.moeller.net/DOCUMENTATION/AWA\\_INSTRUCTIONS/IL03407013Z2010\\_10.pdf](ftp://ftp.moeller.net/DOCUMENTATION/AWA_INSTRUCTIONS/IL03407013Z2010_10.pdf)