

UT 4-TWIN RD - Feed-through terminal block



3044365

<https://www.phoenixcontact.com/sk/products/3044365>

Please be informed that the data shown in this PDF document is generated from our online catalog. Please find the complete data in the user documentation. Our general terms of use for downloads are valid.

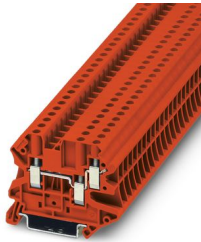

Feed-through terminal block, nom. voltage: 500 V, nominal current: 32 A, number of connections: 3, connection method: Screw connection, 1 level, Rated cross section: 4 mm², cross section: 0.14 mm² - 6 mm², mounting type: NS 35/7,5, NS 35/15, color: red

Your advantages

- The consistent double function shaft offers every opportunity for time-saving potential distribution and accommodating test accessories
- User-friendly implementation of all potential branching tasks

Commercial data

Item number	3044365
Packing unit	50 pc
Minimum order quantity	50 pc
Sales key	BE1
Product key	BE1112
GTIN	4046356751339
Weight per piece (including packing)	14.204 g
Weight per piece (excluding packing)	13.148 g
Customs tariff number	85369010
Country of origin	DE

UT 4-TWIN RD - Feed-through terminal block



3044365

<https://www.phoenixcontact.com/sk/products/3044365>

Technical data

Product properties

Product type	Multi-conductor terminal block
Area of application	Machine building
	Plant engineering
	Process industry
Number of connections	3
Number of rows	1
Potentials	1

Insulation characteristics

Overvoltage category	III
Degree of pollution	3

Electrical properties

Rated surge voltage	6 kV
Maximum power dissipation for nominal condition	1.02 W

Connection data

Number of connections per level	3
Nominal cross section	4 mm ²

1 level

Screw thread	M3
Tightening torque	0.6 ... 0.8 Nm
Stripping length	9 mm
Internal cylindrical gage	A4
Connection in acc. with standard	IEC 60947-7-1
Conductor cross section rigid	0.14 mm ² ... 6 mm ²
Cross section AWG	26 ... 10 (converted acc. to IEC)
Conductor cross section flexible	0.14 mm ² ... 6 mm ²
Conductor cross section, flexible [AWG]	26 ... 10 (converted acc. to IEC)
Conductor cross-section flexible (ferrule without plastic sleeve)	0.14 mm ² ... 4 mm ²
Flexible conductor cross section (ferrule with plastic sleeve)	0.14 mm ² ... 4 mm ²
2 conductors with same cross section, solid	0.14 mm ² ... 1.5 mm ²
2 conductors with same cross section, flexible	0.14 mm ² ... 1.5 mm ²
2 conductors with same cross section, flexible, with ferrule without plastic sleeve	0.14 mm ² ... 1.5 mm ²
2 conductors with the same cross section, flexible, with TWIN ferrule with plastic sleeve	0.5 mm ² ... 1 mm ²
Nominal current	32 A
Maximum load current	41 A (In the case of a 6 mm ² conductor cross section, the maximum load current must not be exceeded by the total current of all connected conductors)

UT 4-TWIN RD - Feed-through terminal block



3044365

<https://www.phoenixcontact.com/sk/products/3044365>

Nominal voltage	500 V
Nominal cross section	4 mm ²

Ex data

Rated data (ATEX/IECEx)

Identification	⊕ II 2 GD Ex eb IIC Gb
Operating temperature range	-60 °C ... 110 °C
Ex-certified accessories	3047141 D-UT 2,5/4-TWIN 3047109 DS-UT 2,5/4 3047183 ATP-UT-TWIN 1212587 SF-SL 0,6X3,5-100 S-VDE 3022276 CLIPFIX 35-5 3022218 CLIPFIX 35
List of bridges	Plug-in bridge / FBS 2-6 / 3030336 Plug-in bridge / FBS 3-6 / 3030242 Plug-in bridge / FBS 4-6 / 3030255 Plug-in bridge / FBS 5-6 / 3030349 Plug-in bridge / FBS 10-6 / 3030271 Plug-in bridge / FBS 20-6 / 3030365
Bridge data	27 A / 4 mm ²
Ex temperature increase	40 K (32.5 A / 4 mm ²)
Rated voltage	352 V
for bridging with bridge	352 V
- At bridging between non-adjacent terminal blocks	352 V
- At bridging between non-adjacent terminal blocks via PE terminal block	275 V
- At cut-to-length bridging with cover	220 V
- At cut-to-length bridging with partition plate	275 V
Rated insulation voltage	320 V
output	(Permanent)

Ex level General

Rated current	29 A
Maximum load current	35 A
Contact resistance	0.44 mΩ

Ex connection data General

Torque range	0.6 Nm ... 0.8 Nm
Nominal cross section	4 mm ²
Rated cross section AWG	12
Connection capacity rigid	0.14 mm ² ... 6 mm ²
Connection capacity AWG	26 ... 10
Connection capacity flexible	0.14 mm ² ... 4 mm ²
Connection capacity AWG	26 ... 12
2 conductors with same cross section, solid	0.14 mm ² ... 1.5 mm ²

UT 4-TWIN RD - Feed-through terminal block



3044365

<https://www.phoenixcontact.com/sk/products/3044365>

2 conductors with the same cross-section AWG rigid	26 ... 16
2 conductors with same cross section, stranded	0.14 mm ² ... 1.5 mm ²
2 conductors with the same cross-section AWG flexible	26 ... 16

Dimensions

Width	6.2 mm
End cover width	2.2 mm
Height	57.8 mm
Depth on NS 35/7,5	47.5 mm
Depth on NS 35/15	55 mm

Material specifications

Color	red
Flammability rating according to UL 94	V0
Insulating material group	I
Insulating material	PA
Static insulating material application in cold	-60 °C
Relative insulation material temperature index (Elec., UL 746 B)	130 °C

Mechanical properties

Mechanical data

Open side panel	Yes
-----------------	-----

Environmental and real-life conditions

Ambient conditions

Ambient temperature (operation)	-60 °C ... 110 °C (Operating temperature range incl. self-heating; for max. short-term operating temperature, see RTI Elec.)
Ambient temperature (storage/transport)	-25 °C ... 60 °C ()
Ambient temperature (assembly)	-5 °C ... 70 °C
Ambient temperature (actuation)	-5 °C ... 70 °C ()
Permissible humidity (operation)	20 % ... 90 %
Permissible humidity (storage/transport)	30 % ... 70 %

Standards and regulations

Connection in acc. with standard	IEC 60947-7-1
----------------------------------	---------------

Mounting

Mounting type	NS 35/7,5
	NS 35/15

UT 4-TWIN RD - Feed-through terminal block



3044365

<https://www.phoenixcontact.com/sk/products/3044365>

Drawings

Circuit diagram



UT 4-TWIN RD - Feed-through terminal block



3044365

<https://www.phoenixcontact.com/sk/products/3044365>

Approvals

To download certificates, visit the product detail page: <https://www.phoenixcontact.com/sk/products/3044365>

DNV

Approval ID: TAE00001S9



CSA

Approval ID: 13631

	Nominal voltage U_N	Nominal current I_N	Cross section AWG	Cross section mm^2
Use group B				
	150 V	30 A	26 - 10	-
Use group C				
	150 V	30 A	26 - 10	-



IECEE CB Scheme

Approval ID: DE1-62912

	Nominal voltage U_N	Nominal current I_N	Cross section AWG	Cross section mm^2
	500 V	-	-	-



EAC

Approval ID: RU C-DE.A*30.B.01742



cULus Recognized

Approval ID: E60425

	Nominal voltage U_N	Nominal current I_N	Cross section AWG	Cross section mm^2
Use group B				
	300 V	30 A	26 - 10	-
Use group C				
	300 V	30 A	26 - 10	-



RS

Approval ID: 22.44.01.00083.250



VDE Zeichengenehmigung

Approval ID: 40040772

	Nominal voltage U_N	Nominal current I_N	Cross section AWG	Cross section mm^2
	500 V	32 A	-	0.14 - 6

UT 4-TWIN RD - Feed-through terminal block



3044365

<https://www.phoenixcontact.com/sk/products/3044365>



ATEX

Approval ID: KEMA06ATEX0017U



cUL Recognized

Approval ID: E192998

	Nominal voltage U_N	Nominal current I_N	Cross section AWG	Cross section mm^2
Use group B	150 V	30 A	26 - 10	-
Use group C	150 V	30 A	26 - 10	-



EAC Ex

Approval ID: RU C-DE.HA91.B.00066



IECEX

Approval ID: IECEX KEM 06.0013U



UL Recognized

Approval ID: E192998

	Nominal voltage U_N	Nominal current I_N	Cross section AWG	Cross section mm^2
Use group B	150 V	30 A	26 - 10	-
Use group C	150 V	30 A	26 - 10	-



CCC

Approval ID: 2020322313000622



UKCA-EX

Approval ID: DEKRA 21UKEX0305U

cULus Recognized

UT 4-TWIN RD - Feed-through terminal block



3044365

<https://www.phoenixcontact.com/sk/products/3044365>

Classifications

ECLASS

ECLASS-11.0	27141120
ECLASS-13.0	27250101

ETIM

ETIM 9.0	EC000897
----------	----------

UNSPSC

UNSPSC 21.0	39121400
-------------	----------

UT 4-TWIN RD - Feed-through terminal block



3044365

<https://www.phoenixcontact.com/sk/products/3044365>

Environmental product compliance

REACH SVHC	Lead 7439-92-1
China RoHS	Environmentally Friendly Use Period = 50 years
	For information on hazardous substances, refer to the manufacturer's declaration available under "Downloads"

UT 4-TWIN RD - Feed-through terminal block

3044365

<https://www.phoenixcontact.com/sk/products/3044365>

Accessories

 Note: Applying some accessories below might limit this product.

FBS 2-6 - Plug-in bridge

3030336

<https://www.phoenixcontact.com/sk/products/3030336>



Plug-in bridge, pitch: 6.2 mm, number of positions: 2, color: red

 Max. current carrying capacity: 32 A

FBS 3-6 - Plug-in bridge

3030242

<https://www.phoenixcontact.com/sk/products/3030242>



Plug-in bridge, pitch: 6.2 mm, number of positions: 3, color: red

 Max. current carrying capacity: 32 A

UT 4-TWIN RD - Feed-through terminal block

3044365

<https://www.phoenixcontact.com/sk/products/3044365>



FBS 4-6 - Plug-in bridge

3030255

<https://www.phoenixcontact.com/sk/products/3030255>



Plug-in bridge, pitch: 6.2 mm, number of positions: 4, color: red

 Max. current carrying capacity: 32 A

FBS 5-6 - Plug-in bridge

3030349

<https://www.phoenixcontact.com/sk/products/3030349>



Plug-in bridge, pitch: 6.2 mm, number of positions: 5, color: red

 Max. current carrying capacity: 32 A

UT 4-TWIN RD - Feed-through terminal block

3044365

<https://www.phoenixcontact.com/sk/products/3044365>

FBS 6-6 - Plug-in bridge

1008238

<https://www.phoenixcontact.com/sk/products/1008238>



Plug-in bridge, One side not fully isolated, pitch: 6.2 mm, number of positions: 6, color: red

 Max. current carrying capacity: 32 A

FBS 10-6 - Plug-in bridge

3030271

<https://www.phoenixcontact.com/sk/products/3030271>



Plug-in bridge, pitch: 6.2 mm, number of positions: 10, color: red

 Max. current carrying capacity: 32 A

UT 4-TWIN RD - Feed-through terminal block

3044365

<https://www.phoenixcontact.com/sk/products/3044365>

FBS 20-6 - Plug-in bridge

3030365

<https://www.phoenixcontact.com/sk/products/3030365>



Plug-in bridge, pitch: 6.2 mm, number of positions: 20, color: red

 Max. current carrying capacity: 32 A

FBS 50-6 - Plug-in bridge

3032224

<https://www.phoenixcontact.com/sk/products/3032224>



Plug-in bridge, pitch: 6.2 mm, number of positions: 50, color: red

 Max. current carrying capacity: 32 A

UT 4-TWIN RD - Feed-through terminal block

3044365

<https://www.phoenixcontact.com/sk/products/3044365>



FBSR 2-6 - Plug-in bridge

3033715

<https://www.phoenixcontact.com/sk/products/3033715>



Plug-in bridge, pitch: 6.2 mm, number of positions: 2, color: red

 Max. current carrying capacity: 24 A

FBSR 3-6 - Plug-in bridge

3001594

<https://www.phoenixcontact.com/sk/products/3001594>



Plug-in bridge, pitch: 6.2 mm, number of positions: 3, color: red

 Max. current carrying capacity: 24 A

UT 4-TWIN RD - Feed-through terminal block

3044365

<https://www.phoenixcontact.com/sk/products/3044365>



FBSR 4-6 - Plug-in bridge

3001595

<https://www.phoenixcontact.com/sk/products/3001595>



Plug-in bridge, pitch: 6.2 mm, number of positions: 4, color: red

 Max. current carrying capacity: 24 A

FBSR 5-6 - Plug-in bridge

3001596

<https://www.phoenixcontact.com/sk/products/3001596>



Plug-in bridge, pitch: 6.2 mm, number of positions: 5, color: red

 Max. current carrying capacity: 24 A

UT 4-TWIN RD - Feed-through terminal block

3044365

<https://www.phoenixcontact.com/sk/products/3044365>



FBSR 10-6 - Plug-in bridge

3033716

<https://www.phoenixcontact.com/sk/products/3033716>



Plug-in bridge, pitch: 6.2 mm, number of positions: 10, color: red

 Max. current carrying capacity: 24 A

FBSRH 2-6 - Short-circuit connector

3033812

<https://www.phoenixcontact.com/sk/products/3033812>



Short-circuit connector, pitch: 6.2 mm, number of positions: 2, color: red

 Max. current carrying capacity: 24 A

UT 4-TWIN RD - Feed-through terminal block

3044365

<https://www.phoenixcontact.com/sk/products/3044365>



FBS 2-6 BU - Plug-in bridge

3036932

<https://www.phoenixcontact.com/sk/products/3036932>



Plug-in bridge, pitch: 6.2 mm, number of positions: 2, color: blue

 Max. current carrying capacity: 32 A

FBS 3-6 BU - Plug-in bridge

3036945

<https://www.phoenixcontact.com/sk/products/3036945>



Plug-in bridge, pitch: 6.2 mm, number of positions: 3, color: blue

 Max. current carrying capacity: 32 A

UT 4-TWIN RD - Feed-through terminal block

3044365

<https://www.phoenixcontact.com/sk/products/3044365>



FBS 4-6 BU - Plug-in bridge

3036958

<https://www.phoenixcontact.com/sk/products/3036958>



Plug-in bridge, pitch: 6.2 mm, number of positions: 4, color: blue

 Max. current carrying capacity: 32 A

FBS 5-6 BU - Plug-in bridge

3036961

<https://www.phoenixcontact.com/sk/products/3036961>



Plug-in bridge, pitch: 6.2 mm, number of positions: 5, color: blue

 Max. current carrying capacity: 32 A

UT 4-TWIN RD - Feed-through terminal block

3044365

<https://www.phoenixcontact.com/sk/products/3044365>



FBS 10-6 BU - Plug-in bridge

3032198

<https://www.phoenixcontact.com/sk/products/3032198>

Plug-in bridge, pitch: 6.2 mm, number of positions: 10, color: blue



 Max. current carrying capacity: 32 A

FBS 20-6 BU - Plug-in bridge

3032208

<https://www.phoenixcontact.com/sk/products/3032208>

Plug-in bridge, pitch: 6.2 mm, number of positions: 20, color: blue

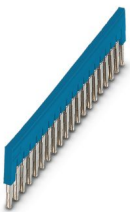

 Max. current carrying capacity: 32 A

UT 4-TWIN RD - Feed-through terminal block

3044365

<https://www.phoenixcontact.com/sk/products/3044365>



FBS 50-6 BU - Plug-in bridge

3032211

<https://www.phoenixcontact.com/sk/products/3032211>



Plug-in bridge, pitch: 6.2 mm, number of positions: 50, color: blue

 Max. current carrying capacity: 32 A

RB ST 10-(2,5/4) - Reducing bridge

3030873

<https://www.phoenixcontact.com/sk/products/3030873>



Reducing bridge, pitch: 10 mm, number of positions: 2, length: 36 mm, color: red

 Max. current carrying capacity: 35 A

UT 4-TWIN RD - Feed-through terminal block

3044365

<https://www.phoenixcontact.com/sk/products/3044365>

RB UT 10-(2,5/4) - Reducing bridge

3047060

<https://www.phoenixcontact.com/sk/products/3047060>



Reducing bridge, pitch: 10.2 mm, number of positions: 2, length: 29 mm, color: red

 Max. current carrying capacity: 40 A

RB UT 35-(2,5/4) - Reducing bridge

3047277

<https://www.phoenixcontact.com/sk/products/3047277>



Reducing bridge, pitch: 11 mm, number of positions: 2, color: red

 Max. current carrying capacity: 40 A

UT 4-TWIN RD - Feed-through terminal block

3044365

<https://www.phoenixcontact.com/sk/products/3044365>

RB UT 16-(2,5/4) - Reducing bridge

3047073

<https://www.phoenixcontact.com/sk/products/3047073>



Reducing bridge, pitch: 11 mm, number of positions: 2, length: 31 mm, color: red

 Max. current carrying capacity: 40 A

RB UT 6-(2,5/4) - Reducing bridge

3047251

<https://www.phoenixcontact.com/sk/products/3047251>



Reducing bridge, pitch: 9.5 mm, number of positions: 2, length: 25 mm, color: red

 Max. current carrying capacity: 40 A

UT 4-TWIN RD - Feed-through terminal block



3044365

<https://www.phoenixcontact.com/sk/products/3044365>

DS-UT 2,5/4 - Cover segment

3047109

<https://www.phoenixcontact.com/sk/products/3047109>



Cover segment, color: gray

D-UT 2,5/4-TWIN - End cover

3047141

<https://www.phoenixcontact.com/sk/products/3047141>



End cover, depth: 39.8 mm, width: 2.2 mm, height: 56.8 mm, color: gray

UT 4-TWIN RD - Feed-through terminal block



3044365

<https://www.phoenixcontact.com/sk/products/3044365>

ATP-UT-TWIN - Partition plate

3047183

<https://www.phoenixcontact.com/sk/products/3047183>



Partition plate, depth: 52.5 mm, width: 2.2 mm, height: 62.1 mm, color: gray

PS-6/2,3MM RD - Test plug

3038736

<https://www.phoenixcontact.com/sk/products/3038736>



Test plug, number of positions: 1, color: red

UT 4-TWIN RD - Feed-through terminal block

3044365

<https://www.phoenixcontact.com/sk/products/3044365>



WS UT 4 - Warning label

3047332

<https://www.phoenixcontact.com/sk/products/3047332>

Warning sign for UT terminal blocks

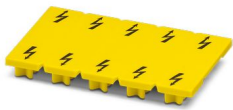

LPS-6/E - Service connector

3270540

<https://www.phoenixcontact.com/sk/products/3270540>



Service connector, nom. voltage: 800 V, nominal current: 24 A, number of positions: 1, connection method: Push-in connection, Rated cross section: 2.5 mm², cross section: 0.14 mm²- 4 mm², color: red

UT 4-TWIN RD - Feed-through terminal block



3044365

<https://www.phoenixcontact.com/sk/products/3044365>

LPS-6 - Service connector

3270541

<https://www.phoenixcontact.com/sk/products/3270541>



Service connector, nom. voltage: 800 V, nominal current: 24 A, number of positions: 1, connection method: Push-in connection, Rated cross section: 2.5 mm², cross section: 0.14 mm²- 4 mm², color: red

LPO 4/E - Pick-up plug

3270519

<https://www.phoenixcontact.com/sk/products/3270519>



Pick-up plug, nom. voltage: 800 V, nominal current: 24 A, number of positions: 1, connection method: Push-in connection, Rated cross section: 2.5 mm², cross section: 0.14 mm²- 4 mm², color: gray

UT 4-TWIN RD - Feed-through terminal block



3044365

<https://www.phoenixcontact.com/sk/products/3044365>

LPO 4 - Pick-up plug

3270522

<https://www.phoenixcontact.com/sk/products/3270522>



Pick-up plug, nom. voltage: 800 V, nominal current: 24 A, number of positions: 1, connection method: Push-in connection, Rated cross section: 2.5 mm², cross section: 0.14 mm²- 4 mm², color: gray

NS 35/ 7,5 PERF 2000MM - DIN rail perforated

0801733

<https://www.phoenixcontact.com/sk/products/0801733>



DIN rail perforated, Pack of 25 (50 m), acc. to EN 60715, material: Steel, galvanized, passivated with a thick layer, Standard profile, color: silver

UT 4-TWIN RD - Feed-through terminal block

3044365

<https://www.phoenixcontact.com/sk/products/3044365>



NS 35/ 7,5 UNPERF 2000MM - DIN rail, unperforated

0801681

<https://www.phoenixcontact.com/sk/products/0801681>



DIN rail, unperforated, Pack of 25 (50 m), acc. to EN 60715, material: Steel, galvanized, passivated with a thick layer, Standard profile, color: silver

NS 35/ 7,5 WH PERF 2000MM - DIN rail perforated

1204119

<https://www.phoenixcontact.com/sk/products/1204119>



DIN rail perforated, Pack of 25 (50 m), acc. to EN 60715, material: Steel, Galvanized, white passivated, Standard profile, color: silver

UT 4-TWIN RD - Feed-through terminal block

3044365

<https://www.phoenixcontact.com/sk/products/3044365>



NS 35/ 7,5 WH UNPERF 2000MM-VPE 10 - DIN rail, unperforated

1204122

<https://www.phoenixcontact.com/sk/products/1204122>



DIN rail, unperforated, Pack of 10 (20 m), acc. to EN 60715, material: Steel, Galvanized, white passivated, Standard profile, color: silver

NS 35/ 7,5 AL UNPERF 2000MM - DIN rail, unperforated

0801704

<https://www.phoenixcontact.com/sk/products/0801704>



DIN rail, unperforated, Pack of 25 (50 m), acc. to EN 60715, material: Aluminum, uncoated, Standard profile, color: silver

UT 4-TWIN RD - Feed-through terminal block

3044365

<https://www.phoenixcontact.com/sk/products/3044365>



NS 35/ 7,5 ZN PERF 2000MM - DIN rail perforated

1206421

<https://www.phoenixcontact.com/sk/products/1206421>



DIN rail perforated, Pack of 25 (50 m), acc. to EN 60715, material: Steel, galvanized, Standard profile, color: silver

NS 35/ 7,5 ZN UNPERF 2000MM - DIN rail, unperforated

1206434

<https://www.phoenixcontact.com/sk/products/1206434>



DIN rail, unperforated, Pack of 25 (50 m), acc. to EN 60715, material: Steel, galvanized, Standard profile, color: silver

UT 4-TWIN RD - Feed-through terminal block

3044365

<https://www.phoenixcontact.com/sk/products/3044365>



NS 35/ 7,5 CU UNPERF 2000MM-VPE 10 - DIN rail, unperforated

0801762

<https://www.phoenixcontact.com/sk/products/0801762>



DIN rail, unperforated, Pack of 10 (20 m), acc. to EN 60715, material: Copper, uncoated, Standard profile, color: copper-colored

NS 35/ 7,5 CAP - End cap

1206560

<https://www.phoenixcontact.com/sk/products/1206560>

DIN rail end piece, for DIN rail NS 35/7.5



UT 4-TWIN RD - Feed-through terminal block

3044365

<https://www.phoenixcontact.com/sk/products/3044365>



NS 35/15 PERF 2000MM - DIN rail perforated

1201730

<https://www.phoenixcontact.com/sk/products/1201730>



DIN rail perforated, Pack of 25 (50 m), similar to EN 60715, material: Steel, galvanized, passivated with a thick layer, Standard profile, color: silver

NS 35/15 UNPERF 2000MM - DIN rail, unperforated

1201714

<https://www.phoenixcontact.com/sk/products/1201714>



DIN rail, unperforated, Pack of 25 (50 m), similar to EN 60715, material: Steel, galvanized, passivated with a thick layer, Standard profile, color: silver

UT 4-TWIN RD - Feed-through terminal block

3044365

<https://www.phoenixcontact.com/sk/products/3044365>



NS 35/15 WH PERF 2000MM - DIN rail perforated

0806602

<https://www.phoenixcontact.com/sk/products/0806602>



DIN rail perforated, Pack of 25 (50 m), similar to EN 60715, material: Steel, Galvanized, white passivated, Standard profile, color: white

NS 35/15 WH UNPERF 2000MM-VPE 10 - DIN rail, unperforated

1204135

<https://www.phoenixcontact.com/sk/products/1204135>



DIN rail, unperforated, Pack of 10 (20 m), similar to EN 60715, material: Steel, Galvanized, white passivated, Standard profile, color: silver

UT 4-TWIN RD - Feed-through terminal block



3044365

<https://www.phoenixcontact.com/sk/products/3044365>

NS 35/15 AL UNPERF 2000MM - DIN rail, unperforated

1201756

<https://www.phoenixcontact.com/sk/products/1201756>



DIN rail, unperforated, similar to EN 60715, material: Aluminum, uncoated, Standard profile, color: silver

NS 35/15 ZN PERF 2000MM - DIN rail perforated

1206599

<https://www.phoenixcontact.com/sk/products/1206599>



DIN rail perforated, Pack of 25 (50 m), similar to EN 60715, material: Steel, galvanized, Standard profile, color: silver

UT 4-TWIN RD - Feed-through terminal block

3044365

<https://www.phoenixcontact.com/sk/products/3044365>



NS 35/15 ZN UNPERF 2000MM - DIN rail, unperforated

1206586

<https://www.phoenixcontact.com/sk/products/1206586>



DIN rail, unperforated, Pack of 25 (50 m), similar to EN 60715, material: Steel, galvanized, Standard profile, color: silver

NS 35/15 CU UNPERF 2000MM-VPE 10 - DIN rail, unperforated

1201895

<https://www.phoenixcontact.com/sk/products/1201895>



DIN rail, unperforated, Pack of 10 (20 m), similar to EN 60715, material: Copper, uncoated, Standard profile, color: copper-colored

UT 4-TWIN RD - Feed-through terminal block

3044365

<https://www.phoenixcontact.com/sk/products/3044365>



NS 35/15 CAP - End cap

1206573

<https://www.phoenixcontact.com/sk/products/1206573>

DIN rail end piece, for DIN rail NS 35/15



NS 35/15-2,3 UNPERF 2000MM-VPE 10 - DIN rail, unperforated

1201798

<https://www.phoenixcontact.com/sk/products/1201798>

DIN rail, unperforated, Pack of 10 (20 m), acc. to EN 60715, material: Steel, galvanized, passivated with a thick layer, Standard profile 2.3 mm, color: silver



UT 4-TWIN RD - Feed-through terminal block



3044365

<https://www.phoenixcontact.com/sk/products/3044365>

ZB 6:UNBEDRUCKT - Zack marker strip

1051003

<https://www.phoenixcontact.com/sk/products/1051003>



Zack marker strip, Strip, white, unlabeled, can be labeled with: PLOTMARK, CMS-P1-PLOTTER, mounting type: snapped, for terminal block width: 6.2 mm, lettering field size: 6.15 x 10.5 mm, Number of individual labels: 10

ZB 6 CUS - Zack marker strip

0824992

<https://www.phoenixcontact.com/sk/products/0824992>



Zack marker strip, can be ordered: Strip, white, labeled according to customer specifications, mounting type: snap into tall marker groove, for terminal block width: 6.2 mm, lettering field size: 6.15 x 10.5 mm, Number of individual labels: 10

UT 4-TWIN RD - Feed-through terminal block

3044365

<https://www.phoenixcontact.com/sk/products/3044365>

ZB 6,LGS:FORTL.ZAHLEN - Zack marker strip

1051016

<https://www.phoenixcontact.com/sk/products/1051016>

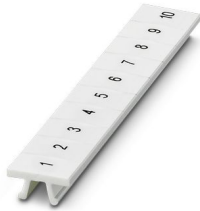

Zack marker strip, Strip, white, labeled, can be labeled with: CMS-P1-PLOTTER, printed horizontally: consecutive numbers 1 ... 10, 11 ... 20, etc. up to 491 ... 500, mounting type: snapped, for terminal block width: 6.2 mm, lettering field size: 6. 15 x 10.5 mm, Number of individual labels: 10

ZB 6,QR:FORTL.ZAHLEN - Zack marker strip

1051029

<https://www.phoenixcontact.com/sk/products/1051029>

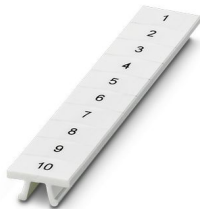

Zack marker strip, Strip, white, labeled, can be labeled with: CMS-P1-PLOTTER, Printed vertically: consecutive numbers 1 ... 10, 11 ... 20, etc. up to 491 ... 500, mounting type: snapped, for terminal block width: 6.2 mm, lettering field size: 6. 15 x 10.5 mm, Number of individual labels: 10

UT 4-TWIN RD - Feed-through terminal block

3044365

<https://www.phoenixcontact.com/sk/products/3044365>

ZB 6,LGS:GLEICHE ZAHLEN - Zack marker strip

1051032

<https://www.phoenixcontact.com/sk/products/1051032>



Zack marker strip, Strip, white, labeled, can be labeled with: CMS-P1-PLOTTER, printed horizontally: Identical numbers 1 or 2, etc. up to 100, mounting type: snapped, for terminal block width: 6.2 mm, lettering field size: 6.15 x 10.5 mm, Number of individual labels: 10

ZB 6,LGS:L1-N,PE - Marker for terminal blocks

1051414

<https://www.phoenixcontact.com/sk/products/1051414>



Marker for terminal blocks, Strip, white, labeled, can be labeled with: CMS-P1-PLOTTER, horizontal: L1, L2, L3, N, PE, L1, L2, L3, N, PE, mounting type: snapped, for terminal block width: 6.2 mm, lettering field size: 6.15 x 10.5 mm, Number of individual labels: 10

UT 4-TWIN RD - Feed-through terminal block



3044365

<https://www.phoenixcontact.com/sk/products/3044365>

ZB 6,LGS:U-N - Marker for terminal blocks

1051430

<https://www.phoenixcontact.com/sk/products/1051430>



Marker for terminal blocks, Strip, white, labeled, can be labeled with: CMS-P1-PLOTTER, printed horizontally: U, V, W, N, GND, U, V, W, N, GND, mounting type: snapped, for terminal block width: 6.2 mm, lettering field size: 6.15 x 10.5 mm, Number of individual labels: 10

UC-TM 6 - Marker for terminal blocks

0818085

<https://www.phoenixcontact.com/sk/products/0818085>



Marker for terminal blocks, Sheet, white, unlabeled, can be labeled with: BLUEMARK ID COLOR, BLUEMARK ID, BLUEMARK CLED, PLOTMARK, CMS-P1-PLOTTER, mounting type: snapped, for terminal block width: 6.2 mm, lettering field size: 5.6 x 10.5 mm, Number of individual labels: 80

UT 4-TWIN RD - Feed-through terminal block



3044365

<https://www.phoenixcontact.com/sk/products/3044365>

UC-TM 6 CUS - Marker for terminal blocks

0824589

<https://www.phoenixcontact.com/sk/products/0824589>



Marker for terminal blocks, can be ordered: by sheet, white, labeled according to customer specifications, mounting type: snap into tall marker groove, for terminal block width: 6.2 mm, lettering field size: 5.6 x 10.5 mm, Number of individual labels: 80

UCT-TM 6 - Marker for terminal blocks

0828736

<https://www.phoenixcontact.com/sk/products/0828736>



Marker for terminal blocks, Sheet, white, unlabeled, can be labeled with: TOPMARK NEO, TOPMARK LASER, BLUEMARK ID COLOR, BLUEMARK ID, BLUEMARK CLED, THERMOMARK PRIME, THERMOMARK CARD 2.0, THERMOMARK CARD, mounting type: snapped, for terminal block width: 6.2 mm, lettering field size: 5.6 x 10.5 mm, Number of individual labels: 60

UT 4-TWIN RD - Feed-through terminal block

3044365

<https://www.phoenixcontact.com/sk/products/3044365>



UCT-TM 6 CUS - Marker for terminal blocks

0829602

<https://www.phoenixcontact.com/sk/products/0829602>



Marker for terminal blocks, can be ordered: by sheet, white, labeled according to customer specifications, mounting type: snap into tall marker groove, for terminal block width: 6.2 mm, lettering field size: 5.6 x 10.5 mm, Number of individual labels: 60

MPS-MT - Test plug

0201744

<https://www.phoenixcontact.com/sk/products/0201744>



Test plug, with solder connection up to 1 mm² conductor cross section, number of positions: 1, color: gray

UT 4-TWIN RD - Feed-through terminal block

3044365

<https://www.phoenixcontact.com/sk/products/3044365>

MPS-IH WH - Insulating sleeve

0201663

<https://www.phoenixcontact.com/sk/products/0201663>

Insulating sleeve, color: white



MPS-IH RD - Insulating sleeve

0201676

<https://www.phoenixcontact.com/sk/products/0201676>

Insulating sleeve, color: red



UT 4-TWIN RD - Feed-through terminal block

3044365

<https://www.phoenixcontact.com/sk/products/3044365>

MPS-IH BU - Insulating sleeve

0201689

<https://www.phoenixcontact.com/sk/products/0201689>

Insulating sleeve, color: blue

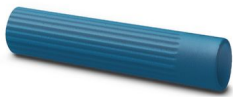

MPS-IH YE - Insulating sleeve

0201692

<https://www.phoenixcontact.com/sk/products/0201692>

Insulating sleeve, color: yellow



UT 4-TWIN RD - Feed-through terminal block

3044365

<https://www.phoenixcontact.com/sk/products/3044365>



MPS-IH GN - Insulating sleeve

0201702

<https://www.phoenixcontact.com/sk/products/0201702>

Insulating sleeve, color: green



MPS-IH GY - Insulating sleeve

0201728

<https://www.phoenixcontact.com/sk/products/0201728>

Insulating sleeve, color: gray



UT 4-TWIN RD - Feed-through terminal block

3044365

<https://www.phoenixcontact.com/sk/products/3044365>



MPS-IH BK - Insulating sleeve

0201731

<https://www.phoenixcontact.com/sk/products/0201731>

Insulating sleeve, color: black



PAI-4-FIX-5/6 BU - Test adapter

3035975

<https://www.phoenixcontact.com/sk/products/3035975>

4 mm test adapter, for terminal blocks with 5.2 mm and 6.2 mm pitch



UT 4-TWIN RD - Feed-through terminal block



3044365

<https://www.phoenixcontact.com/sk/products/3044365>

PAI-4-FIX-5/6 OG - Test adapter

3035974

<https://www.phoenixcontact.com/sk/products/3035974>



4 mm test adapter, for terminal blocks with 5.2 mm and 6.2 mm pitch

PAI-4-FIX-5/6 YE - Test adapter

3035977

<https://www.phoenixcontact.com/sk/products/3035977>



4 mm test adapter, for terminal blocks with 5.2 mm and 6.2 mm pitch

UT 4-TWIN RD - Feed-through terminal block



3044365

<https://www.phoenixcontact.com/sk/products/3044365>

PAI-4-FIX-5/6 RD - Test adapter

3035976

<https://www.phoenixcontact.com/sk/products/3035976>



4 mm test adapter, for terminal blocks with 5.2 mm and 6.2 mm pitch

PAI-4-FIX-5/6 GN - Test adapter

3035978

<https://www.phoenixcontact.com/sk/products/3035978>



4 mm test adapter, for terminal blocks with 5.2 mm and 6.2 mm pitch

UT 4-TWIN RD - Feed-through terminal block



3044365

<https://www.phoenixcontact.com/sk/products/3044365>

PAI-4-FIX-5/6 BK - Test adapter

3035980

<https://www.phoenixcontact.com/sk/products/3035980>



4 mm test adapter, for terminal blocks with 5.2 mm and 6.2 mm pitch

PAI-4-FIX-5/6 GY - Test adapter

3035982

<https://www.phoenixcontact.com/sk/products/3035982>



4 mm test adapter, for terminal blocks with 5.2 mm and 6.2 mm pitch

UT 4-TWIN RD - Feed-through terminal block



3044365

<https://www.phoenixcontact.com/sk/products/3044365>

PAI-4-FIX-5/6 VT - Test adapter

3035979

<https://www.phoenixcontact.com/sk/products/3035979>



4 mm test adapter, for terminal blocks with 5.2 mm and 6.2 mm pitch

PAI-4-FIX-5/6 BN - Test adapter

3035981

<https://www.phoenixcontact.com/sk/products/3035981>



4 mm test adapter, for terminal blocks with 5.2 mm and 6.2 mm pitch

UT 4-TWIN RD - Feed-through terminal block

3044365

<https://www.phoenixcontact.com/sk/products/3044365>



PAI-4-FIX-5/6 WH - Test adapter

3035983

<https://www.phoenixcontact.com/sk/products/3035983>



4 mm test adapter, for terminal blocks with 5.2 mm and 6.2 mm pitch

PS-6 - Test plug

3030996

<https://www.phoenixcontact.com/sk/products/3030996>



Test plug, Modular test plug, number of positions: 1, color: red

UT 4-TWIN RD - Feed-through terminal block

3044365

<https://www.phoenixcontact.com/sk/products/3044365>

CLIPFIX 35 - End bracket

3022218

<https://www.phoenixcontact.com/sk/products/3022218>



Quick mounting end clamp for NS 35/7,5 DIN rail or NS 35/15 DIN rail, with marking option, width: 9.5 mm, color: gray

CLIPFIX 35-5 - End bracket

3022276

<https://www.phoenixcontact.com/sk/products/3022276>



Quick mounting end clamp for NS 35/7,5 DIN rail or NS 35/15 DIN rail, with marking option, with parking option for FBS...5, FBS...6, KSS 5, KSS 6, width: 5.15 mm, color: gray

UT 4-TWIN RD - Feed-through terminal block

3044365

<https://www.phoenixcontact.com/sk/products/3044365>



E/NS 35 N - End bracket

0800886

<https://www.phoenixcontact.com/sk/products/0800886>

End clamp, width: 9.5 mm, color: gray

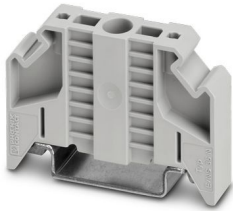

PAI-4-N GY - Test adapter

3032871

<https://www.phoenixcontact.com/sk/products/3032871>

4 mm test adapter, for terminal blocks with 5.2 mm, 6.2 mm and 8.2 mm pitch



UT 4-TWIN RD - Feed-through terminal block

3044365

<https://www.phoenixcontact.com/sk/products/3044365>



SF-SL 0,6X3,5-100 S-VDE - Screwdriver

1212587

<https://www.phoenixcontact.com/sk/products/1212587>



Actuation tool, for ST terminal blocks, VDE insulated, with slimmer insulation integrated in the blade, also suitable for use as a bladed screwdriver, size: 0.6 x 3.5 x 100 mm, 2-component grip, with non-slip grip

X-PEN 0,35 - Marker pen

0811228

<https://www.phoenixcontact.com/sk/products/0811228>



Marker pen without ink cartridge, for manual labeling of markers, labeling extremely wipe-proof, line thickness 0.35 mm

Phoenix Contact 2024 © - all rights reserved

<https://www.phoenixcontact.com>

PHOENIX CONTACT s.r.o.

Námestie Mateja Korvína 1

811 07 Bratislava

+421 2 3210 1470

obchod.sk@phoenixcontact.com