

# AI-TWIN 2X16 -16 BU - Ferrule



3202847

<https://www.phoenixcontact.com/us/products/3202847>

Please be informed that the data shown in this PDF document is generated from our online catalog. Please find the complete data in the user documentation. Our general terms of use for downloads are valid.



Ferrule, Length contact range: 16 mm, sleeve length: 30 mm, color: blue

## Your advantages

- These special ferrules allow chain bridges to be set up with ease
- The TWIN ferrules provide a practical way of crimping two conductors in one ferrule
- Different versions of the individual TWIN ferrules can be selected for specific applications

## Commercial data

Item number	3202847
Packing unit	50 pc
Minimum order quantity	50 pc
Sales key	BH34
Product key	BH3413
Catalog page	Page 486 (C-3-2019)
GTIN	4017918171575
Weight per piece (including packing)	1.607 g
Weight per piece (excluding packing)	1.723 g
Customs tariff number	85369010
Country of origin	DE

# AI-TWIN 2X16 -16 BU - Ferrule



3202847

<https://www.phoenixcontact.com/us/products/3202847>

## Technical data

### Product properties

Product type	Cable end sleeve
Conductor category	stranded conductors, class 2, 5, 6 / B, C, K, M
Product property	UL certified

### Data management status

Article revision	03
------------------	----

### Connection data

#### Conductor connection

Conductor cross section flexible max.	16 mm <sup>2</sup>
Conductor cross section AWG max.	6
Stripping length	21 mm

### Dimensions

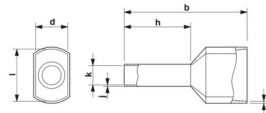
Dimensional drawing	
Sleeve length	30 mm
Length contact range	16 mm
Maximum stripping length	21 mm
Ferrule diameter	8.5 mm
Sleeve wall thickness	0.2 mm
Insulating collar thickness	0.5 mm
Inner dimensions of the insulating collar	8.8 mm

### Material specifications

Color	blue (RAL 5015)
Material	CU-DHP
Flammability rating according to UL 94	HB
Coating	tin-plated (galvanic)
Surface characteristics	Tin-plated
Components	free from silicone and halogen

### Mechanical properties

Technical data	
Sleeve length	30 mm

### Environmental and real-life conditions

# AI-TWIN 2X16 -16 BU - Ferrule



3202847

<https://www.phoenixcontact.com/us/products/3202847>

## Ambient conditions

Permanent temperature	105 °C (-40 °C no load / 0 °C dynamic load)
Short-term temperature	120 °C

## Drawings

Dimensional drawing

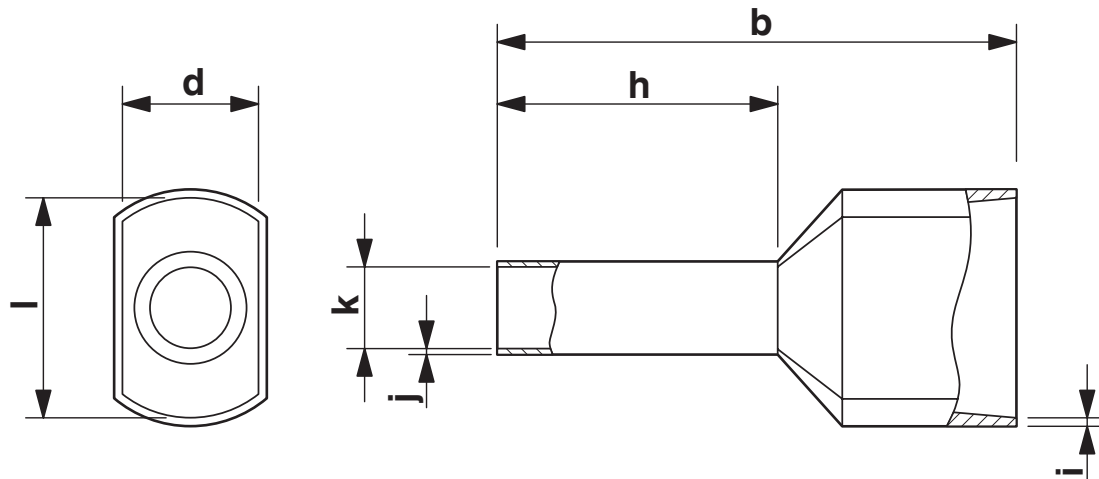

Length (b), sleeve length (h), insulating collar inner dimension (d), sleeve diameter (k), insulating collar thickness (i), sleeve wall thickness (j)

# AI-TWIN 2X16 -16 BU - Ferrule



3202847

<https://www.phoenixcontact.com/us/products/3202847>

## Classifications

### ECLASS

ECLASS-11.0	27400201
ECLASS-13.0	27400201
ECLASS-12.0	27400201

### ETIM

ETIM 9.0	EC000005
----------	----------

### UNSPSC

UNSPSC 21.0	27121700
-------------	----------

# AI-TWIN 2X16 -16 BU - Ferrule



3202847

<https://www.phoenixcontact.com/us/products/3202847>

## Environmental product compliance

EU RoHS	
Fulfills EU RoHS substance requirements	Yes, No exemptions
China RoHS	
Environment friendly use period (EFUP)	EFUP-E
	No hazardous substances above the limits
EU REACH SVHC	
REACH candidate substance (CAS No.)	No substance above 0.1 wt%

Phoenix Contact 2024 © - all rights reserved  
<https://www.phoenixcontact.com>

Phoenix Contact USA  
586 Fulling Mill Road  
Middletown, PA 17057, United States  
(+717) 944-1300  
[info@phoenixcon.com](mailto:info@phoenixcon.com)