



Overload relay 55...250 A for motor protection Size S10/S12, CLASS 5...30E Contactor mounting/stand-alone installation Main circuit: busbar connection Auxiliary circuit: Spring-type terminal Manual-Automatic-Reset Internal ground fault detection

product brand name	SIRIUS
product designation	solid-state overload relay
product type designation	3RB2

General technical data

size of overload relay	S10, S12
size of contactor can be combined company-specific	S10, S12
insulation voltage with degree of pollution 3 at AC rated value	1 000 V
surge voltage resistance rated value	8 kV
maximum permissible voltage for safe isolation in networks with grounded star point	
<ul style="list-style-type: none"> between auxiliary and auxiliary circuit between auxiliary and auxiliary circuit between main and auxiliary circuit between main and auxiliary circuit 	300 V 300 V 600 V 690 V
shock resistance	15g / 11 ms
<ul style="list-style-type: none"> according to IEC 60068-2-27 	15g / 11 ms; Signaling contact 97 / 98 in position "Tripped": 8g / 11 ms
vibration resistance	1-6 Hz, 15 mm; 6-500 Hz, 20 m/s ² ; 10 cycles
thermal current	250 A
type of protection according to ATEX directive 2014/34/EU	Ex II (2) G [Ex e] [Ex d] [Ex px] ; Ex II (2) D [Ex t] [Ex p]
certificate of suitability according to ATEX directive 2014/34/EU	PTB 06 ATEX 3001
reference code according to IEC 81346-2	F
Substance Prohibitance (Date)	07/01/2006

Ambient conditions

installation altitude at height above sea level maximum	2 000 m
ambient temperature	
<ul style="list-style-type: none"> during operation during storage during transport 	-25 ... +60 °C -40 ... +80 °C -40 ... +80 °C
temperature compensation	-25 ... +60 °C
relative humidity during operation	10 ... 95 %

Main circuit

number of poles for main current circuit	3
adjustable current response value current of the current-dependent overload release	55 ... 250 A
operating voltage	
<ul style="list-style-type: none"> rated value for remote-reset function at DC at AC-3e rated value maximum 	1 000 V 24 V 1 000 V
operating frequency rated value	50 ... 60 Hz

operational current rated value	250 A
operational current at AC-3e at 400 V rated value	250 A
operating power	
• for 3-phase motors at 400 V at 50 Hz	30 ... 132 kW
• for AC motors at 500 V at 50 Hz	45 ... 160 kW
• for AC motors at 690 V at 50 Hz	55 ... 250 kW
Auxiliary circuit	
design of the auxiliary switch	integrated
number of NC contacts for auxiliary contacts	1
• note	for contactor disconnection
number of NO contacts for auxiliary contacts	1
• note	for message "tripped"
number of CO contacts for auxiliary contacts	0
operational current of auxiliary contacts at AC-15	
• at 24 V	4 A
• at 110 V	4 A
• at 120 V	4 A
• at 125 V	4 A
• at 230 V	3 A
operational current of auxiliary contacts at DC-13	
• at 24 V	2 A
• at 60 V	0.55 A
• at 110 V	0.3 A
• at 125 V	0.3 A
• at 220 V	0.11 A
Protective and monitoring functions	
trip class	CLASS 5E, 10E, 20E and 30E adjustable
design of the overload release	electronic
response value current of the grounding protection minimum	0.75 x IMotor
response time of the grounding protection in settled state	1 000 ms
operating range of the grounding protection relating to current set value	
• minimum	IMotor > lower current setting value
• maximum	IMotor < upper current setting value x 3.5
UL/CSA ratings	
full-load current (FLA) for 3-phase AC motor	
• at 480 V rated value	250 A
• at 600 V rated value	250 A
contact rating of auxiliary contacts according to UL	B600 / R300
Short-circuit protection	
design of the fuse link	
• for short-circuit protection of the main circuit	
— with type of coordination 1 required	gG: 500 A, Class L: 700 A
— with type of assignment 2 required	gG: 500 A
• for short-circuit protection of the auxiliary switch required	fuse gG: 6 A
Installation/ mounting/ dimensions	
mounting position	any
fastening method	Contactor mounting/stand-alone installation
height	119 mm
width	120 mm
depth	155 mm
Connections/ Terminals	
product component removable terminal for auxiliary and control circuit	Yes
type of electrical connection	
• for main current circuit	busbar connection
• for auxiliary and control circuit	spring-loaded terminals
arrangement of electrical connectors for main current circuit	Top and bottom
type of connectable conductor cross-sections	

<ul style="list-style-type: none"> • for auxiliary contacts <ul style="list-style-type: none"> — solid — solid or stranded — finely stranded with core end processing — finely stranded without core end processing • at AWG cables for auxiliary contacts 	2x (0.25 ... 1.5 mm ²) 2x (0,25 ... 1,5 mm ²) 2x (0.25 ... 1.5 mm ²) 2x (0.25 ... 1.5 mm ²) 2x (24 ... 16)
tightening torque	
<ul style="list-style-type: none"> • for main contacts with screw-type terminals 	20 ... 22 N·m
design of the thread of the connection screw	
<ul style="list-style-type: none"> • for main contacts 	M10

Safety related data

protection class IP on the front according to IEC 60529	IP00; IP20 with box terminal/cover
touch protection on the front according to IEC 60529	finger-safe, for vertical contact from the front with box terminal/cover

Communication/ Protocol

type of voltage supply via input/output link master	No
--	----

Electromagnetic compatibility

conducted interference	
<ul style="list-style-type: none"> • due to burst according to IEC 61000-4-4 	2 kV (power ports), 1 kV (signal ports) corresponds to degree of severity 3
<ul style="list-style-type: none"> • due to conductor-earth surge according to IEC 61000-4-5 	2 kV (line to earth) corresponds to degree of severity 3
<ul style="list-style-type: none"> • due to conductor-conductor surge according to IEC 61000-4-5 	1 kV (line to line) corresponds to degree of severity 3
<ul style="list-style-type: none"> • due to high-frequency radiation according to IEC 61000-4-6 	10 V in frequency range 0.15 to 80 MHz, modulation 80 % AM with 1 kHz
field-based interference according to IEC 61000-4-3	10 V/m
electrostatic discharge according to IEC 61000-4-2	6 kV contact discharge / 8 kV air discharge

Display

display version for switching status	Slide switch
--------------------------------------	--------------

Certificates/ approvals

General Product Approval	EMC
---------------------------------	------------



[Confirmation](#)



For use in hazardous locations	Declaration of Conformity	Test Certificates	Marine / Shipping
---------------------------------------	----------------------------------	--------------------------	--------------------------



[Type Test Certificates/Test Report](#)

[Special Test Certificate](#)



Marine / Shipping	other
--------------------------	--------------



[Miscellaneous](#)

[Confirmation](#)

Further information

Information on the packaging

<https://support.industry.siemens.com/cs/ww/en/view/109813875>

Information- and Downloadcenter (Catalogs, Brochures,...)

<https://www.siemens.com/ic10>

Industry Mall (Online ordering system)

<https://mall.industry.siemens.com/mall/en/en/Catalog/product?mlfb=3RB2163-4GF2>

Cax online generator

<http://support.automation.siemens.com/WW/CAXorder/default.aspx?lang=en&mlfb=3RB2163-4GF2>

Service&Support (Manuals, Certificates, Characteristics, FAQs,...)

<https://support.industry.siemens.com/cs/ww/en/ps/3RB2163-4GF2>

Image database (product images, 2D dimension drawings, 3D models, device circuit diagrams, EPLAN macros, ...)

http://www.automation.siemens.com/bilddb/cax_de.aspx?mlfb=3RB2163-4GF2&lang=en

Characteristic: Tripping characteristics, I_t, Let-through current

<https://support.industry.siemens.com/cs/ww/en/ps/3RB2163-4GF2/char>

Further characteristics (e.g. electrical endurance, switching frequency)

<http://www.automation.siemens.com/bilddb/index.aspx?view=Search&mlfb=3RB2163-4GF2&objecttype=14&gridview=view1>

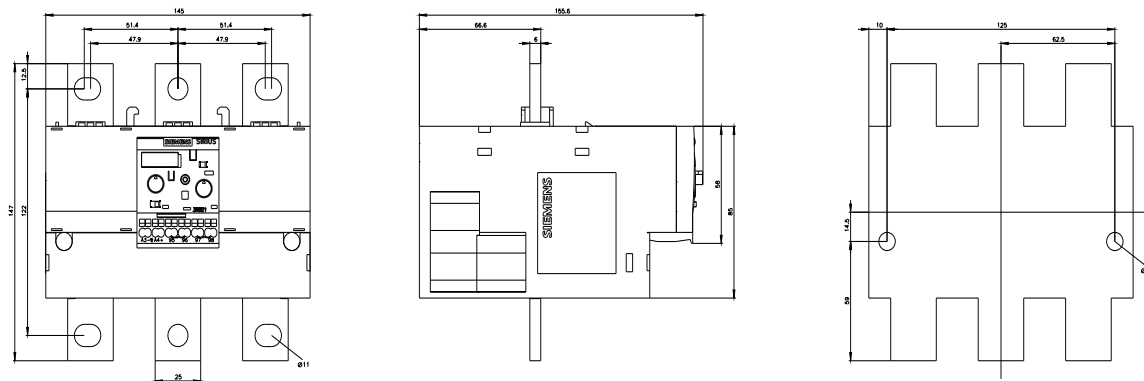

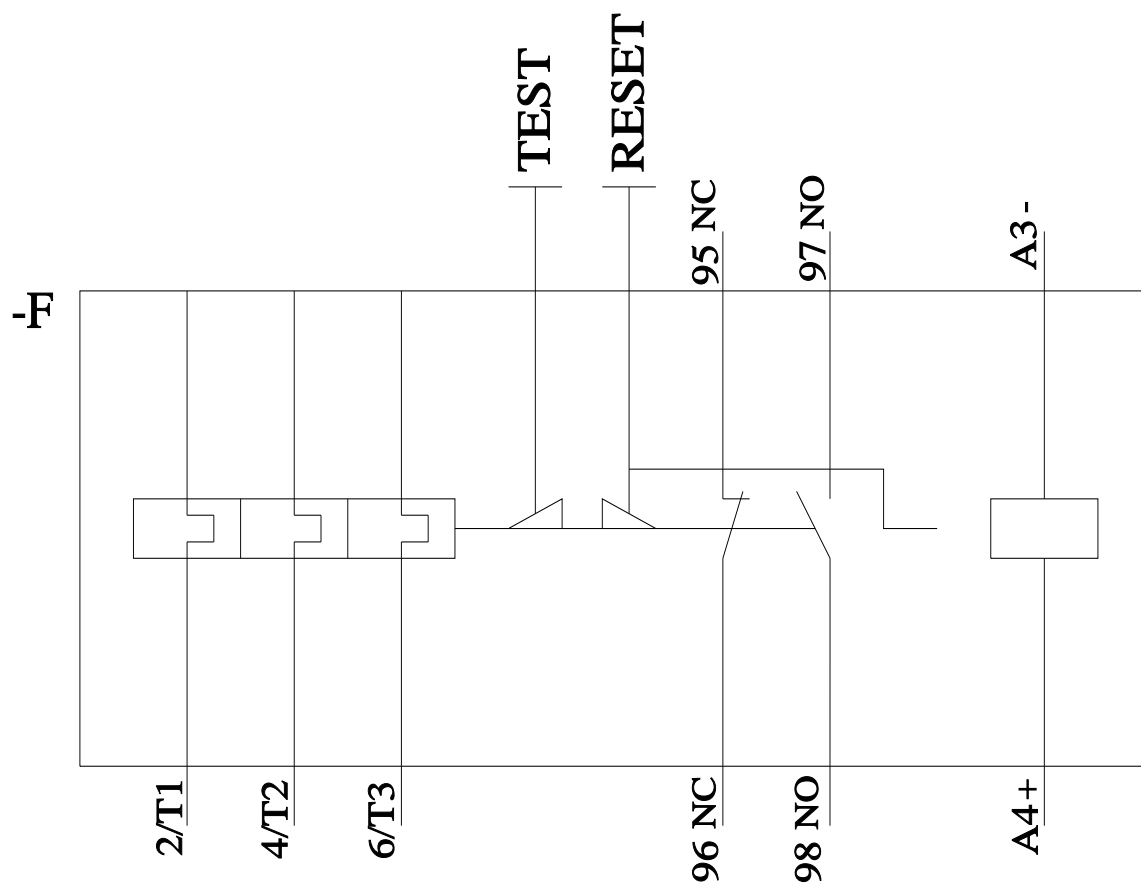

last modified:

2/9/2022 