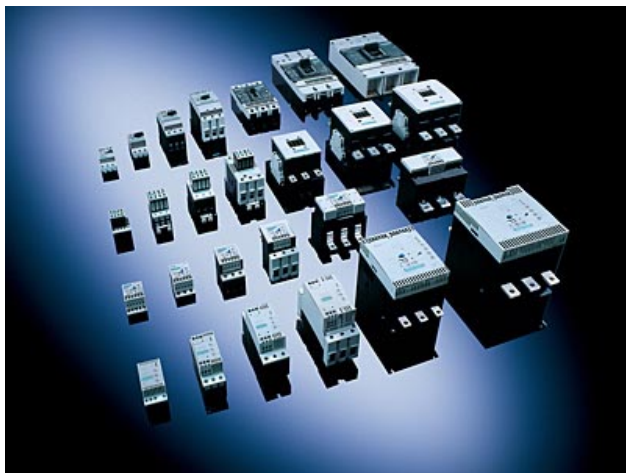

# SIEMENS

## Product data sheet

**3RT1024-1AP60**

CONTACTOR, AC-3 5,5 KW/400 V,  
AC 220V 50HZ/240V 60HZ, 3-POLE,  
SIZE S0, SCREW CONNECTION

### General details:

Size of the contactor	S0
Number of poles	3

### Control circuit:

Design of activation of the operating mechanism	conventional
---	--------------

Type of voltage	AC
-----------------	----

### Control supply voltage

• at 50 Hz / for AC / rated value / minimum	220 V
• at 50 Hz / for AC / rated value / maximum	220 V
• at 60 Hz / for AC / rated value / minimum	240 V
• at 60 Hz / for AC / rated value / maximum	240 V

### Supply voltage frequency / for auxiliary and control current circuit / rated value

• minimum	50 Hz
• maximum	60 Hz

### Main circuit:

Number of NC contacts / for main contacts	0
Number of NO contacts / for main contacts	3
Operating current	

• at AC-3 / at 400 V / rated value	12 A
• at AC-1 / at 400 V / rated value	40 A
Service power	
• at AC-3 / at 400 V / rated value	5.5 kW
• at AC-1 / at 400 V / rated value	23 kW
Auxiliary circuit:	
Number of NO contacts / for auxiliary contact	0
Number of NC contacts / for auxiliary contact	0
Connection type:	
Design of the electrical connection / for main current circuit	screw-type terminals
Design of the electrical connection / for auxiliary and control current circuit	screw-type terminals
Mounting/fixing:	
Type of fixing/fixation	screw and snap-on mounting onto 35 mm standard mounting rail according to DIN EN 50022
Series installation	Yes

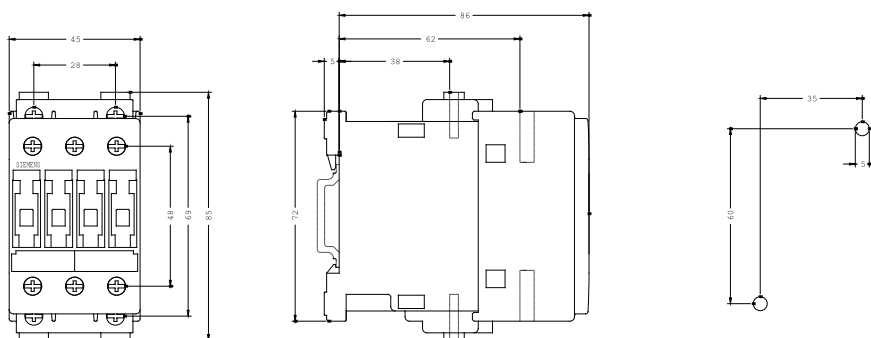

**last change:**

10/31/2006

<b>Technical Assistance:</b>	Telephone:	+49 (0) 911-895-5900 (8°° - 17°° CET)
	Fax:	+49 (0) 911-895-5907
	E-Mail:	technical-assistance@siemens.com
	Internet:	www.siemens.de/lowvoltage/technical-assistance