



SOLID-STATE TWO-WIRE TIME RELAY SETTING RANGE  
0.5 S...10 S,  
AC/DC 24...66 V, ON-DELAY,  
WITH VARISTOR FOR MOUNTING ONTO CONTACTORS  
SIZE S0...S3

General technical data:		
product brand name		SIRIUS
product designation		timing relay
Design of the product		slow-operating
type of voltage		AC
Size of the contactor / can be combined / company-specific		S0 ... S3
Product function		
• star-delta circuit		No
• at the relay outputs / changeover delayed/without delay		No
Product component / semi-conductor output		Yes
Product extension / optional / remote control		No
Product extension / strictly required / remote control		No
Adjustable time	s	0.5 ... 10
Ambient temperature		
• during operating	°C	-25 ... +60
Item designation		
• according to DIN 40719 extendable after IEC 204-2 / according to IEC 750		K
• according to DIN EN 61346-2		K

Switching Function:

<b>Switching function</b>		
• slow-operating		Yes
• making pulse contact		No
• firmly clocked beginning with pulse		No
• firmly clocked beginning with pause		No
• relapse delayed		No
• variably clocked start with impulse		No
• impuls variably clocked start with pause		No
• with auxiliary voltage		
• in an additive way slow-operating		No
• temporary line fault		No
• relapse delayed		No
• without auxiliary voltage / relapse delayed		No

#### Auxiliary circuit:

##### Supply voltage frequency / for auxiliary and control current circuit

- rated value

Hz

50 ... 60

##### Supply voltage / strictly required / auxiliary voltage

No

##### Control supply voltage

- at 50 Hz / at AC
  - rated value
- at 60 Hz / at AC
  - rated value

V

24 ... 66

V

24 ... 66

#### Installation/mounting/dimensions:

<b>Width</b>	mm	45
<b>Height</b>	mm	26
<b>Depth</b>	mm	50

#### Connections:

##### Design of the electrical connection

- jumper socket
- for auxiliary and control current circuit

No

screw-type terminals

#### Certificates/approvals:

General Product Approval	EMC	Functional Safety / Safety of Machinery
--------------------------	-----	---



CCC



CSA



GOST



UL



C-TICK

[Type Examination](#)

Declaration of Conformity

Test Certificates



EG-Konf.

[Special Test Certificate](#)

Shipping Approval



ABS



BUREAU  
VERITAS



DNV



GL



LRS



PRS

Shipping Approval

other



RINA



RMRS

[Confirmation](#)

[Declaration of Conformity](#)

[other](#)

[Environmental Confirmations](#)

Further information:

Information- and Downloadcenter (Catalogs, Brochures,...)

<http://www.siemens.com/industrial-controls/catalogs>

Industry Mall (Online ordering system)

<http://www.siemens.com/industrial-controls/mall>

CAX-Online-Generator

<http://www.siemens.com/cax>

Service&Support (Manuals, Certificates, Characteristics, FAQs,...)

<http://support.automation.siemens.com/WW/view/en/3RT1926-2CG21/all>

Image database (product images, 2D dimension drawings, 3D models, device circuit diagrams, ...)

[http://www.automation.siemens.com/bilddb/cax\\_en.aspx?mlfb=3RT1926-2CG21](http://www.automation.siemens.com/bilddb/cax_en.aspx?mlfb=3RT1926-2CG21)

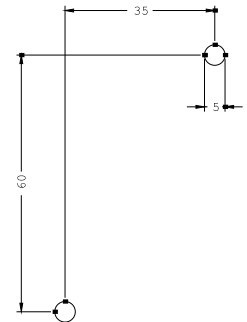
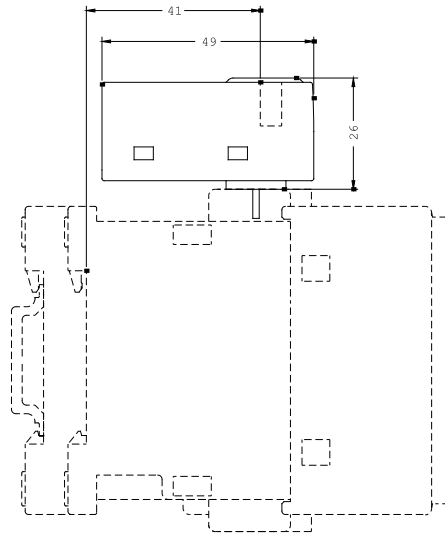
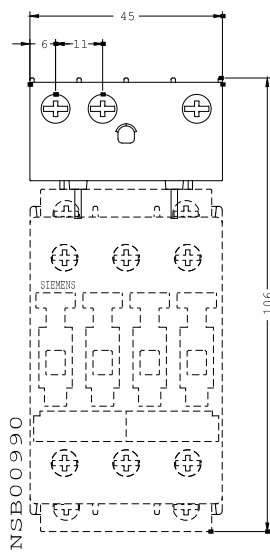

last change:

Feb 18, 2013