



SOLID-STATE TWO-WIRE TIME RELAY SETTING RANGE
0.05 S...1 NO,
AC/DC 90...240 V, OFF-DELAY,
W. VARISTOR WITH SCREW CONNECTION,
FOR CONTACTORS SIZE S0...S3

General technical data:

product brand name		SIRIUS
product designation		timing relay
Design of the product		off-delayed with auxiliary voltage
type of voltage		AC
Size of the contactor / can be combined / company-specific		S0 ... S3
Product function		
• star-delta circuit		No
• at the relay outputs / changeover delayed/without delay		No
Product component / semi-conductor output		Yes
Product extension / optional / remote control		No
Product extension / strictly required / remote control		No
Adjustable time	s	0.05 ... 1
Ambient temperature		
• during operating	°C	-25 ... +60
Item designation		
• according to DIN 40719 extendable after IEC 204-2 / according to IEC 750		K
• according to DIN EN 61346-2		K

Switching Function:

Switching function		
• slow-operating		No
• making pulse contact		No
• firmly clocked beginning with pulse		No
• firmly clocked beginning with pause		No
• relapse delayed		Yes
• variably clocked start with impulse		No
• impuls variably clocked start with pause		No
• with auxiliary voltage		
• in an additive way slow-operating		No
• temporary line fault		No
• relapse delayed		Yes
• without auxiliary voltage / relapse delayed		No

Auxiliary circuit:

Supply voltage frequency / for auxiliary and control current circuit

- rated value

Hz

50 ... 60

Supply voltage / strictly required / auxiliary voltage

Yes

Control supply voltage

- at 50 Hz / at AC
 - rated value
- at 60 Hz / at AC
 - rated value

V

90 ... 240

V

90 ... 240

Installation/mounting/dimensions:

Width	mm	45
Height	mm	26
Depth	mm	50

Connections:

Design of the electrical connection

- jumper socket
- for auxiliary and control current circuit

No

screw-type terminals

Certificates/approvals:

General Product Approval	EMC	Functional Safety / Safety of Machinery
--------------------------	-----	---



CCC



CSA



GOST



UL



C-TICK

[Type Examination](#)

Declaration of Conformity

Test Certificates



EG-Konf.

[Special Test Certificate](#)

Shipping Approval



ABS



BUREAU
VERITAS



DNV



GL



LRS



PRS

Shipping Approval

other



RINA



RMRS

[Confirmation](#)

[Declaration of Conformity](#)

[other](#)

[Environmental Confirmations](#)

Further information:

Information- and Downloadcenter (Catalogs, Brochures,...)

<http://www.siemens.com/industrial-controls/catalogs>

Industry Mall (Online ordering system)

<http://www.siemens.com/industrial-controls/mall>

CAX-Online-Generator

<http://www.siemens.com/cax>

Service&Support (Manuals, Certificates, Characteristics, FAQs,...)

<http://support.automation.siemens.com/WW/view/en/3RT1926-2DH11/all>

Image database (product images, 2D dimension drawings, 3D models, device circuit diagrams, ...)

http://www.automation.siemens.com/bilddb/cax_en.aspx?mlfb=3RT1926-2DH11

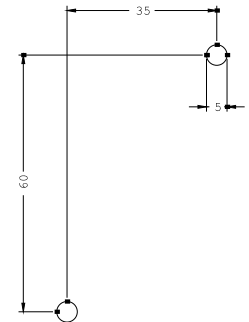
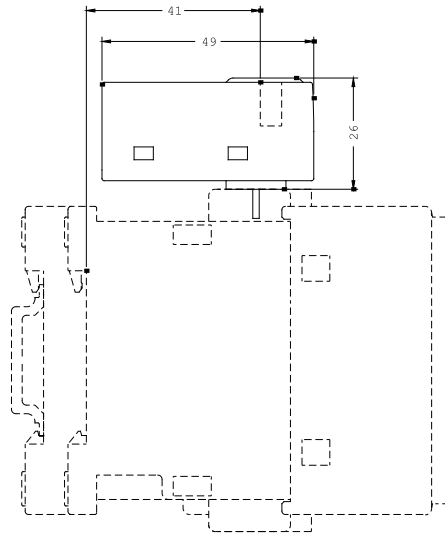
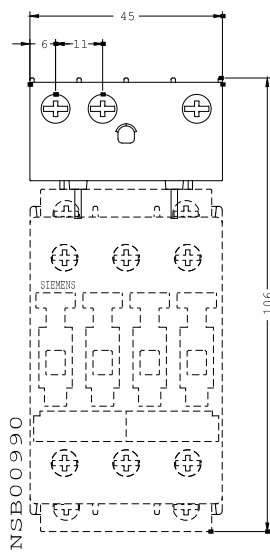

last change:

Feb 18, 2013