

UNDervOLTAGE RELEASE, AC 208V, 60HZ,
W. SCREW CONNECTION;
FOR CIRCUIT-BREAKERS, SZ S00/S0

General technical data:

Product brand name		SIRIUS
Product designation		undervoltage release
Size of the circuit-breaker		S00, S0
Acceptability for application		motor circuit breaker
Protection class IP / frontal/front side		IP20
Design of the short-circuit protection		fuse
Degree of pollution		3
Insulation voltage / rated value	V	690
Insulation voltage / with degree of pollution 3 / rated value	V	690
Ambient temperature		
• during storage	°C	-50 ... 80
• during the operating phase	°C	-20 ... 60
Item designation		
• according to DIN 40719 extendable after IEC 204-2 / according to IEC 750		F
• according to DIN EN 61346-2		F

Auxiliary circuit:

Number of NC contacts / for auxiliary contacts		
• instantaneous switching		0
Number of NO contacts / for auxiliary contacts		
• instantaneous switching		0
Number of changeover contacts / of the auxiliary contacts		
• non-delayed		0

Control circuit:

Type of voltage / of the controlled supply voltage		AC
control supply voltage frequency		
• 1 / rated value	Hz	60
Control supply voltage		
• 1 / at 60 Hz / for AC / rated value	V	208

Installation/mounting/dimensions:

Type of fixing/fixation		snap-on mounting
Width	mm	18.5
Height	mm	90
Depth	mm	68

Certificates/approvals:

verification of suitability		CE / UL / CSA / CCC
------------------------------------	--	---------------------

Further information:**Information- and Downloadcenter (Catalogs, Brochures,...)**

<http://www.siemens.com/industrial-controls/catalogs>

Global Industry Mall (Online ordering system)

<http://www.siemens.com/industrial-controls/mall>

Service&Support (Manuals, Certificates, Characteristics, FAQs,...)

<http://support.automation.siemens.com/WW/view/en/3RV2902-1AM1/all>

Image database (product images, 2D dimension drawings, 3D models, device circuit diagrams, ...)

http://www.automation.siemens.com/bilddb/cax_en.aspx?mlfb=3RV2902-1AM1

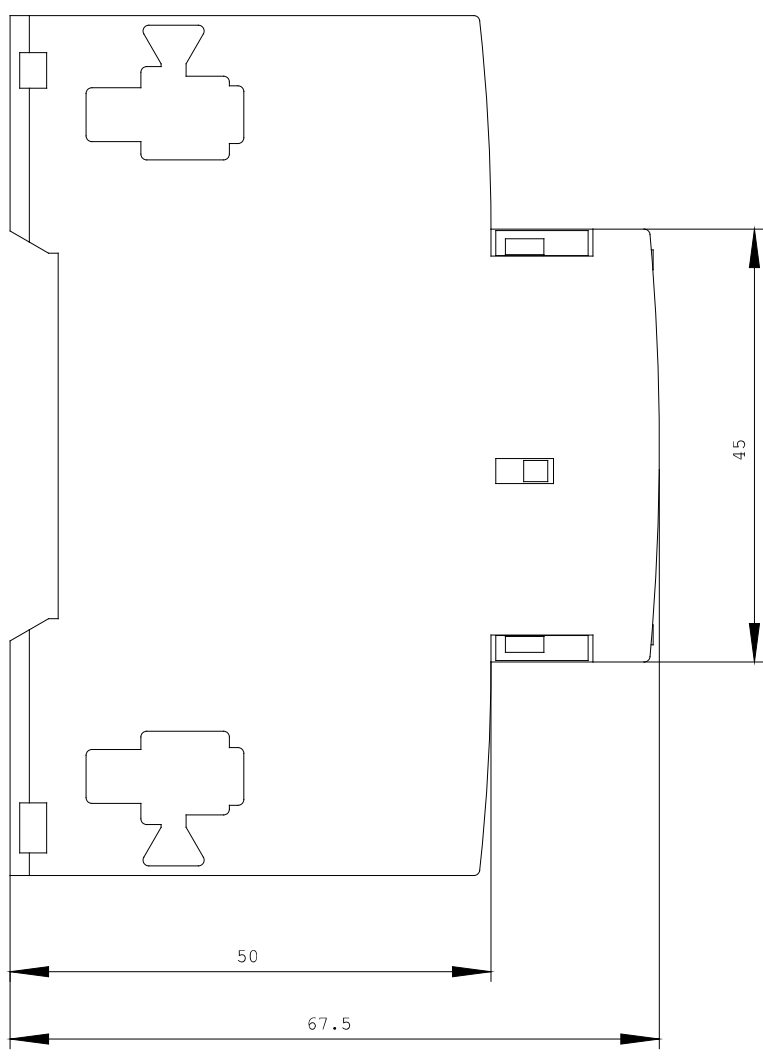
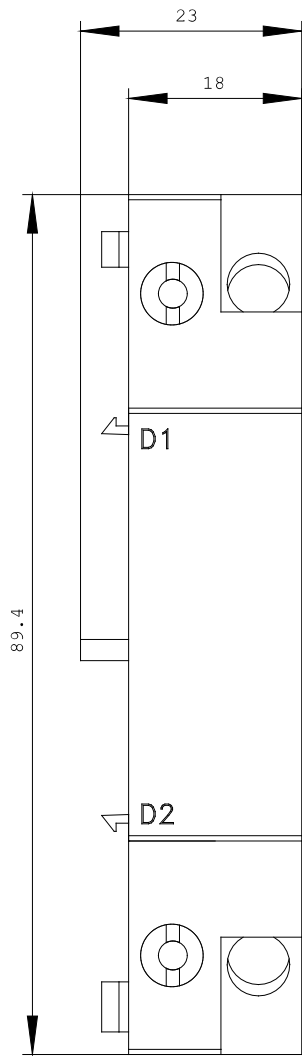

last change:

Apr 26, 2010