



SIRIUS soft starter 200-600 V 77 A, 110-250 V AC spring-type terminals
Analog output

product brand name

product category

product designation

product type designation

manufacturer's article number

- of standard HMI module usable
- of high feature HMI module usable
- of communication module PROFINET standard usable
- of communication module PROFIBUS usable
- of communication module Modbus TCP usable
- of communication module Modbus RTU usable
- of communication module Ethernet/IP
- of circuit breaker usable at 400 V
- of circuit breaker usable at 500 V
- of circuit breaker usable at 400 V at inside-delta circuit
- of circuit breaker usable at 500 V at inside-delta circuit
- of the gG fuse usable up to 690 V
- of the gG fuse usable at inside-delta circuit up to 500 V
- of full range R fuse link for semiconductor protection usable up to 690 V
- of back-up R fuse link for semiconductor protection usable up to 690 V

SIRIUS

Hybrid switching devices

Soft starter

3RW52

[3RW5980-0HS00](#)

[3RW5980-0HF00](#)

[3RW5980-0CS00](#)

[3RW5980-0CP00](#)

[3RW5980-0CT00](#)

[3RW5980-0CR00](#)

[3RW5980-0CE00](#)

[3VA2110-7MN32-0AA0](#); Type of coordination 1, I_q = 65 kA, CLASS 10

[3VA2110-7MN32-0AA0](#); Type of coordination 1, I_q = 20 kA, CLASS 10

[3VA2216-7MN32-0AA0](#); Type of coordination 1, I_q = 65 kA, CLASS 10

[3VA2216-7MN32-0AA0](#); Type of coordination 1, I_q = 20 kA, CLASS 10

[3NA3132-6](#); Type of coordination 1, I_q = 65 kA

[3NA3132-6](#); Type of coordination 1, I_q = 65 kA

[3NE1224-0](#); Type of coordination 2, I_q = 65 kA

[3NE8024-1](#); Type of coordination 2, I_q = 65 kA

General technical data

starting voltage [%]

30 ... 100 %

stopping voltage [%]

50 %; non-adjustable

start-up ramp time of soft starter

0 ... 20 s

current limiting value [%] adjustable

130 ... 700 %

certificate of suitability

- CE marking
- UL approval
- CSA approval

Yes

Yes

Yes

product component

- HMI-High Feature
- is supported HMI-Standard
- is supported HMI-High Feature

No

Yes

Yes

product feature integrated bypass contact system

Yes

number of controlled phases

3

trip class

CLASS 10A (default) / 10E / 20E; acc. to IEC 60947-4-2

buffering time in the event of power failure

<ul style="list-style-type: none"> • for main current circuit • for control circuit 	100 ms
insulation voltage rated value	100 ms
degree of pollution	600 V
impulse voltage rated value	3, acc. to IEC 60947-4-2
blocking voltage of the thyristor maximum	6 kV
service factor	1 800 V
surge voltage resistance rated value	1
maximum permissible voltage for safe isolation	6 kV
<ul style="list-style-type: none"> • between main and auxiliary circuit 	600 V
shock resistance	15 g / 11 ms, from 12 g / 11 ms with potential contact lifting
vibration resistance	15 mm to 6 Hz; 2g to 500 Hz
utilization category according to IEC 60947-4-2	AC 53a
reference code according to IEC 81346-2	Q
Substance Prohibitance (Date)	02/15/2018
product function	
<ul style="list-style-type: none"> • ramp-up (soft starting) 	Yes
<ul style="list-style-type: none"> • ramp-down (soft stop) 	Yes
<ul style="list-style-type: none"> • Soft Torque 	Yes
<ul style="list-style-type: none"> • adjustable current limitation 	Yes
<ul style="list-style-type: none"> • pump ramp down 	Yes
<ul style="list-style-type: none"> • intrinsic device protection 	Yes
<ul style="list-style-type: none"> • motor overload protection 	Yes; Electronic motor overload protection
<ul style="list-style-type: none"> • evaluation of thermistor motor protection 	No
<ul style="list-style-type: none"> • inside-delta circuit 	Yes
<ul style="list-style-type: none"> • auto-RESET 	Yes
<ul style="list-style-type: none"> • manual RESET 	Yes
<ul style="list-style-type: none"> • remote reset 	Yes; By turning off the control supply voltage
<ul style="list-style-type: none"> • communication function 	Yes
<ul style="list-style-type: none"> • operating measured value display 	Yes; Only in conjunction with special accessories
<ul style="list-style-type: none"> • error logbook 	Yes; Only in conjunction with special accessories
<ul style="list-style-type: none"> • via software parameterizable 	No
<ul style="list-style-type: none"> • via software configurable 	Yes
<ul style="list-style-type: none"> • PROFenergy 	Yes; in connection with the PROFINET Standard communication module
<ul style="list-style-type: none"> • firmware update 	Yes
<ul style="list-style-type: none"> • removable terminal for control circuit 	Yes
<ul style="list-style-type: none"> • torque control 	No
<ul style="list-style-type: none"> • analog output 	Yes; 4 ... 20 mA (default) / 0 ... 10 V (parameterizable with High Feature HMI)

Power Electronics

operational current	
<ul style="list-style-type: none"> • at 40 °C rated value 	77 A
<ul style="list-style-type: none"> • at 50 °C rated value 	68 A
<ul style="list-style-type: none"> • at 60 °C rated value 	62 A
operational current at inside-delta circuit	
<ul style="list-style-type: none"> • at 40 °C rated value 	133 A
<ul style="list-style-type: none"> • at 50 °C rated value 	118 A
<ul style="list-style-type: none"> • at 60 °C rated value 	107 A
operating voltage	
<ul style="list-style-type: none"> • rated value 	200 ... 600 V
<ul style="list-style-type: none"> • at inside-delta circuit rated value 	200 ... 600 V
relative negative tolerance of the operating voltage	-15 %
relative positive tolerance of the operating voltage	10 %
relative negative tolerance of the operating voltage at inside-delta circuit	-15 %
relative positive tolerance of the operating voltage at inside-delta circuit	10 %
operating power for 3-phase motors	
<ul style="list-style-type: none"> • at 230 V at 40 °C rated value 	22 kW
<ul style="list-style-type: none"> • at 230 V at inside-delta circuit at 40 °C rated value 	37 kW
<ul style="list-style-type: none"> • at 400 V at 40 °C rated value 	37 kW
<ul style="list-style-type: none"> • at 400 V at inside-delta circuit at 40 °C rated value 	75 kW
<ul style="list-style-type: none"> • at 500 V at 40 °C rated value 	45 kW

• at 500 V at inside-delta circuit at 40 °C rated value	90 kW
Operating frequency 1 rated value	50 Hz
Operating frequency 2 rated value	60 Hz
relative negative tolerance of the operating frequency	-10 %
relative positive tolerance of the operating frequency	10 %
adjustable motor current	
• at rotary coding switch on switch position 1	32 A
• at rotary coding switch on switch position 2	35 A
• at rotary coding switch on switch position 3	38 A
• at rotary coding switch on switch position 4	41 A
• at rotary coding switch on switch position 5	44 A
• at rotary coding switch on switch position 6	47 A
• at rotary coding switch on switch position 7	50 A
• at rotary coding switch on switch position 8	53 A
• at rotary coding switch on switch position 9	56 A
• at rotary coding switch on switch position 10	59 A
• at rotary coding switch on switch position 11	62 A
• at rotary coding switch on switch position 12	65 A
• at rotary coding switch on switch position 13	68 A
• at rotary coding switch on switch position 14	71 A
• at rotary coding switch on switch position 15	74 A
• at rotary coding switch on switch position 16	77 A
• minimum	32 A
adjustable motor current	
• for inside-delta circuit at rotary coding switch on switch position 1	55.4 A
• for inside-delta circuit at rotary coding switch on switch position 2	60.6 A
• for inside-delta circuit at rotary coding switch on switch position 3	65.8 A
• for inside-delta circuit at rotary coding switch on switch position 4	71 A
• for inside-delta circuit at rotary coding switch on switch position 5	76.2 A
• for inside-delta circuit at rotary coding switch on switch position 6	81.4 A
• for inside-delta circuit at rotary coding switch on switch position 7	86.6 A
• for inside-delta circuit at rotary coding switch on switch position 8	91.8 A
• for inside-delta circuit at rotary coding switch on switch position 9	97 A
• for inside-delta circuit at rotary coding switch on switch position 10	102 A
• for inside-delta circuit at rotary coding switch on switch position 11	107 A
• for inside-delta circuit at rotary coding switch on switch position 12	113 A
• for inside-delta circuit at rotary coding switch on switch position 13	118 A
• for inside-delta circuit at rotary coding switch on switch position 14	123 A
• for inside-delta circuit at rotary coding switch on switch position 15	128 A
• for inside-delta circuit at rotary coding switch on switch position 16	133 A
• at inside-delta circuit minimum	55.4 A
minimum load [%]	15 %; Relative to smallest settable I _e
power loss [W] for rated value of the current at AC	
• at 40 °C after startup	35 W
• at 50 °C after startup	32 W
• at 60 °C after startup	31 W
power loss [W] at AC at current limitation 350 %	
• at 40 °C during startup	1 107 W
• at 50 °C during startup	933 W
• at 60 °C during startup	826 W

type of voltage of the control supply voltage	AC
control supply voltage at AC	
• at 50 Hz	110 ... 250 V
• at 60 Hz	110 ... 250 V
relative negative tolerance of the control supply voltage at AC at 50 Hz	-15 %
relative positive tolerance of the control supply voltage at AC at 50 Hz	10 %
relative negative tolerance of the control supply voltage at AC at 60 Hz	-15 %
relative positive tolerance of the control supply voltage at AC at 60 Hz	10 %
control supply voltage frequency	50 ... 60 Hz
relative negative tolerance of the control supply voltage frequency	-10 %
relative positive tolerance of the control supply voltage frequency	10 %
control supply current in standby mode rated value	30 mA
holding current in bypass operation rated value	75 mA
inrush current peak at application of control supply voltage maximum	12.2 A
duration of inrush current peak at application of control supply voltage	2.2 ms
design of the overvoltage protection	Varistor
design of short-circuit protection for control circuit	4 A gG fuse (Icu=1 kA), 6 A quick-acting fuse (Icu=1 kA), C1 miniature circuit breaker (Icu= 600 A), C6 miniature circuit breaker (Icu= 300 A); Is not part of scope of supply

Inputs/ Outputs

number of digital inputs	1
number of digital outputs	3
• not parameterizable	2
digital output version	2 normally-open contacts (NO) / 1 changeover contact (CO)
number of analog outputs	1
switching capacity current of the relay outputs	
• at AC-15 at 250 V rated value	3 A
• at DC-13 at 24 V rated value	1 A

Installation/ mounting/ dimensions

mounting position	with vertical mounting surface +/-90° rotatable, with vertical mounting surface +/- 22.5° tiltable to the front and back
fastening method	screw fixing
height	306 mm
width	185 mm
depth	203 mm
required spacing with side-by-side mounting	
• forwards	10 mm
• backwards	0 mm
• upwards	100 mm
• downwards	75 mm
• at the side	5 mm
weight without packaging	5.6 kg

Connections/ Terminals

type of electrical connection	
• for main current circuit	box terminal
• for control circuit	spring-loaded terminals
width of connection bar maximum	25 mm
type of connectable conductor cross-sections	
• for main contacts for box terminal using the front clamping point solid	1x (2.5 ... 16 mm²)
• for main contacts for box terminal using the front clamping point finely stranded with core end processing	1x (2.5 ... 50 mm²)
• for main contacts for box terminal using the front clamping point stranded	1x (10 ... 70 mm²)
• at AWG cables for main contacts for box terminal using the front clamping point	1x (10 ... 2/0)
• for main contacts for box terminal using the back	1x (2.5 ... 16 mm²)

<p>clamping point solid</p> <ul style="list-style-type: none"> • at AWG cables for main contacts for box terminal using the back clamping point • for main contacts for box terminal using both clamping points solid • for main contacts for box terminal using both clamping points finely stranded with core end processing • for main contacts for box terminal using both clamping points stranded • for main contacts for box terminal using the back clamping point finely stranded with core end processing • for main contacts for box terminal using the back clamping point stranded <p>type of connectable conductor cross-sections</p> <ul style="list-style-type: none"> • for control circuit solid • for control circuit finely stranded with core end processing • at AWG cables for control circuit solid • at AWG cables for control circuit finely stranded with core end processing <p>wire length</p> <ul style="list-style-type: none"> • between soft starter and motor maximum • at the digital inputs at AC maximum <p>tightening torque</p> <ul style="list-style-type: none"> • for main contacts with screw-type terminals • for auxiliary and control contacts with screw-type terminals <p>tightening torque [lbf·in]</p> <ul style="list-style-type: none"> • for main contacts with screw-type terminals • for auxiliary and control contacts with screw-type terminals 	<p>1x (10 ... 2/0)</p> <p>2x (2.5 ... 16 mm²)</p> <p>2x (2.5 ... 35 mm²)</p> <p>2x (6 ... 16 mm²), 2x (10 ... 50 mm²)</p> <p>1x (2.5 ... 50 mm²)</p> <p>1x (10 ... 70 mm²)</p> <p>2x (0.25 ... 1.5 mm²)</p> <p>2x (0.25 ... 1.5 mm²)</p> <p>2x (24 ... 16)</p> <p>2x (24 ... 16)</p> <p>800 m</p> <p>100 m</p> <p>4.5 ... 6 N·m</p> <p>0.8 ... 1.2 N·m</p> <p>40 ... 53 lbf·in</p> <p>7 ... 10.3 lbf·in</p>
Ambient conditions	
<p>installation altitude at height above sea level maximum</p> <p>ambient temperature</p> <ul style="list-style-type: none"> • during operation • during storage and transport <p>environmental category</p> <ul style="list-style-type: none"> • during operation according to IEC 60721 • during storage according to IEC 60721 • during transport according to IEC 60721 <p>EMC emitted interference</p>	<p>5 000 m; Derating as of 1000 m, see catalog</p> <p>-25 ... +60 °C; Please observe derating at temperatures of 40 °C or above</p> <p>-40 ... +80 °C</p> <p>3K6 (no ice formation, only occasional condensation), 3C3 (no salt mist), 3S2 (sand must not get into the devices), 3M6</p> <p>1K6 (only occasional condensation), 1C2 (no salt mist), 1S2 (sand must not get inside the devices), 1M4</p> <p>2K2, 2C1, 2S1, 2M2 (max. fall height 0.3 m)</p> <p>acc. to IEC 60947-4-2: Class A</p>
Communication/ Protocol	
<p>communication module is supported</p> <ul style="list-style-type: none"> • PROFINET standard • EtherNet/IP • Modbus RTU • Modbus TCP • PROFIBUS 	<p>Yes</p> <p>Yes</p> <p>Yes</p> <p>Yes</p> <p>Yes</p>
UL/CSA ratings	
<p>manufacturer's article number</p> <ul style="list-style-type: none"> • of circuit breaker <ul style="list-style-type: none"> — usable for Standard Faults at 460/480 V according to UL — usable for High Faults at 460/480 V according to UL — usable for Standard Faults at 460/480 V at inside-delta circuit according to UL — usable for High Faults at 460/480 V at inside-delta circuit according to UL — usable for Standard Faults at 575/600 V according to UL — usable for Standard Faults at 575/600 V at 	<p>Siemens type: 3VA51, max. 125 A; I_q = 10 kA</p> <p>Siemens type: 3VA51, max. 125 A; I_q max = 65 kA</p> <p>Siemens type: 3VA51, max. 125 A; I_q = 10 kA</p> <p>Siemens type: 3VA51, max. 125 A; I_q max = 65 kA</p> <p>Siemens type: 3VA51, max. 125 A; I_q = 10 kA</p> <p>Siemens type: 3VA51, max. 125 A; I_q = 10 kA</p>

inside-delta circuit according to UL

• of the fuse

— usable for Standard Faults up to 575/600 V according to UL

— usable for High Faults up to 575/600 V according to UL

— usable for Standard Faults at inside-delta circuit up to 575/600 V according to UL

— usable for High Faults at inside-delta circuit up to 575/600 V according to UL

operating power [hp] for 3-phase motors

• at 200/208 V at 50 °C rated value

• at 220/230 V at 50 °C rated value

• at 460/480 V at 50 °C rated value

• at 575/600 V at 50 °C rated value

• at 200/208 V at inside-delta circuit at 50 °C rated value

• at 220/230 V at inside-delta circuit at 50 °C rated value

• at 460/480 V at inside-delta circuit at 50 °C rated value

• at 575/600 V at inside-delta circuit at 50 °C rated value

contact rating of auxiliary contacts according to UL

Type: Class RK5 / K5, max. 250 A; I_q = 10 kA

Type: Class J / L, max. 250 A; I_q = 100 kA

Type: Class RK5 / K5, max. 250 A; I_q = 10 kA

Type: Class J / L, max. 250 A; I_q = 100 kA

20 hp

25 hp

50 hp

60 hp

30 hp

40 hp

75 hp

100 hp

R300-B300

Safety related data

protection class IP on the front according to IEC 60529

IP00; IP20 with cover

touch protection on the front according to IEC 60529
electromagnetic compatibility

finger-safe, for vertical contact from the front with cover
in accordance with IEC 60947-4-2

Certificates/ approvals

General Product Approval

EMC



[Confirmation](#)



Declaration of Conformity

Test Certificates

Marine / Shipping



EG-Konf.

[Type Test Certificates/Test Report](#)



LRS

Marine / Shipping

other



[Confirmation](#)

Further information

Information- and Downloadcenter (Catalogs, Brochures,...)

<https://www.siemens.com/ic10>

Industry Mall (Online ordering system)

<https://mall.industry.siemens.com/mall/en/en/Catalog/product?mlfb=3RW5226-3AC15>

Cax online generator

<http://support.automation.siemens.com/WW/CAXorder/default.aspx?lang=en&mlfb=3RW5226-3AC15>

Service&Support (Manuals, Certificates, Characteristics, FAQs,...)

<https://support.industry.siemens.com/cs/ww/en/ps/3RW5226-3AC15>

Image database (product images, 2D dimension drawings, 3D models, device circuit diagrams, EPLAN macros, ...)

http://www.automation.siemens.com/bilddb/cax_de.aspx?mlfb=3RW5226-3AC15&lang=en

Characteristic: Tripping characteristics, I²t, Let-through current
<https://support.industry.siemens.com/cs/ww/en/ps/3RW5226-3AC15/char>

Characteristic: Installation altitude
<http://www.automation.siemens.com/bilddb/index.aspx?view=Search&mlfb=3RW5226-3AC15&objecttype=14&gridview=view1>

Simulation Tool for Soft Starters (STS)
<https://support.industry.siemens.com/cs/ww/en/view/101494917>

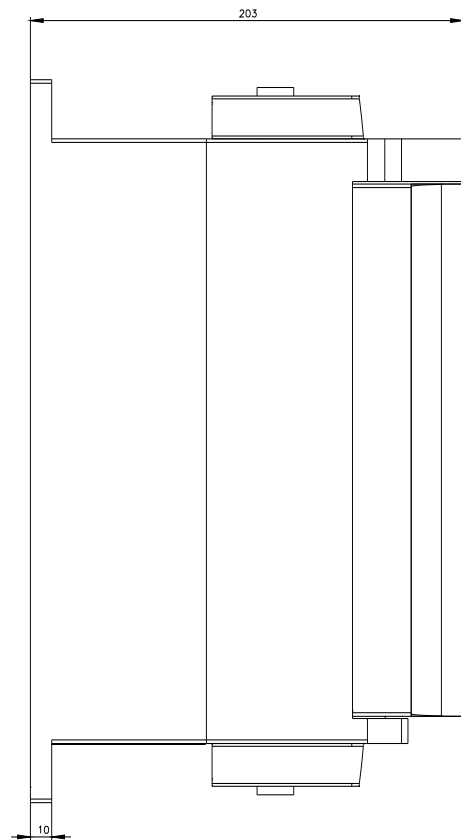
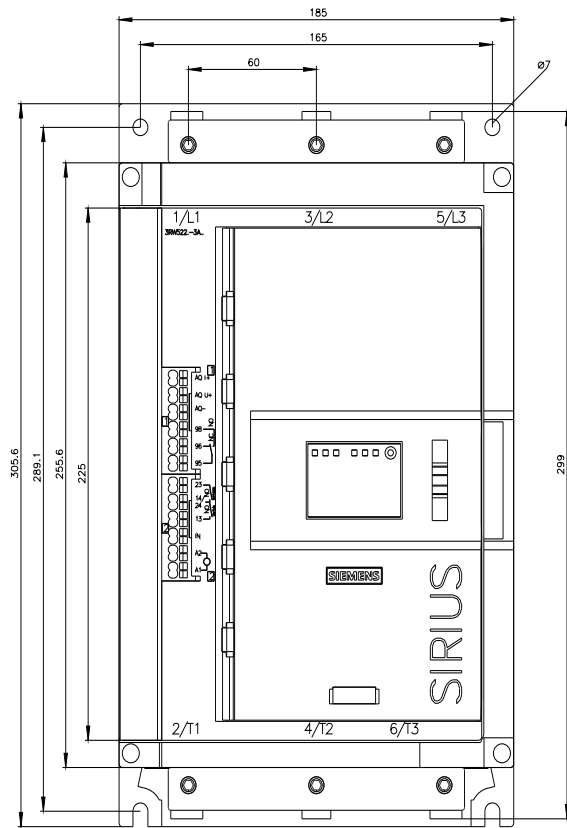

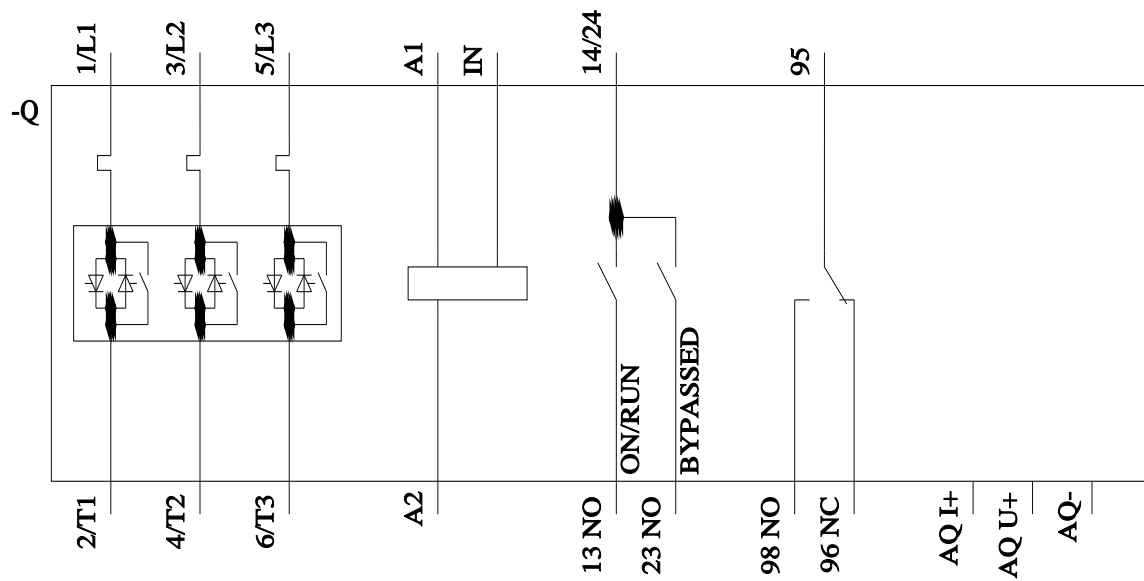

last modified:

4/10/2022

