



SIRIUS soft starter 200-480 V 470 A, 24 V AC/DC spring-type terminals  
Thermistor input

**product brand name**

**product category**

**product designation**

**product type designation**

**manufacturer's article number**

- of standard HMI module usable
- of high feature HMI module usable
- of communication module PROFINET standard usable
- of communication module PROFIBUS usable
- of communication module Modbus TCP usable
- of communication module Modbus RTU usable
- of communication module Ethernet/IP
- of circuit breaker usable at 400 V
- of circuit breaker usable at 500 V
- of circuit breaker usable at 400 V at inside-delta circuit
- of circuit breaker usable at 500 V at inside-delta circuit
- of the gG fuse usable up to 690 V
- of the gG fuse usable at inside-delta circuit up to 500 V
- of full range R fuse link for semiconductor protection usable up to 690 V
- of back-up R fuse link for semiconductor protection usable up to 690 V

SIRIUS

Hybrid switching devices

Soft starter

3RW52

[3RW5980-0HS00](#)

[3RW5980-0HF00](#)

[3RW5980-0CS00](#)

[3RW5980-0CP00](#)

[3RW5980-0CT00](#)

[3RW5980-0CR00](#)

[3RW5980-0CE00](#)

[3VA2450-7MN32-0AA0](#); Type of coordination 1, I<sub>q</sub> = 65 kA, CLASS 10

[3VA2450-7MN32-0AA0](#); Type of coordination 1, I<sub>q</sub> = 65 kA, CLASS 10

[3VA2510-6HN32-0AA0](#); Type of coordination 1, I<sub>q</sub> = 65 kA, CLASS 10

[3VA2510-6HN32-0AA0](#); Type of coordination 1, I<sub>q</sub> = 65 kA, CLASS 10

2x3NA3365-6; Type of coordination 1, I<sub>q</sub> = 65 kA

2x3NA3365-6; Type of coordination 1, I<sub>q</sub> = 65 kA

[3NE1436-2](#); Type of coordination 2, I<sub>q</sub> = 65 kA

[3NE3340-8](#); Type of coordination 2, I<sub>q</sub> = 65 kA

**General technical data**

**starting voltage [%]**

30 ... 100 %

**stopping voltage [%]**

50 %; non-adjustable

**start-up ramp time of soft starter**

0 ... 20 s

**current limiting value [%] adjustable**

130 ... 700 %

**certificate of suitability**

- CE marking
- UL approval
- CSA approval

Yes

Yes

Yes

**product component**

- HMI-High Feature
- is supported HMI-Standard
- is supported HMI-High Feature

No

Yes

Yes

**product feature integrated bypass contact system**

Yes

**number of controlled phases**

3

**trip class**

CLASS 10A (default) / 10E / 20E; acc. to IEC 60947-4-2

**buffering time in the event of power failure**

<ul style="list-style-type: none"> <li>• for main current circuit</li> <li>• for control circuit</li> </ul>	100 ms
<b>insulation voltage rated value</b>	100 ms
<b>degree of pollution</b>	600 V
<b>impulse voltage rated value</b>	3, acc. to IEC 60947-4-2
<b>blocking voltage of the thyristor maximum</b>	6 kV
<b>service factor</b>	1 600 V
<b>surge voltage resistance rated value</b>	1
<b>maximum permissible voltage for safe isolation</b>	6 kV
<ul style="list-style-type: none"> <li>• between main and auxiliary circuit</li> </ul>	600 V
<b>shock resistance</b>	15 g / 11 ms, from 12 g / 11 ms with potential contact lifting
<b>vibration resistance</b>	15 mm to 6 Hz; 2g to 500 Hz
utilization category according to IEC 60947-4-2	AC 53a
<b>reference code according to IEC 81346-2</b>	Q
<b>Substance Prohibitance (Date)</b>	02/15/2018
<b>product function</b>	
<ul style="list-style-type: none"> <li>• ramp-up (soft starting)</li> <li>• ramp-down (soft stop)</li> <li>• Soft Torque</li> <li>• adjustable current limitation</li> <li>• pump ramp down</li> <li>• intrinsic device protection</li> <li>• motor overload protection</li> </ul>	Yes
	Yes
	Yes
	Yes
	Yes
	Yes
	Yes; Full motor protection (thermistor motor protection and electronic motor overload protection)
	Yes; Type A PTC or Klixon / Thermoclick
<ul style="list-style-type: none"> <li>• evaluation of thermistor motor protection</li> <li>• inside-delta circuit</li> <li>• auto-RESET</li> <li>• manual RESET</li> <li>• remote reset</li> <li>• communication function</li> <li>• operating measured value display</li> <li>• error logbook</li> <li>• via software parameterizable</li> <li>• via software configurable</li> <li>• <b>PROFInergy</b></li> </ul>	Yes
	Yes
	Yes
	Yes; By turning off the control supply voltage
	Yes
	Yes; Only in conjunction with special accessories
	Yes; Only in conjunction with special accessories
	No
	Yes
	Yes; in connection with the PROFINET Standard communication module
	Yes
<ul style="list-style-type: none"> <li>• <b>firmware update</b></li> <li>• <b>removable terminal for control circuit</b></li> <li>• torque control</li> <li>• analog output</li> </ul>	Yes
	No
	No
<b>Power Electronics</b>	
<b>operational current</b>	
<ul style="list-style-type: none"> <li>• at 40 °C rated value</li> <li>• at 50 °C rated value</li> <li>• at 60 °C rated value</li> </ul>	470 A
	416 A
	380 A
<b>operational current at inside-delta circuit</b>	
<ul style="list-style-type: none"> <li>• at 40 °C rated value</li> <li>• at 50 °C rated value</li> <li>• at 60 °C rated value</li> </ul>	814 A
	721 A
	658 A
<b>operating voltage</b>	
<ul style="list-style-type: none"> <li>• rated value</li> <li>• at inside-delta circuit rated value</li> </ul>	200 ... 480 V
	200 ... 480 V
<b>relative negative tolerance of the operating voltage</b>	-15 %
<b>relative positive tolerance of the operating voltage</b>	10 %
<b>relative negative tolerance of the operating voltage at inside-delta circuit</b>	-15 %
<b>relative positive tolerance of the operating voltage at inside-delta circuit</b>	10 %
<b>operating power for 3-phase motors</b>	
<ul style="list-style-type: none"> <li>• at 230 V at 40 °C rated value</li> <li>• at 230 V at inside-delta circuit at 40 °C rated value</li> <li>• at 400 V at 40 °C rated value</li> <li>• at 400 V at inside-delta circuit at 40 °C rated value</li> </ul>	132 kW
	250 kW
	250 kW
	400 kW
<b>Operating frequency 1 rated value</b>	50 Hz

**Operating frequency 2 rated value****relative negative tolerance of the operating frequency****relative positive tolerance of the operating frequency****adjustable motor current**

• at rotary coding switch on switch position 1	200 A
• at rotary coding switch on switch position 2	218 A
• at rotary coding switch on switch position 3	236 A
• at rotary coding switch on switch position 4	254 A
• at rotary coding switch on switch position 5	272 A
• at rotary coding switch on switch position 6	290 A
• at rotary coding switch on switch position 7	308 A
• at rotary coding switch on switch position 8	326 A
• at rotary coding switch on switch position 9	344 A
• at rotary coding switch on switch position 10	362 A
• at rotary coding switch on switch position 11	380 A
• at rotary coding switch on switch position 12	398 A
• at rotary coding switch on switch position 13	416 A
• at rotary coding switch on switch position 14	434 A
• at rotary coding switch on switch position 15	452 A
• at rotary coding switch on switch position 16	470 A
• minimum	200 A

**adjustable motor current**

• for inside-delta circuit at rotary coding switch on switch position 1	346 A
• for inside-delta circuit at rotary coding switch on switch position 2	378 A
• for inside-delta circuit at rotary coding switch on switch position 3	409 A
• for inside-delta circuit at rotary coding switch on switch position 4	440 A
• for inside-delta circuit at rotary coding switch on switch position 5	471 A
• for inside-delta circuit at rotary coding switch on switch position 6	502 A
• for inside-delta circuit at rotary coding switch on switch position 7	533 A
• for inside-delta circuit at rotary coding switch on switch position 8	565 A
• for inside-delta circuit at rotary coding switch on switch position 9	596 A
• for inside-delta circuit at rotary coding switch on switch position 10	627 A
• for inside-delta circuit at rotary coding switch on switch position 11	658 A
• for inside-delta circuit at rotary coding switch on switch position 12	689 A
• for inside-delta circuit at rotary coding switch on switch position 13	721 A
• for inside-delta circuit at rotary coding switch on switch position 14	752 A
• for inside-delta circuit at rotary coding switch on switch position 15	783 A
• for inside-delta circuit at rotary coding switch on switch position 16	814 A
• at inside-delta circuit minimum	346 A

**minimum load [%]**15 %; Relative to smallest settable I<sub>e</sub>**power loss [W] for rated value of the current at AC**

• at 40 °C after startup	153 W
• at 50 °C after startup	137 W
• at 60 °C after startup	126 W

**power loss [W] at AC at current limitation 350 %**

• at 40 °C during startup	7 903 W
• at 50 °C during startup	6 604 W
• at 60 °C during startup	5 794 W

**Control circuit/ Control****type of voltage of the control supply voltage**  
**control supply voltage at AC**

AC/DC

<ul style="list-style-type: none"> <li>• at 50 Hz rated value</li> <li>• at 60 Hz rated value</li> </ul>	24 V
<b>relative negative tolerance of the control supply voltage at AC at 50 Hz</b>	24 V
<b>relative positive tolerance of the control supply voltage at AC at 50 Hz</b>	-20 %
<b>relative negative tolerance of the control supply voltage at AC at 60 Hz</b>	20 %
<b>relative positive tolerance of the control supply voltage at AC at 60 Hz</b>	-20 %
<b>control supply voltage frequency</b>	20 %
<b>relative negative tolerance of the control supply voltage frequency</b>	50 ... 60 Hz
<b>relative positive tolerance of the control supply voltage frequency</b>	-10 %
<b>control supply voltage</b>	10 %
<ul style="list-style-type: none"> <li>• at DC rated value</li> </ul>	24 V
<b>relative negative tolerance of the control supply voltage at DC</b>	-20 %
<b>relative positive tolerance of the control supply voltage at DC</b>	20 %
<b>control supply current in standby mode rated value</b>	160 mA
<b>holding current in bypass operation rated value</b>	470 mA
<b>inrush current peak at application of control supply voltage maximum</b>	3.3 A
<b>duration of inrush current peak at application of control supply voltage</b>	12.1 ms
<b>design of the overvoltage protection</b>	Varistor
<b>design of short-circuit protection for control circuit</b>	4 A gG fuse (Icu=1 kA), 6 A quick-acting fuse (Icu=1 kA), C1 miniature circuit breaker (Icu= 600 A), C6 miniature circuit breaker (Icu= 300 A); Is not part of scope of supply

#### Inputs/ Outputs

<b>number of digital inputs</b>	1
<b>number of digital outputs</b>	3
<ul style="list-style-type: none"> <li>• not parameterizable</li> </ul>	2
<b>digital output version</b>	2 normally-open contacts (NO) / 1 changeover contact (CO)
<b>number of analog outputs</b>	0
<b>switching capacity current of the relay outputs</b>	
<ul style="list-style-type: none"> <li>• at AC-15 at 250 V rated value</li> <li>• at DC-13 at 24 V rated value</li> </ul>	3 A
	1 A

#### Installation/ mounting/ dimensions

<b>mounting position</b>	with vertical mounting surface +/-90° rotatable, with vertical mounting surface +/- 22.5° tiltable to the front and back
<b>fastening method</b>	screw fixing
<b>height</b>	393 mm
<b>width</b>	210 mm
<b>depth</b>	203 mm
<b>required spacing with side-by-side mounting</b>	
<ul style="list-style-type: none"> <li>• forwards</li> <li>• backwards</li> <li>• upwards</li> <li>• downwards</li> <li>• at the side</li> </ul>	10 mm
	0 mm
	100 mm
	75 mm
	5 mm
<b>weight without packaging</b>	9.9 kg

#### Connections/ Terminals

<b>type of electrical connection</b>	
<ul style="list-style-type: none"> <li>• for main current circuit</li> <li>• for control circuit</li> </ul>	busbar connection
<b>width of connection bar maximum</b>	spring-loaded terminals
<b>wire length for thermistor connection</b>	45 mm
<ul style="list-style-type: none"> <li>• with conductor cross-section = 0.5 mm² maximum</li> <li>• with conductor cross-section = 1.5 mm² maximum</li> <li>• with conductor cross-section = 2.5 mm² maximum</li> </ul>	50 m
	150 m
	250 m
<b>type of connectable conductor cross-sections</b>	
<ul style="list-style-type: none"> <li>• for DIN cable lug for main contacts stranded</li> <li>• for DIN cable lug for main contacts finely stranded</li> </ul>	2x (50 ... 240 mm²)
	2x (70 ... 240 mm²)

**type of connectable conductor cross-sections**

- for control circuit solid
- for control circuit finely stranded with core end processing
- at AWG cables for control circuit solid
- at AWG cables for control circuit finely stranded with core end processing

2x (0.25 ... 1.5 mm<sup>2</sup>)  
 2x (0.25 ... 1.5 mm<sup>2</sup>)  
 2x (24 ... 16)  
 2x (24 ... 16)

**wire length**

- between soft starter and motor maximum
- at the digital inputs at AC maximum
- at the digital inputs at DC maximum

800 m  
 100 m  
 1 000 m

**tightening torque**

- for main contacts with screw-type terminals
- for auxiliary and control contacts with screw-type terminals

14 ... 24 N·m  
 0.8 ... 1.2 N·m

**tightening torque [lbf·in]**

- for main contacts with screw-type terminals
- for auxiliary and control contacts with screw-type terminals

124 ... 210 lbf·in  
 7 ... 10.3 lbf·in

**Ambient conditions**

installation altitude at height above sea level maximum

5 000 m; Derating as of 1000 m, see catalog

**ambient temperature**

- during operation
- during storage and transport

-25 ... +60 °C; Please observe derating at temperatures of 40 °C or above  
 -40 ... +80 °C

**environmental category**

- during operation according to IEC 60721
- during storage according to IEC 60721
- during transport according to IEC 60721

3K6 (no ice formation, only occasional condensation), 3C3 (no salt mist), 3S2 (sand must not get into the devices), 3M6  
 1K6 (only occasional condensation), 1C2 (no salt mist), 1S2 (sand must not get inside the devices), 1M4  
 2K2, 2C1, 2S1, 2M2 (max. fall height 0.3 m)  
 acc. to IEC 60947-4-2: Class A

**EMC emitted interference****Communication/ Protocol****communication module is supported**

- PROFINET standard
- EtherNet/IP
- Modbus RTU
- Modbus TCP
- PROFIBUS

Yes  
 Yes  
 Yes  
 Yes  
 Yes

**UL/CSA ratings****manufacturer's article number****• of the fuse**

- usable for Standard Faults up to 575/600 V according to UL
- usable for High Faults up to 575/600 V according to UL
- usable for Standard Faults at inside-delta circuit up to 575/600 V according to UL
- usable for High Faults at inside-delta circuit up to 575/600 V according to UL

Type: Class J / L, max. 1600 A; Iq = 30 kA  
 Type: Class J / L, max. 1200 A; Iq = 100 kA  
 Type: Class J / L, max. 1600 A; Iq = 30 kA  
 Type: Class J / L, max. 1200 A; Iq = 100 kA

**operating power [hp] for 3-phase motors**

- at 200/208 V at 50 °C rated value
- at 220/230 V at 50 °C rated value
- at 460/480 V at 50 °C rated value
- at 200/208 V at inside-delta circuit at 50 °C rated value
- at 220/230 V at inside-delta circuit at 50 °C rated value
- at 460/480 V at inside-delta circuit at 50 °C rated value

150 hp  
 150 hp  
 350 hp  
 250 hp  
 250 hp  
 600 hp

**contact rating of auxiliary contacts according to UL**

R300-B300

**Safety related data****protection class IP on the front according to IEC 60529**

IP00; IP20 with cover

**touch protection on the front according to IEC 60529**

finger-safe, for vertical contact from the front with cover

**electromagnetic compatibility**

in accordance with IEC 60947-4-2

## Certificates/ approvals

### General Product Approval

EMC



[Confirmation](#)



### Declaration of Conformity

### Test Certificates

### Marine / Shipping



[Type Test Certificates/Test Report](#)



### Marine / Shipping

### other



[Confirmation](#)

## Further information

Information- and Downloadcenter (Catalogs, Brochures,...)

<https://www.siemens.com/ic10>

Industry Mall (Online ordering system)

<https://mall.industry.siemens.com/mall/en/en/Catalog/product?mlfb=3RW5247-2TC04>

Cax online generator

<http://support.automation.siemens.com/WW/CAXorder/default.aspx?lang=en&mlfb=3RW5247-2TC04>

Service&Support (Manuals, Certificates, Characteristics, FAQs,...)

<https://support.industry.siemens.com/cs/ww/en/ps/3RW5247-2TC04>

Image database (product images, 2D dimension drawings, 3D models, device circuit diagrams, EPLAN macros, ...)

[http://www.automation.siemens.com/bilddb/cax\\_de.aspx?mlfb=3RW5247-2TC04&lang=en](http://www.automation.siemens.com/bilddb/cax_de.aspx?mlfb=3RW5247-2TC04&lang=en)

Characteristic: Tripping characteristics, I<sup>2</sup>t, Let-through current

<https://support.industry.siemens.com/cs/ww/en/ps/3RW5247-2TC04/char>

Characteristic: Installation altitude

<http://www.automation.siemens.com/bilddb/index.aspx?view=Search&mlfb=3RW5247-2TC04&objecttype=14&gridview=view1>

Simulation Tool for Soft Starters (STS)

<https://support.industry.siemens.com/cs/ww/en/view/101494917>

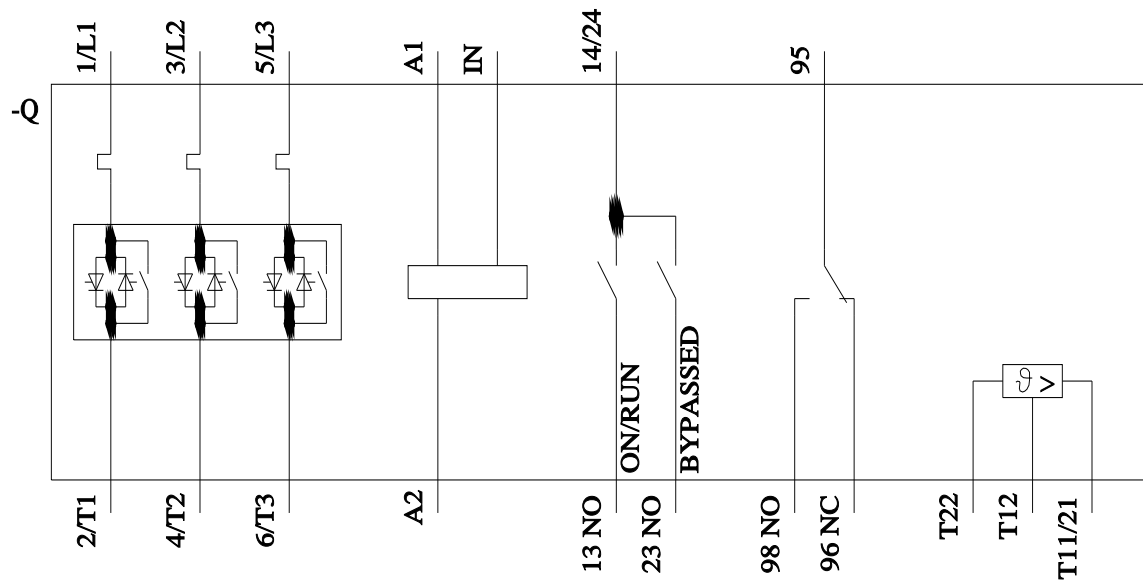
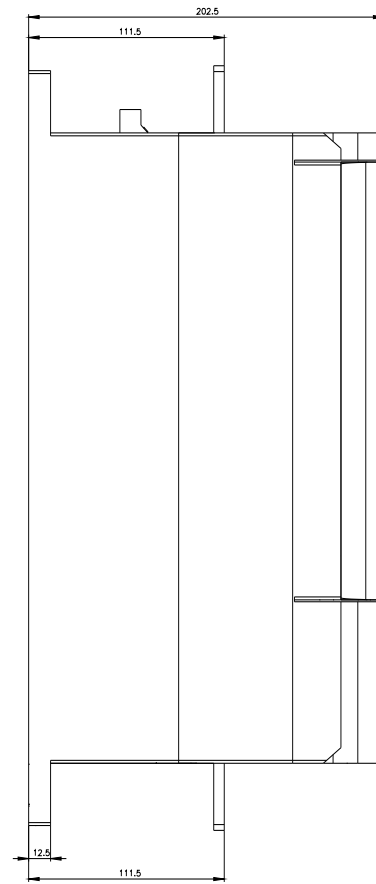
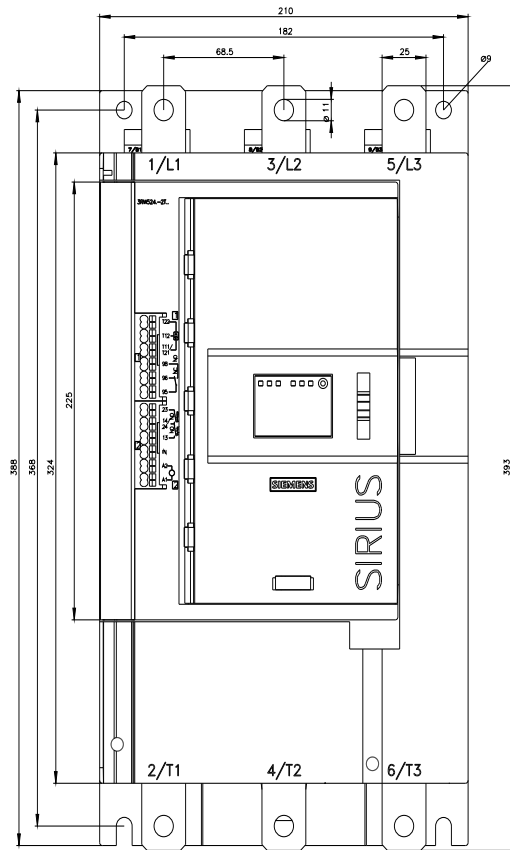



last modified:

4/10/2022 