



ACTUATOR-/INDICATOR COMPONENT CONTACT  
BLOCK WITH 2 CONTACTS SPRING-LOADED  
TERMINAL, 1NO,  
1NO

### Contact block/ lampholder:

|  |  |                         |
|--|--|-------------------------|
| Product designation                                    |  | contact block           |
| Number of NC contacts / for auxiliary contacts         |  | 0                       |
| Number of NO contacts / for auxiliary contacts         |  | 2                       |
| Number of changeover contacts / for auxiliary contacts |  | 0                       |
| Product function / positive opening                    |  | No                      |
| Number of lampholders                                  |  | 0                       |
| Design of the electrical connection                    |  | spring-loaded terminals |

### General technical data:

|  |   |   |
|--|---|---|
| Degree of pollution  |   | class 3   |
| Design of the fuse link / for short-circuit protection of the auxiliary switch / with type of assignment 1 / required  |   | gG / Dz 10 A  |
| Contact reliability  |   | one incorrect switching operation of 100 million switching operations (5 V, 1 mA) |
| Thermal current  | A | 10  |
| Voltage type / of operating voltage  |   | AC/DC   |
| Reference code   |   |   |
| <ul style="list-style-type: none"> <li>according to DIN EN 61346-2</li> <li>according to DIN 40719 extended according to IEC 204-2 / according to IEC 750</li> </ul> |   | S<br>S  |
| Ambient temperature  |   |   |

|  |    |             |
|--|----|-------------|
| • during operating   | °C | -25 ... +70 |
| • during storage   | °C | -25 ... +80 |
| <b>protection type IP</b>                                      |    |             |
| • of the terminal  |    | IP20        |
| • of the enclosure   |    | IP40        |
| <b>Operating voltage / 1 / at 50 Hz / for AC / rated value</b> | V  | 400         |
| <b>Operating voltage / 1 / at 60 Hz / for AC / rated value</b> | V  | 300         |
| <b>Operating voltage</b>                                       |    |             |
| • 1 / for DC / rated value                                     | V  | 24          |
| • at 50 Hz / at AC / rated value                               | V  | 5 ... 400   |
| • at 60 Hz / at AC / rated value                               | V  | 5 ... 300   |
| • for DC   |    |             |
| • rated value  | V  | 5 ... 230   |
| <b>Operating current</b>                                       |    |             |
| • at AC-12   |    |             |
| • at 24 V  | A  | 10          |
| • at 48 V  | A  | 10          |
| • at 110 V   | A  | 10          |
| • at 230 V   | A  | 10          |
| • at 400 V   | A  | 10          |
| • at AC-15   |    |             |
| • at 24 V  | A  | 6           |
| • at 48 V  | A  | 6           |
| • at 110 V   | A  | 6           |
| • at 230 V   | A  | 6           |
| • at 400 V   | A  | 3           |
| • at DC-12   |    |             |
| • at 24 V  | A  | 10          |
| • at 48 V  | A  | 5           |
| • at 110 V   | A  | 2.5         |
| • at 230 V   | A  | 1           |
| • at DC-13   |    |             |
| • at 24 V  | A  | 3           |
| • at 48 V  | A  | 1.5         |
| • at 110 V   | A  | 0.7         |
| • at 230 V   | A  | 0.3         |
| <b>Suitability for integration</b>                             |    |             |
| • pressure selection button                                    |    | Yes         |
| • front element  |    | Yes         |
| • suspension switch  |    | Yes         |

|   |     |                |
|---|-----|----------------|
| • suspension pushbutton   |     | Yes            |
| <b>Insulation voltage / rated value</b>   | V   | 400            |
| <b>Impulse voltage resistance / rated value</b>   | kV  | 4              |
| <b>Operating cycles / maximum</b>   | 1/h | 1,000          |
| <b>Electrical operating cycles as operating time / with contactors 3RT1015 to 3RT1026 / typical</b> |     | 10,000,000     |
| <b>Mechanical operating cycles as operating time / typical</b>                                      |     | 10,000,000     |
| <b>Product component</b>  |     |                |
| • fluorescent materials   |     | No             |
| • diode   |     | No             |
| • lamp transformer  |     | No             |
| • series resistance   |     | No             |
| <b>Mounting type</b>  |     | front mounting |
| <b>Width</b>  | mm  | 10             |
| <b>Height</b>   | mm  | 45             |
| <b>Depth</b>  | mm  | 33.4           |

#### Connections/ terminals:

##### Type of the connectable conductor cross-section

- for auxiliary contacts / solid
- for auxiliary contacts / finely stranded / with conductor end processing
- for auxiliary contacts / finely stranded / without conductor final cutting
- for AWG conductors / for auxiliary contacts

2x (0.25 ... 1.5 mm<sup>2</sup>)  
2x (0.25 ... 0.75 mm<sup>2</sup>)  
2x (0.25 ... 1.5 mm<sup>2</sup>)  
2x (24 ... 16)

#### Certificates/ approvals:

##### General Product Approval

##### Declaration of Conformity

##### other



CCC



CSA



EG-Konf.

[Confirmation](#)

[Environmental Confirmations](#)

#### Further information:

##### Information- and Downloadcenter (Catalogs, Brochures,...)

<http://www.siemens.com/industrial-controls/catalogs>

##### Industry Mall (Online ordering system)

<http://www.siemens.com/industrial-controls/mall>

##### Cax online generator

<http://www.siemens.com/cax>

##### Service&Support (Manuals, Certificates, Characteristics, FAQs,...)

<http://support.automation.siemens.com/WW/view/en/3SB3403-0D/all>

##### Image database (product images, 2D dimension drawings, 3D models, device circuit diagrams, ...)

[http://www.automation.siemens.com/bilddb/cax\\_en.aspx?mlfb=3SB3403-0D](http://www.automation.siemens.com/bilddb/cax_en.aspx?mlfb=3SB3403-0D)

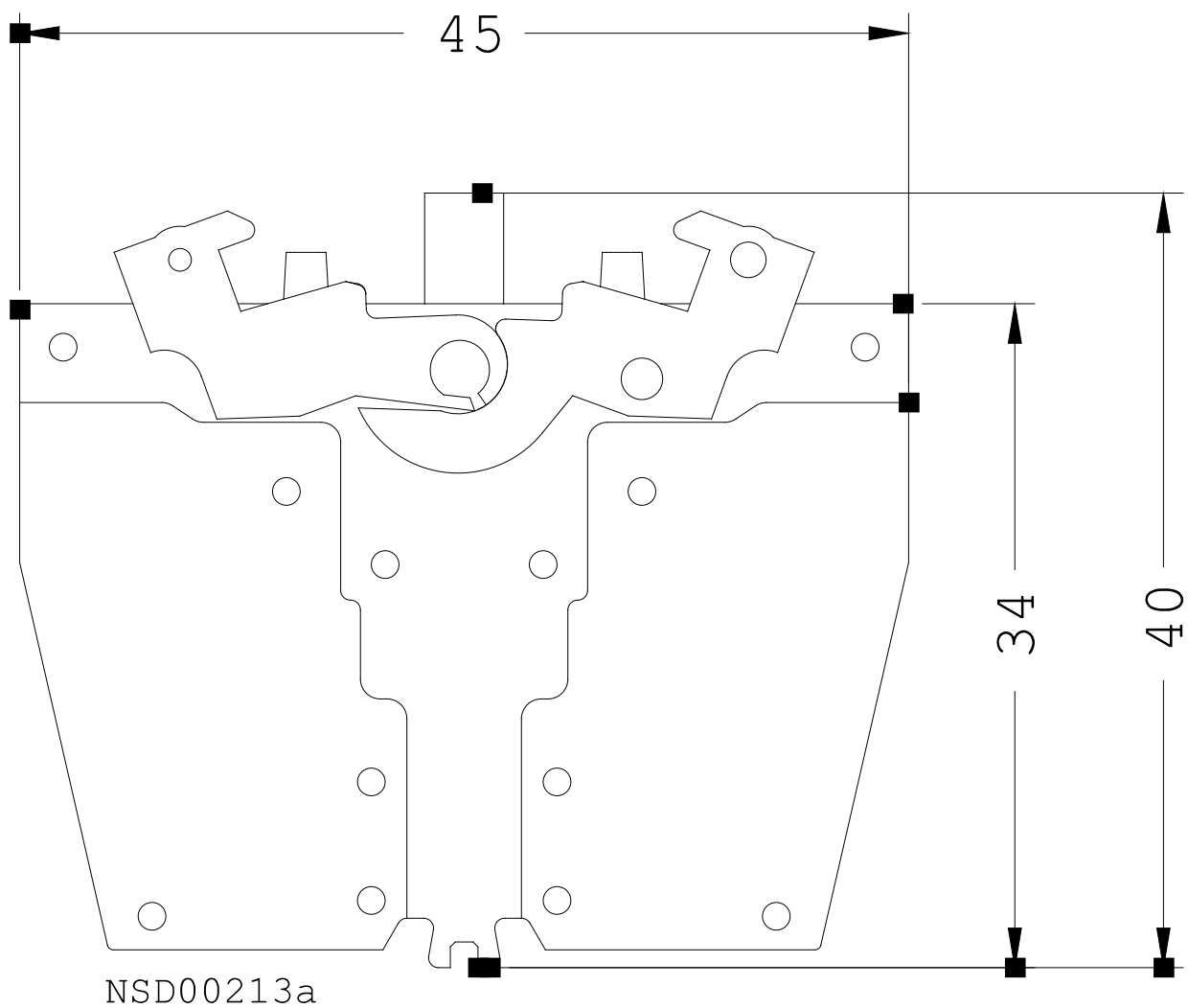

NSD00213a

last change:

Jul 7, 2014