

Actuator:

| | | |
|--|----|---|
| Design of the operating mechanism | | key-operated switch with 2 switch positions |
| Shape / of the activation element | | round |
| Manner of function / of the activation element | | <ul style="list-style-type: none"> • arresting lock • tentative |
| Outer diameter / of the activation element | mm | 28.5 |
| Material / of the activation element | | plastic |

Button:

| | | |
|----------------------|--|--------|
| Design of the button | | raised |
|----------------------|--|--------|

Front ring:

| | | |
|------------------------------|--|--------|
| Material / of the front ring | | metal |
| Color / of the front ring | | silver |

General technical details:

| | | |
|--|--|-------------------------|
| Design of the product | | with 2 switch positions |
| Number of control points | | 1 |
| Number of indicator lights / installable | | 0 |
| Number of switching positions | | 2 |

| | | |
|--|-----|-------------------|
| Switch position for key distraction | | O+I |
| Product extension / optional / fluorescent materials | | No |
| Product function / emergency-OFF function | | No |
| Type of unlocking device | | key unlatching |
| Resistance against shock <ul style="list-style-type: none"> • for devices without incandescent lamp / according to IEC 60068-2-27 | | <= 50g |
| Operating cycles / maximum | 1/h | 1,000 |
| Resistance against vibration / according to IEC 60068-2-6 | | 20 ... 200 Hz: 5g |
| Mechanical operating cycles as operating time / typical | | 300,000 |
| Item designation <ul style="list-style-type: none"> • according to DIN 40719 extendable after IEC 204-2 / according to IEC 750 • according to DIN EN 61346-2 | | S S |

Auxiliary Contacts:

| | | |
|--|--|---|
| Number of NC contacts / for auxiliary contact | | 0 |
| Number of NO contacts / for auxiliary contact | | 0 |
| Number of change-over switches / for auxiliary contact | | 0 |

Installation/mounting/dimensions:

| | | |
|---|-----|----------------|
| Product component / front ring | | Yes |
| Material / of the housing | | metal |
| Type of mounting | | front mounting |
| Installation width | mm | 22 |
| Shape / of the installation hole | | round |
| Mounting diameter | mm | 22 |
| Height | mm | 30 |
| Width | mm | 30 |
| Depth | mm | 73 |
| Tightening torque / of the screws in the holder / maximum | N·m | 1 |

Ambient conditions:

| | | |
|--|----------|--------------------------|
| Ambient temperature <ul style="list-style-type: none"> • during the operating phase • during storage | °C °C | 70 ... -25 -40 ... 80 |
| Protection class IP | | IP67 |
| Climatic class / according to DIN EN ISO 6270-2 | | KTW24 |

Certificates/approvals:

General Product Approval**Test Certificates**[Manufacturer](#)**Shipping Approval**[ABS](#)[PRS](#)**other**[Manufacturer](#)**Further information:****Information- and Downloadcenter (Catalogs, Brochures,...)**<http://www.siemens.com/industrial-controls/catalogs>**Industry Mall (Online ordering system)**<http://www.siemens.com/industrial-controls/mall>**CAX-Online-Generator**<http://www.siemens.com/cax>**Service&Support (Manuals, Certificates, Characteristics, FAQs,...)**<http://support.automation.siemens.com/WW/view/en/3SB3500-4AL11/all>**Image database (product images, 2D dimension drawings, 3D models, device circuit diagrams, ...)**http://www.automation.siemens.com/bilddb/cax_en.aspx?mlfb=3SB3500-4AL11

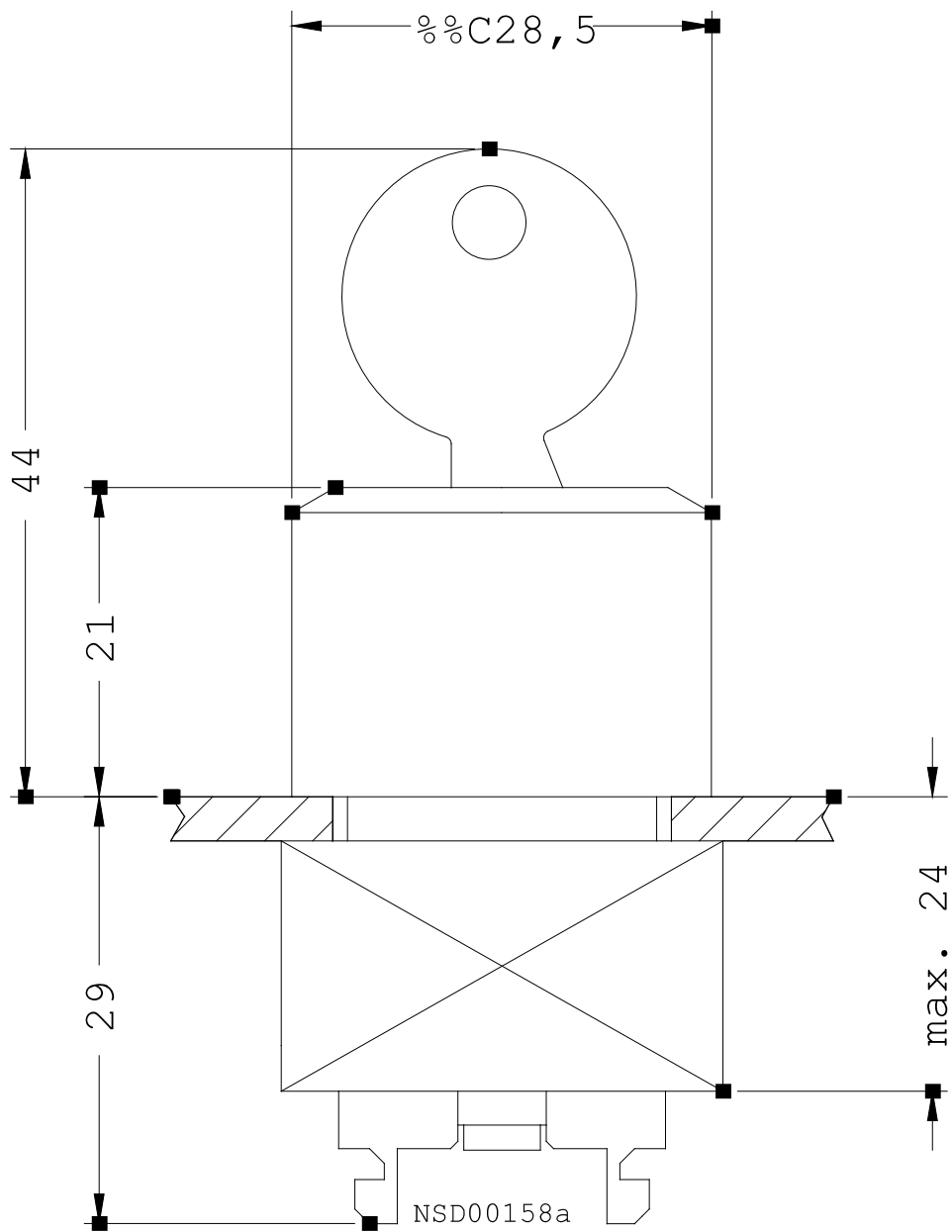

last change:

Sep 6, 2010