



22MM METAL ROUND INDICATOR: INDICATOR LIGHT WITH SMOOTH LENSE ILLUMINABLE WITH HOLDER RED

### Actuator:

Design of the operating mechanism		indicator light
Outer diameter / of the activation element	mm	28
Material / of the activation element		plastic

### Front ring:

Material / of the front ring		metal
------------------------------	--	-------

### General technical details:

Design of the product		smooth lense
Number of control points		0
Design of the indicator light		lense, smooth
Number of indicator lights / installable		1
Model of the lens		round
Number of switching positions		0
Product extension / optional / fluorescent materials		Yes
Product function / emergency-OFF function		No
Resistance against shock		
<ul style="list-style-type: none"> <li>for devices with incandescent lamp / according to IEC 60068-2-27</li> </ul>		<= 30g

<ul style="list-style-type: none"> <li>for devices without incandescent lamp / according to IEC 60068-2-27</li> </ul>		<= 50g
<b>Operating cycles / maximum</b>	1/h	1,000
<b>Resistance against vibration / according to IEC 60068-2-6</b>		20 ... 200 Hz: 5g
<b>Item designation</b> <ul style="list-style-type: none"> <li>according to DIN 40719 extendable after IEC 204-2 / according to IEC 750</li> <li>according to DIN EN 61346-2</li> </ul>		H  P

#### Auxiliary Contacts:

<b>Number of NC contacts / for auxiliary contact</b>		0
<b>Number of NO contacts / for auxiliary contact</b>		0
<b>Number of change-over switches / for auxiliary contact</b>		0

#### Installation/mounting/dimensions:

<b>Design of the cap</b>		flat
<b>Color / of the lens</b>		red
<b>Product component / front ring</b>		No
<b>Material / of the housing</b>		metal
<b>Type of mounting</b>		front mounting
<b>Installation width</b>	mm	22
<b>Shape / of the installation hole</b>		round
<b>Mounting diameter</b>	mm	22
<b>Height</b>	mm	30
<b>Width</b>	mm	30
<b>Depth</b>	mm	40.5
<b>Tightening torque / of the screws in the holder / maximum</b>	N·m	1

#### Ambient conditions:

<b>Ambient temperature</b> <ul style="list-style-type: none"> <li>during the operating phase</li> <li>during storage</li> </ul>	°C °C	70 ... -25 -40 ... 80
<b>Protection class IP</b>		IP67
<b>Climatic class / according to DIN EN ISO 6270-2</b>		KTW24

#### Certificates/approvals:

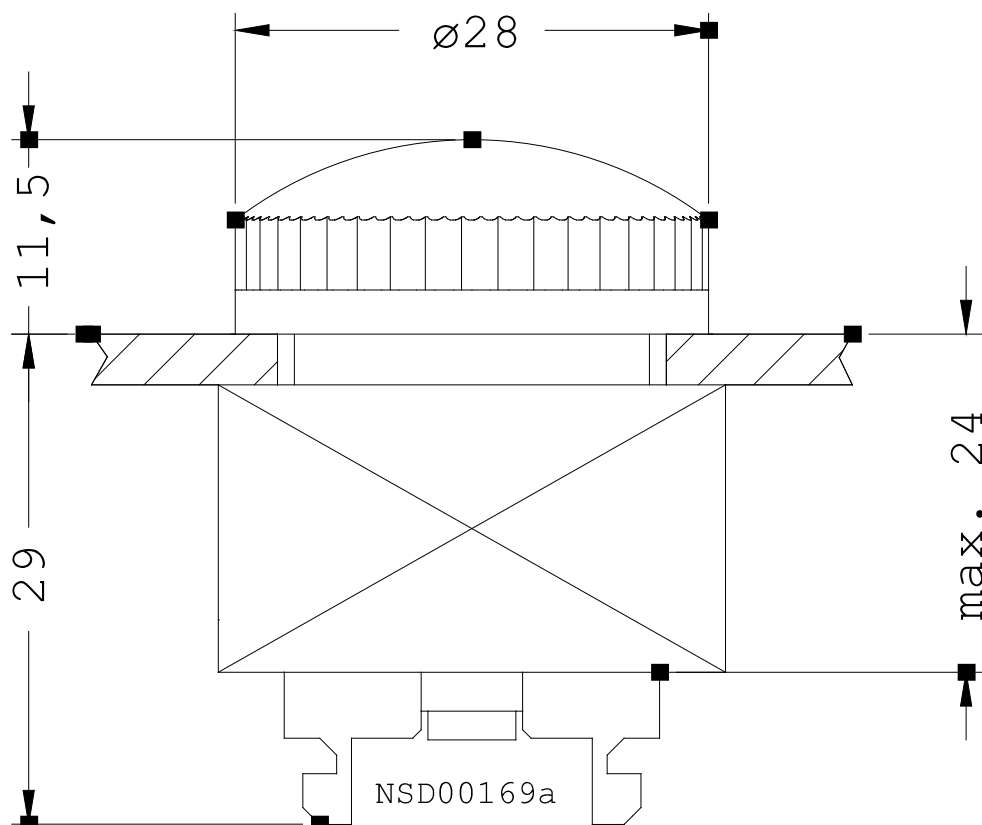
**General Product Approval****Test Certificates**[Manufacturer](#)**Shipping Approval**[ABS](#)[PRS](#)**other**[Manufacturer](#)**Further information:****Information- and Downloadcenter (Catalogs, Brochures,...)**<http://www.siemens.com/industrial-controls/catalogs>**Industry Mall (Online ordering system)**<http://www.siemens.com/industrial-controls/mall>**CAX-Online-Generator**<http://www.siemens.com/cax>**Service&Support (Manuals, Certificates, Characteristics, FAQs,...)**<http://support.automation.siemens.com/WW/view/en/3SB3501-6AA20/all>**Image database (product images, 2D dimension drawings, 3D models, device circuit diagrams, ...)**[http://www.automation.siemens.com/bilddb/cax\\_en.aspx?mlfb=3SB3501-6AA20](http://www.automation.siemens.com/bilddb/cax_en.aspx?mlfb=3SB3501-6AA20)**last change:**

Sep 6, 2010