



Position switch Plastic 31 mm according to EN 50047 Increased corrosion protection Device connection 1 x (M20 x 1.5) 1 NO/1 NC quick action contacts Twist lever, adjustable length with grid hole on the right and/or left adjustable, with Stainless steel lever and plastic roller 19 mm functional at -40 °C Shock and vibration test according to EN 61373, Category 1B

**product brand name**

SIRIUS

**product designation**

Mechanical position switches

**product type designation**

3SE5

**manufacturer's article number**

- of the supplied actuator head for position switches
- of the supplied operating lever
- of the supplied switching contacts

[3SE5000-0AK00-1AJ0](#)

[3SE5000-0AA62-1AJ0](#)

[3SE5000-0CA00](#)

**suitability for use safety switch**

Yes

### General technical data

**product function positive opening**

Yes

**insulation voltage rated value**

400 V

**degree of pollution**

class 3

**surge voltage resistance rated value**

6 kV

**protection class IP**

IP65

**shock resistance**

- according to IEC 60068-2-27
- for railway applications according to EN 61373

30g / 11 ms

Category 1, Class B

**vibration resistance**

- according to IEC 60068-2-6
- for railway applications according to EN 61373

0.35 mm/5g

Category 1, Class B

**mechanical service life (operating cycles) typical**

15 000 000

**electrical endurance (operating cycles) at AC-15 at 230 V typical**

100 000

**electrical endurance (operating cycles) with contactor 3RH11, 3RT1016, 3RT1017, 3RT1024, 3RT1025, 3RT1026 typical**

10 000 000

**Electrical operating cycles in one hour with contactor 3RH11, 3RT1016, 3RT1017, 3RT1024, 3RT1025, 3RT1026**

6 000

**thermal current**

10 A

**material of the enclosure of the switch head**

plastic

**reference code according to IEC 81346-2**

B

**continuous current of the C characteristic MCB**

1 A; for a short-circuit current smaller than 400 A

**continuous current of the quick DIAZED fuse link**

10 A; for a short-circuit current smaller than 400 A

**continuous current of the DIAZED fuse link gG**

6 A

**active principle**

mechanical

**repeat accuracy**

0.05 mm

**Substance Prohibitance (Date)**

07/01/2006

**minimum actuating torque in directions of actuation**

0.25 N·m

**length of the sensor**

182 mm

**width of the sensor**

31 mm

### Ambient conditions

**ambient temperature**

<ul style="list-style-type: none"> <li>during operation</li> <li>during storage</li> </ul>	-40 ... +85 °C
<b>explosion protection category for dust</b>	-40 ... +90 °C
<b>design of the switching contact</b>	none
<b>operating frequency rated value</b>	mechanical
<b>number of NC contacts for auxiliary contacts</b>	50 ... 60 Hz
<b>number of NO contacts for auxiliary contacts</b>	1
<b>operational current at AC-15</b>	1
<ul style="list-style-type: none"> <li>at 24 V rated value</li> <li>at 120 V rated value</li> <li>at 240 V rated value</li> <li>at 400 V rated value</li> </ul>	6 A
<b>operational current at DC-13</b>	6 A
<ul style="list-style-type: none"> <li>at 24 V rated value</li> <li>at 125 V rated value</li> <li>at 250 V rated value</li> <li>at 400 V rated value</li> </ul>	6 A
	4 A
	3 A
	0.55 A
	0.27 A
	0.12 A
<b>Enclosure</b>	
<b>design of the housing</b>	block, narrow
<b>material of the enclosure</b>	plastic
<b>coating of the enclosure</b>	Other types
<b>design of the housing according to standard</b>	Yes
<b>Drive Head</b>	
<b>design of the actuating element</b>	Adjustable twist lever, adjustable-length metal lever with positive fit, 100 mm long, plastic roller 19 mm
<b>standard-compliant actuator head</b>	EN 50047, design A
<b>shape of the switch head</b>	roller
<b>design of the switching function</b>	positive opening
<b>circuit principle</b>	snap-action contacts
<b>number of switching contacts safety-related</b>	1
<b>cable entry type</b>	1x (M20 x 1.5)
<b>Installation/ mounting/ dimensions</b>	
<b>mounting position</b>	any
<b>fastening method</b>	screw fixing
<b>Connections/ Terminals</b>	
<b>type of electrical connection</b>	screw-type terminals
<b>type of connectable conductor cross-sections</b>	
<ul style="list-style-type: none"> <li>solid</li> <li>finely stranded with core end processing</li> <li>at AWG cables solid</li> <li>at AWG cables stranded</li> </ul>	1x (0.5 ... 1.5 mm <sup>2</sup> ), 2x (0.5 ... 0.75 mm <sup>2</sup> )
	1x (0.5 ... 1.5 mm <sup>2</sup> ), 2x (0.5 ... 0.75 mm <sup>2</sup> )
	1x (20 ... 16), 2x (20 ... 18)
	1x (20 ... 16), 2x (20 ... 18)
<b>design of the interface for safety-related communication</b>	without
<b>Communication/ Protocol</b>	
<b>design of the interface</b>	without
<b>Certificates/ approvals</b>	
<b>General Product Approval</b>	



[Confirmation](#)



Functional Safety/Safety of Machinery	Declaration of Conformity	Test Certificates	other
---------------------------------------	---------------------------	-------------------	-------

[Type Examination Certificate](#)



[Type Test Certificates/Test Report](#)

[Confirmation](#)

## Further information

### Information on the packaging

<https://support.industry.siemens.com/cs/ww/en/view/109813875>

### Information- and Downloadcenter (Catalogs, Brochures,...)

<https://www.siemens.com/ic10>

### Industry Mall (Online ordering system)

<https://mall.industry.siemens.com/mall/en/en/Catalog/product?mlfb=3SE5232-0CK62-1AJ0>

### Cax online generator

<http://support.automation.siemens.com/WW/CAXorder/default.aspx?lang=en&mlfb=3SE5232-0CK62-1AJ0>

### Service&Support (Manuals, Certificates, Characteristics, FAQs,...)

<https://support.industry.siemens.com/cs/ww/en/ps/3SE5232-0CK62-1AJ0>

### Image database (product images, 2D dimension drawings, 3D models, device circuit diagrams, EPLAN macros, ...)

[http://www.automation.siemens.com/bilddb/cax\\_de.aspx?mlfb=3SE5232-0CK62-1AJ0&lang=en](http://www.automation.siemens.com/bilddb/cax_de.aspx?mlfb=3SE5232-0CK62-1AJ0&lang=en)

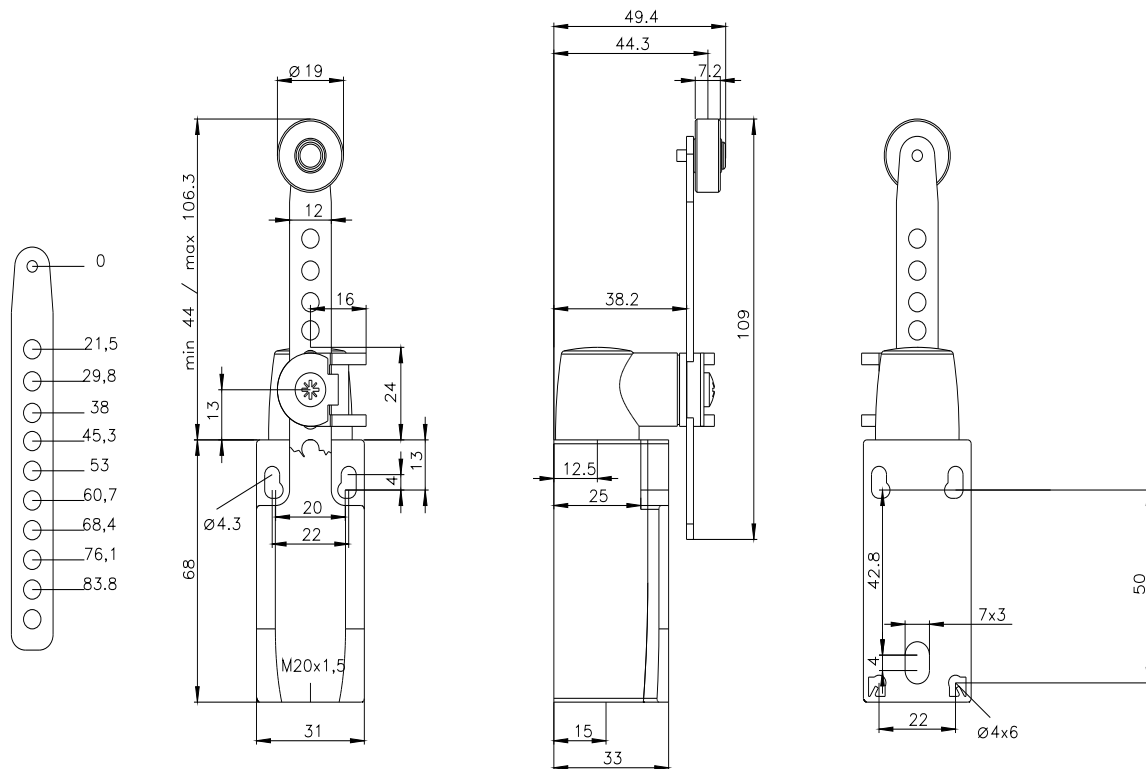

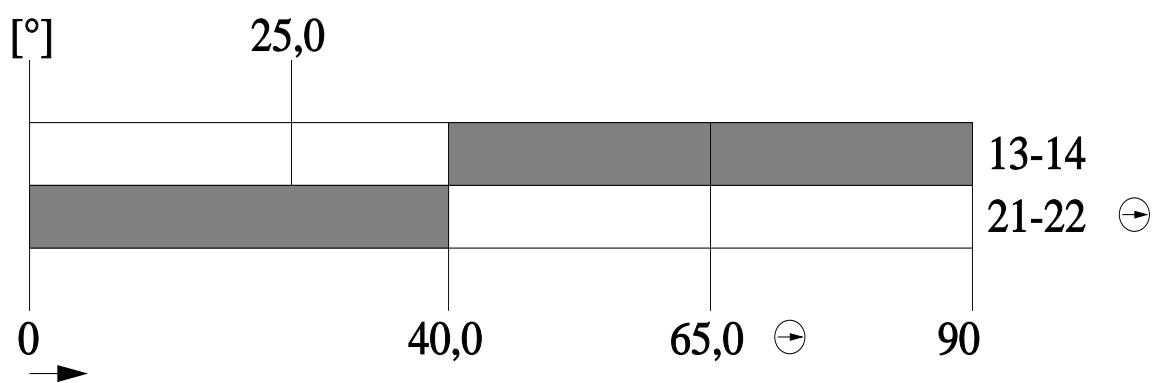
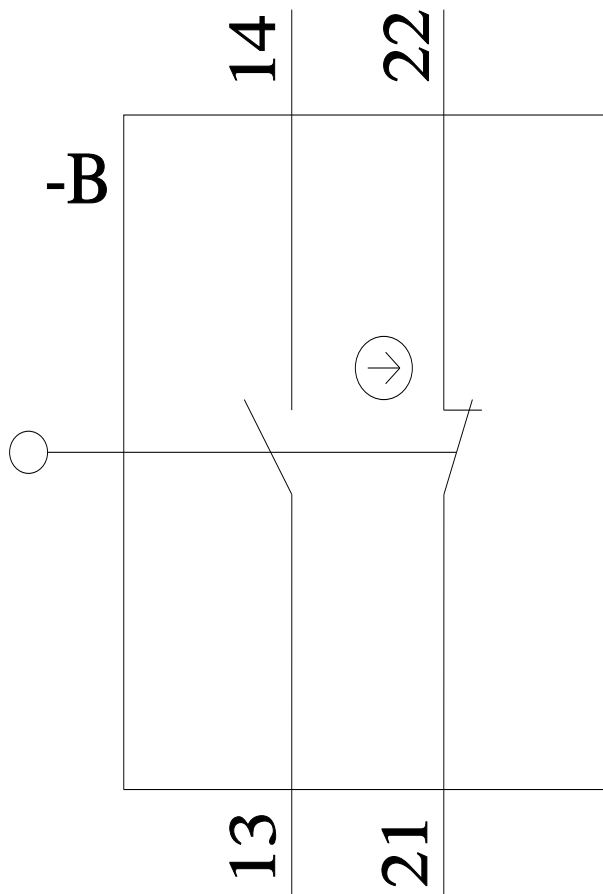

last modified:

3/23/2022