



Position switch in compact design 30 mm wide with connecting cable 5 m
Snap-action contacts 1 NO+1 NC with rounded plunger

| | |
|-----------------------------------|------------------------------|
| product brand name | SIRIUS |
| product designation | Mechanical position switches |
| product type designation | 3SE5 |
| suitability for use safety switch | Yes |

General technical data

| | |
|-------------------------------------------------------------------------------------------------------------------|-------------|
| product function positive opening | Yes |
| insulation voltage rated value | 400 V |
| degree of pollution | 3 |
| surge voltage resistance rated value | 4 kV |
| protection class IP | IP67 |
| shock resistance | |
| • according to IEC 60068-2-27 | 30g / 11 ms |
| vibration resistance according to IEC 60068-2-6 | 0.35 mm/5g |
| mechanical service life (operating cycles) typical | 10 000 000 |
| electrical endurance (operating cycles) at AC-15 at 230 V typical | 100 000 |
| electrical endurance (operating cycles) with contactor 3RH11, 3RT1016, 3RT1017, 3RT1024, 3RT1025, 3RT1026 typical | 500 000 |
| Electrical operating cycles in one hour with contactor 3RH11, 3RT1016, 3RT1017, 3RT1024, 3RT1025, 3RT1026 | 1 800 |
| thermal current | 10 A |
| material of the enclosure of the switch head | metal |
| reference code according to IEC 81346-2 | B |
| active principle | mechanical |
| repeat accuracy | 0.05 mm |
| Substance Prohibitance (Date) | 07/01/2006 |
| minimum actuating force in directions of actuation | 20 N |
| length of the sensor | 60 mm |
| width of the sensor | 30 mm |

Ambient conditions

| | |
|----------------------------------------------|----------------|
| ambient temperature | |
| • during operation | -25 ... +85 °C |
| • during storage | -25 ... +85 °C |
| explosion protection category for dust | none |
| design of the switching contact | mechanical |
| operating frequency rated value | 50 ... 60 Hz |
| number of NC contacts for auxiliary contacts | 1 |
| number of NO contacts for auxiliary contacts | 1 |
| operational current at AC-15 | |
| • at 125 V rated value | 6 A |
| • at 230 V rated value | 3 A |

| | | | |
|------------------------------------------------------------------------------------------------|--------------------------------|--------------------------|---------------------------|
| operational current at DC-13 | | | |
| • at 125 V rated value | 0.55 A | | |
| • at 230 V rated value | 0.27 A | | |
| Enclosure | | | |
| design of the housing | block | | |
| material of the enclosure | metal | | |
| coating of the enclosure | painted | | |
| design of the housing according to standard | No | | |
| material of cable sheath | PVC | | |
| Drive Head | | | |
| design of the actuating element | rounded plunger | | |
| shape of the switch head | rounded | | |
| design of the switching function | snap-action contact | | |
| circuit principle | snap-action contacts | | |
| number of switching contacts safety-related | 1 | | |
| Installation/ mounting/ dimensions | | | |
| mounting position | any | | |
| fastening method | screw fixing | | |
| Connections/ Terminals | | | |
| type of electrical connection | cable, 5 x 0.75mm ² | | |
| design of the interface for safety-related communication | without | | |
| Communication/ Protocol | | | |
| design of the interface | without | | |
| Certificates/ approvals | | | |
| <table> <tr> <td>General Product Approval</td><td>Declaration of Conformity</td></tr> </table> | | General Product Approval | Declaration of Conformity |
| General Product Approval | Declaration of Conformity | | |

[Confirmation](#)



other

[Confirmation](#)

Further information

Information- and Downloadcenter (Catalogs, Brochures,...)

<https://www.siemens.com/ic10>

Industry Mall (Online ordering system)

<https://mall.industry.siemens.com/mall/en/en/Catalog/product?mlfb=3SE5413-0CC20-1EA5>

Cax online generator

<http://support.automation.siemens.com/WW/CAXorder/default.aspx?lang=en&mlfb=3SE5413-0CC20-1EA5>

Service&Support (Manuals, Certificates, Characteristics, FAQs,...)

<https://support.industry.siemens.com/cs/ww/en/ps/3SE5413-0CC20-1EA5>

Image database (product images, 2D dimension drawings, 3D models, device circuit diagrams, EPLAN macros, ...)

http://www.automation.siemens.com/bilddb/cax_de.aspx?mlfb=3SE5413-0CC20-1EA5&lang=en

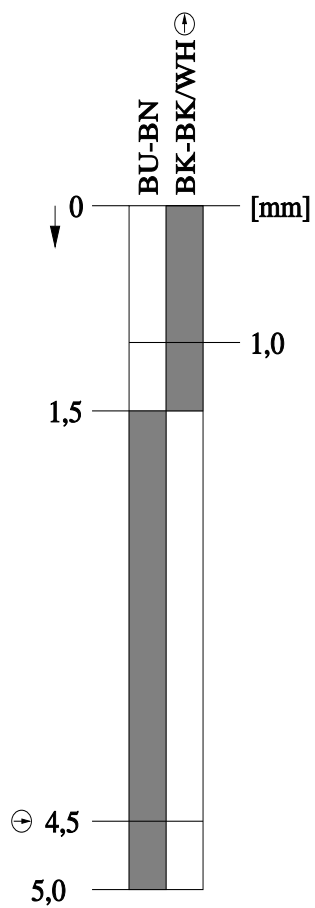
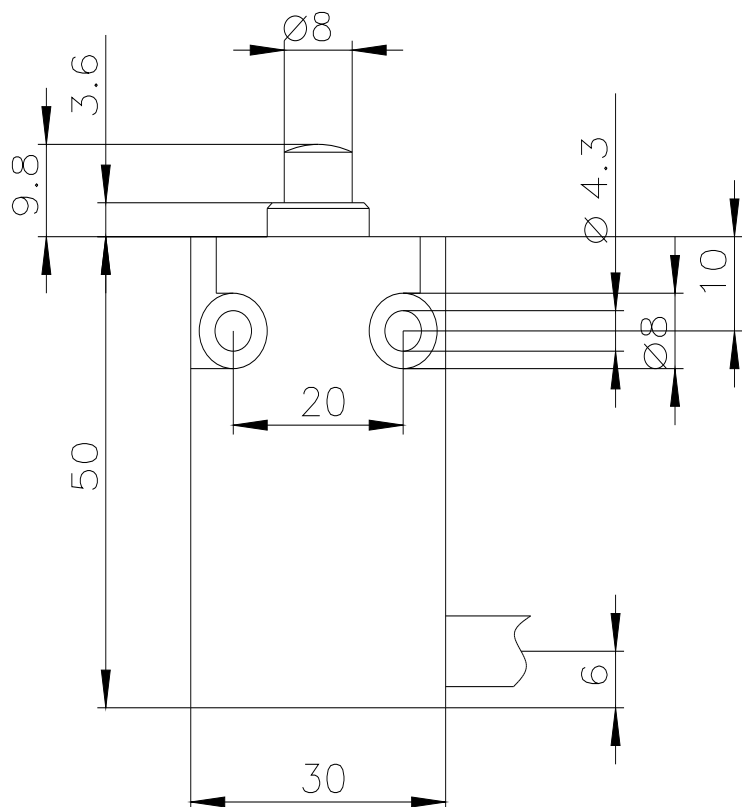

last modified:

1/26/2022

