

Pushbutton Switch (Detachable) (Lighted/Non-Lighted) (Cylindrical 16-dia.)

A16-TAM-1

Cylindrical (16 mm dia.), Round projection type, Blue, IP40, Momentary, SPDT, Quick connect terminal / Solder terminal

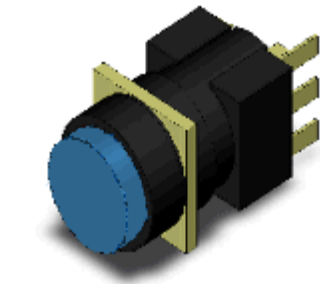

Image

Ratings

As of June 16, 2021

| | | |
|---------------------------------|----------------------------|--|
| Type | | Pushbutton Switch (Cylindrical 16-dia.) |
| Shape | | Cylindrical type (16 mm dia.) |
| Lighted/Non-lighted | | Non-lighted |
| Operating portion | Shape of operating portion | Round projection type |
| | Color of operating portion | Blue |
| Operating function | | Momentary |
| Load | | General load/Micro load |
| Minimum applicable load | | 1 mA at 5 VDC |
| Contact rating | Contact form | SPDT |
| | Ratings (AC) | Resistive load: 5 A at 125 VAC/3 A at 250 VAC |
| | Ratings (DC) | Resistive load: 3 A at 30 VDC |
| | Ratings explanation | Conditions: No vibration and no shock, Temperature 20±2 °C, Operating frequency 20 operations/min |
| Terminal specifications | | Quick connect terminal (#110/t=0.5) / Solder terminal |
| Permissible operating frequency | | Electrical: Max. 20 operations / 1 minute Mechanical: Max. 120 operations / 1 minute |
| Insulation resistance | | 100 MΩ min. (at 500 VDC) |
| Dielectric strength | | Between each terminal of the same polarities: 1000 VAC 50/60 Hz 1 min Between each terminal of the different polarities: 2000 VAC 50/60 Hz 1 min Between each terminal and ground: 2000 VAC 50/60 Hz 1 min |
| Vibration resistance | | Malfunction: 10 to 55 Hz, 1.5 mm double amplitude (malfunction: 1 ms max.) |
| Shock resistance | | Destruction: 500 m/s ² max. Malfunction: 150 m/s ² max. (malfunction time is 1 ms max.) |

| | |
|---|--|
| Ambient temperature range | Operating: -10 to 55 °C (with no freezing or condensation) Storage: -25 to 65 °C (with no freezing or condensation) |
| Ambient humidity range | Operating: 35 to 85% |
| Degree of protection | IP40 |
| Classification of protection against electric shock | Class II |
| PTI (Tracking characteristic) | 175 |
| Pollution degree | 3 (IEC60947-5-1) |

Operating characteristics

| | |
|----------------------|--------------|
| Operating Force (OF) | 4.41 N max. |
| Release Force (RF) | 0.29 N min. |
| Pre-Travel (PT) | 2.5 mm max. |
| Total Travel (TT) | Approx. 3 mm |

As of June 16, 2021

Mounting hole dimensions

As of June 16, 2021

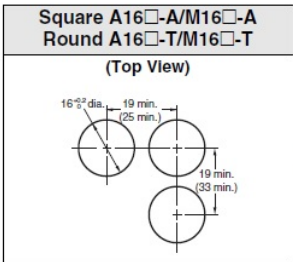

- Note:
- Make sure the thickness of the mounting panel is between 0.5 and 3.2 mm. If, however, a Switch Guard or Dust Cover is used, the thickness of the mounting panel must be between 0.5 and 2 mm.
 - If the panel is to be finished with coating, etc., make sure that the panel meets the specified dimensions after coating.
 - Figures in parentheses are for Screw-less Clamp Connectors.

As of June 16, 2021

Applicable load diagram

As of June 16, 2021

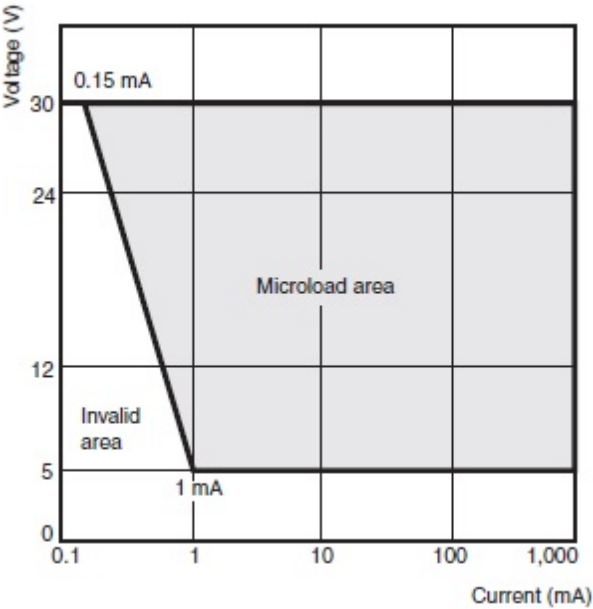

As of June 16, 2021