



Main

Range Compatibility	Lexium 28
Device short name	BCH2
Product or Component Type	Servo motor

Complementary

Maximum mechanical speed	3000 rpm
[Us] rated supply voltage	220 V
Phase	Three phase
Continuous stall current	19.68 A
Continuous stall torque	253.57 lbf.in (28.65 N.m) LXM28... 22.9 A, 220 V, three phase
Continuous power	4500 W
Peak stall torque	633.89 lbf.in (71.62 N.m) LXM28... 22.9 A, 220 V, three phase
Nominal output power	4500 W LXM28... 22.9 A, 220 V, three phase
Nominal torque	253.57 lbf.in (28.65 N.m) LXM28... 22.9 A, 220 V, three phase
Nominal speed	1500 rpm LXM28... 22.9 A, 220 V, three phase
Maximum current Irms	57.6 A LXM28... 4.5 kW, 220 V
Maximum permanent current	22.8 A
Product compatibility	LXM28... servo drive 4.5 kW, 220 V, three phase
Shaft end	Keyed
Shaft diameter	1.4 in (35 mm)
Shaft length	3.1 in (79 mm)
Key width	0.4 in (10 mm)
Feedback type	20 bits single turn absolute encoder
Holding brake	Without
Mounting Support	Asian standard flange
Motor flange size	7.09 in (180 mm)
Electrical connection	Connector MIL
Torque constant	1.46 N.m/A 68 °F (20 °C)
Back emf constant	88 V/krpm 68 °F (20 °C)
Rotor inertia	73.32 kg.cm ²
Stator resistance	0.199 Ohm 68 °F (20 °C)
Stator inductance	3.8 mH 68 °F (20 °C)
Stator electrical time constant	19.1 ms 68 °F (20 °C)
Maximum radial force Fr	1200 N 1500 rpm
Maximum axial force Fa	497 N
Brake pull-in power	49.6 W
Type of cooling	Natural convection
Length	9.3 in (235 mm)

Number of motor stacks	3
Centring collar diameter	4.5 in (114.3 mm)
Centring collar depth	0.2 in (4 mm)
Number of mounting holes	4
Mounting holes diameter	0.5 in (13.5 mm)
Circle diameter of the mounting holes	7.9 in (200 mm)
Distance shaft shoulder-flange	0.2 in (4 mm)
Net Weight	52.12 lb(US) (23.64 kg)

Environment

IP Degree of Protection	IP54 IM B5, IM V1 IP50 IM V3
Ambient Air Temperature for Operation	-4...104 °F (-20...40 °C)

Ordering and shipping details

Category	US1PC5318281
Discount Schedule	PC53
GTIN	3606480735028
Returnability	No
Country of origin	CN

Packing Units

Unit Type of Package 1	PCE
Number of Units in Package 1	1
Package 1 Height	9.6 in (24.5 cm)
Package 1 Width	11.4 in (29.0 cm)
Package 1 Length	23.03 in (58.5 cm)
Package 1 Weight	55.51 lb(US) (25.18 kg)

Offer Sustainability

Sustainable offer status	Green Premium product
California proposition 65	WARNING: This product can expose you to chemicals including: Lead and lead compounds, which is known to the State of California to cause cancer and birth defects or other reproductive harm. For more information go to www.P65Warnings.ca.gov
REACH free of SVHC	Yes
EU RoHS Directive	Pro-active compliance (Product out of EU RoHS legal scope)
Mercury free	Yes
China RoHS Regulation	China RoHS Declaration
RoHS exemption information	Yes
Environmental Disclosure	Product Environmental Profile
Circularity Profile	End Of Life Information
WEEE	The product must be disposed on European Union markets following specific waste collection and never end up in rubbish bins.

Dimensions

Dimensions of Motor

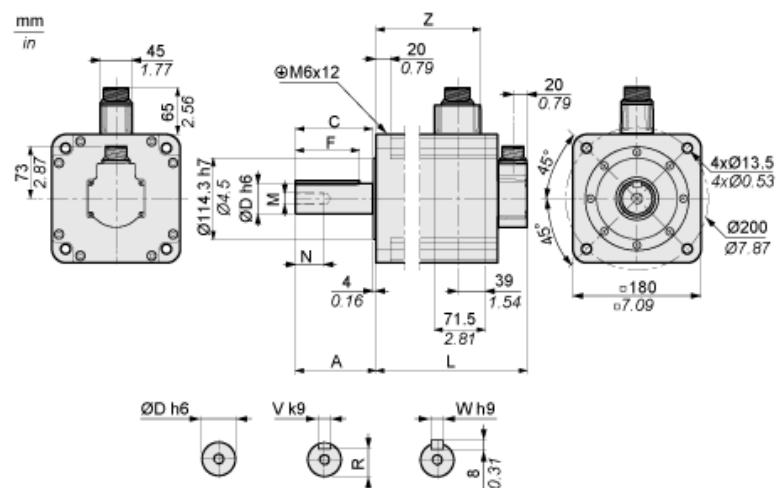

	mm	in.
L (without holding brake)	235	9.25
L (with holding brake)	279	10.98
A	79	3.11
C	73	2.87
D	35	1.38
F	63	2.48
N	28	1.10
M	M12	
R	30	1.18
V	10	0.39
W	10	0.39
Z	169	6.65

Torque/Speed Curves with 230 V Three Phase Supply Voltage

Servo Motor with LXM28AU45●●● Servo Drive

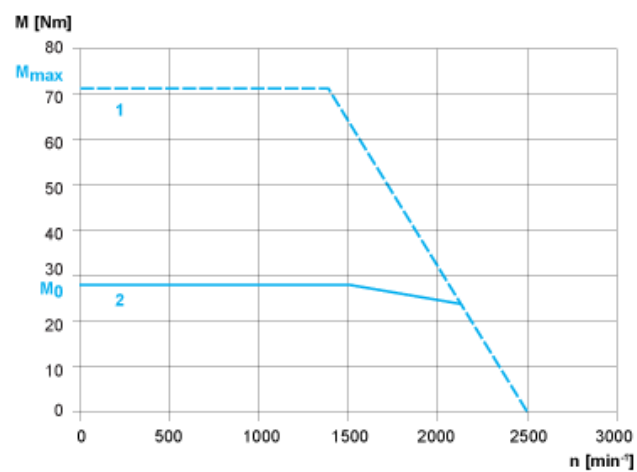

- 1 : Peak torque
2 : Continuous torque