

Inch-size One-touch Fittings

Series KQ2

Applicable Tubing: Inch Size
Connection Thread: M, R, Rc

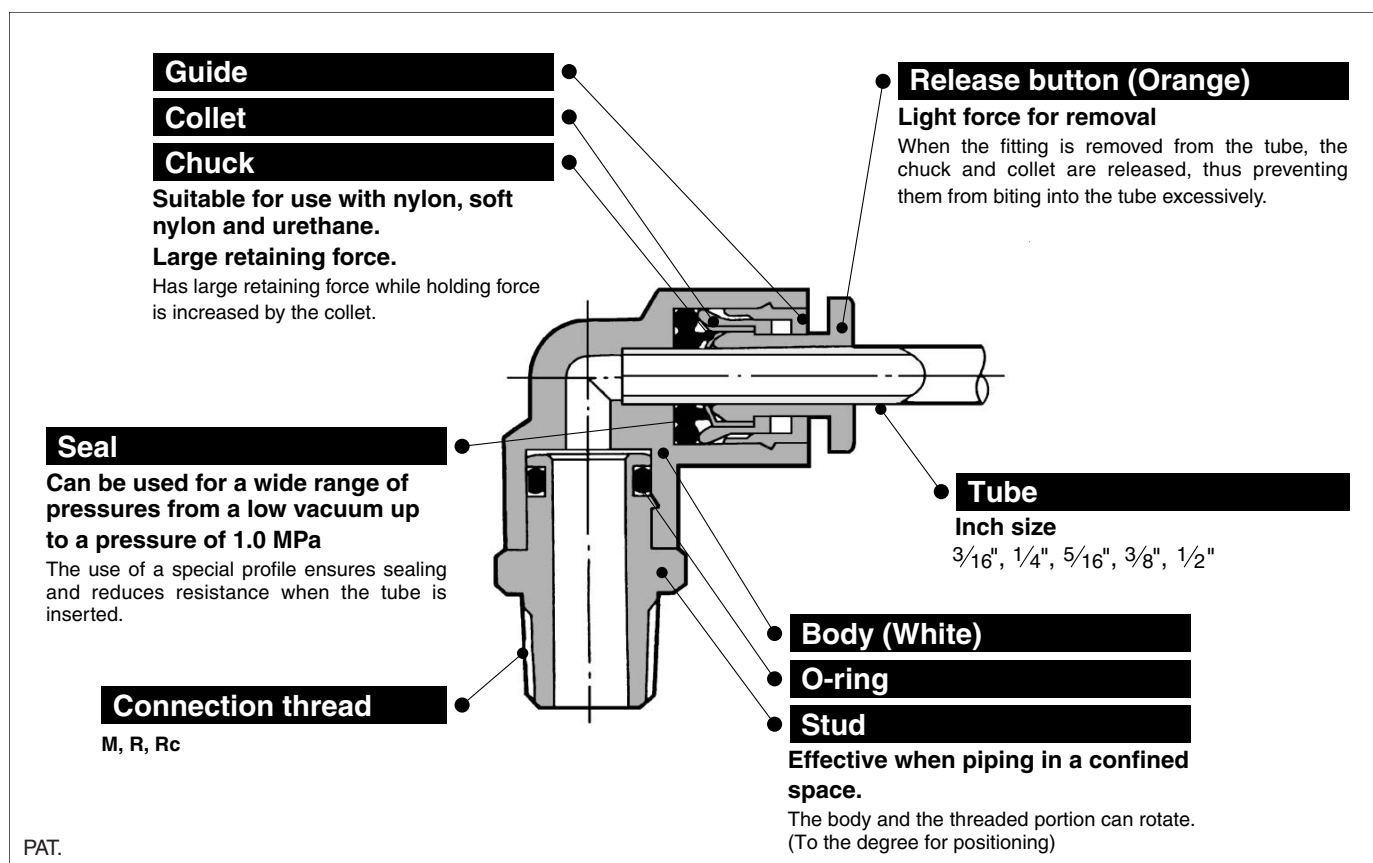

Applicable Tubing

| | |
|--------------------|---------------------------------|
| Tubing material | Nylon, Soft nylon, Polyurethane |
| Tubing O.D. (inch) | ø3/16, ø1/4, ø5/16, ø3/8, ø1/2 |

Specifications

| | | |
|-------------------------------|---|--|
| Fluid | Air/Water ^{Note)} | |
| Maximum operating pressure | 1.0 MPa | |
| Proof pressure | 3.0 MPa | |
| Ambient and fluid temperature | -5 to 60°C (Water: 0 to 40°C) (No freezing) | |
| Thread | Mounting section | JIS B 0203 (Taper thread for piping) |
| | Nut section | JIS B 0211, Class 2 (Metric fine thread) |
| Thread seal | With seal | |

 Note) Applicable for general industrial water. Please consult with SMC if using for other kinds of fluid.
Also, the surge pressure must be under the maximum operating pressure.

Principal Parts Material

| | |
|----------------|-----------------------------------|
| Body | C3604BD, PBT, PP |
| Stud | C3604BD (Thread portion) |
| Chuck | Stainless steel 304 |
| Guide | Stainless steel 304, C3604BD, POM |
| Collet | POM |
| Release button | POM |
| Seal, O-ring | NBR |
| Gasket | Stainless steel 304, NBR |

Series KQ2

Male Connector: KQ2H

KQ2H01-M5
KQ2H07-M5



<KQ2H05-M5>



<R>



| Applicable tubing O.D. (inch) | Connection thread M R | Model | H (Width across flats) | Note) øD | L | A * | M | Min. port size | Weight (g) |
|-------------------------------|-----------------------|------------|------------------------|----------|------|------|------|----------------|------------|
| 1/8 | M5 x 0.8 | KQ2H01-M5 | 7 | — | 16.7 | 13.6 | 12.7 | 2.5 | 2 |
| | 1/8 | KQ2H01-01S | 10 | — | 22 | 18 | 15.5 | | 9 |
| | 1/4 | KQ2H01-02S | 14 | — | 19.5 | 13.5 | — | | 16 |
| 3/16 | M5 x 0.8 | KQ2H05-M5 | 10.7 | — | 24 | 20.5 | — | 2.5 | 6 |
| | 1/8 | KQ2H05-01S | 11 | — | 22 | 18 | — | 3.5 | 11 |
| | 1/4 | KQ2H05-02S | 14 | — | 21 | 15 | — | — | 12 |
| 1/4 | M5 x 0.8 | KQ2H07-M5 | 11 | 10.3 | 18.4 | 15.3 | 13.6 | 2.5 | 3.3 |
| | 1/8 | KQ2H07-01S | — | — | 22.5 | 18.5 | — | 4.6 | 10 |
| | 1/4 | KQ2H07-02S | 14 | — | 23 | 17 | — | | 15 |
| | 3/8 | KQ2H07-03S | 17 | — | 23 | 16.5 | — | | 27 |
| 5/16 | 1/8 | KQ2H09-01S | 14 | — | 28 | 24 | — | 6 | 15 |
| | 1/4 | KQ2H09-02S | — | — | 26.5 | 20.5 | 18.5 | | 16 |
| | 3/8 | KQ2H09-03S | 17 | — | 22.5 | 15.5 | — | | 24 |
| 3/8 | 1/4 | KQ2H11-02S | — | — | 33.5 | 27.5 | — | 7 | 31 |
| | 3/8 | KQ2H11-03S | 17 | — | 29 | 22.5 | 21 | | 29 |
| | 1/2 | KQ2H11-04S | 22 | — | 27 | 19 | — | | 46 |
| 1/2 | 1/4 | KQ2H13-02S | — | — | 34.5 | 28.5 | — | 9 | — |
| | 3/8 | KQ2H13-03S | — | — | 33.5 | 27 | 22 | | — |
| | 1/2 | KQ2H13-04S | — | — | 30 | 22 | — | 9.6 | 44 |



* Reference dimensions after R thread installation.
Note) øD: Max. diameter

KQ2H01-M5
<KQ2H07-M5>

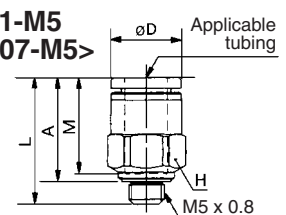

<KQ2H05>

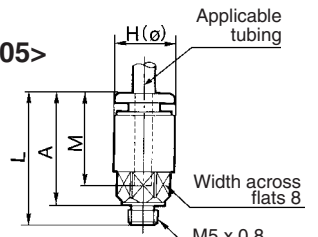

<R>

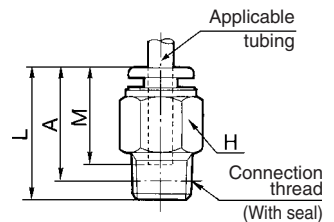

Straight Union: KQ2H



| Applicable tubing O.D. (inch) | Model | Note) øD | L | M | Min. port size | Weight (g) |
|-------------------------------|-----------|----------|------|------|----------------|------------|
| 3/16 | KQ2H05-00 | 11.4 | 34 | 16.5 | 3.5 | 4 |
| 1/4 | KQ2H07-00 | 13.2 | 34.5 | 17 | 4.6 | 4 |
| 5/16 | KQ2H09-00 | 15.2 | 38.5 | 18.5 | 6 | 6 |
| 3/8 | KQ2H11-00 | 17.9 | 42.5 | 21 | 7 | 11 |
| 1/2 | KQ2H13-00 | 21.7 | 44.5 | 22 | 9.6 | 16 |



Note) øD: Max. diameter

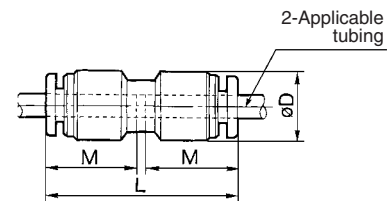

Male Elbow: KQ2L



| Applicable tubing O.D. (inch) | Connection thread R | Model | H (Width across flats) | Note) øD1 | øD2 | L1 | L2 | A * | M | Min. port size | Weight (g) |
|-------------------------------|---------------------|------------|------------------------|-----------|-----|------|------|------|------|----------------|------------|
| 1/8 | M5 x 0.8 | KQ2L01-M5 | 7 | 8.4 | — | 15.3 | 13.2 | 14.3 | 12.7 | 2.3 | 2.5 |
| 3/16 | 1/8 | KQ2L05-01S | 10 | 11.4 | 10 | 19.5 | 22.5 | 24 | 16.5 | 3.5 | 10 |
| | 1/4 | KQ2L05-02S | 14 | | | | | | | | |
| 1/4 | M5 x 0.8 | KQ2L07-M5 | 7 | 13.2 | 10 | 20.5 | 15.1 | 18 | 13.6 | 2.3 | 3.2 |
| | 1/8 | KQ2L07-01S | 10 | | | | | | | | |
| | 1/4 | KQ2L07-02S | 14 | | | | | | | | |
| | 3/8 | KQ2L07-03S | 17 | | | | | | | | |
| 5/16 | 1/8 | KQ2L09-01S | 12 | 15.2 | 12 | 23.5 | 24.5 | 28 | 18.5 | 6 | 20 |
| | 1/4 | KQ2L09-02S | 14 | | | | | | | | |
| | 3/8 | KQ2L09-03S | 17 | | | | | | | | |
| 3/8 | 1/4 | KQ2L11-02S | — | 17.9 | 17 | 25.5 | 29.5 | 32.5 | 21 | 7 | 33 |
| | 3/8 | KQ2L11-03S | 17 | | | | | | | | |
| | 1/2 | KQ2L11-04S | 22 | | | | | | | | |
| 1/2 | 1/4 | KQ2L13-02S | — | 21.7 | 17 | 28 | 31.5 | 36.5 | 22 | 9 | 28 |
| | 3/8 | KQ2L13-03S | 17 | | | | | | | | |
| | 1/2 | KQ2L13-04S | 22 | | | | 37.5 | 40 | | 9.6 | 62 |



* Reference dimensions after R thread installation.
Note) øD1: Max. diameter

<M5>

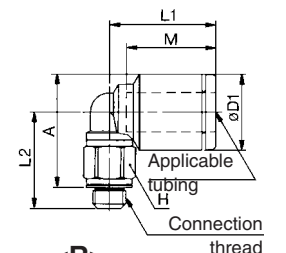

<R>

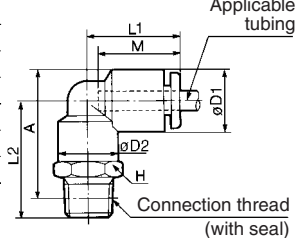

Union Elbow: KQ2L



| Applicable tubing O.D. (inch) | Model | Note) øD | L | Q | M | Min. port size | Weight (g) |
|-------------------------------|-----------|----------|------|-----|------|----------------|------------|
| 3/16 | KQ2L05-00 | 11.4 | 19.5 | 4.8 | 16.5 | 3.5 | 5 |
| 1/4 | KQ2L07-00 | 13.2 | 20.5 | 5.3 | 17 | 4.6 | 5 |
| 5/16 | KQ2L09-00 | 15.2 | 23 | 6 | 18.5 | 6 | 7 |
| 3/8 | KQ2L11-00 | 17.9 | 26 | 6.6 | 21 | 7 | 13 |
| 1/2 | KQ2L13-00 | 21.7 | 29 | 7.8 | 22 | 9.6 | 18 |



Note) øD: Max. diameter

