

Miniature Fittings Stainless Steel 316 Series *MS*

**For use in corrosive environments
Stainless steel**

Compact piping space

Tube has a large retaining force. Hose nipple assures easy installation and removal.

Line up various types

Possible for special tubing in the same direction. Accepts many styles of plastic tubing

Hose nipple and hose elbow

Accepts nylon, soft nylon, and polyurethane tubing.

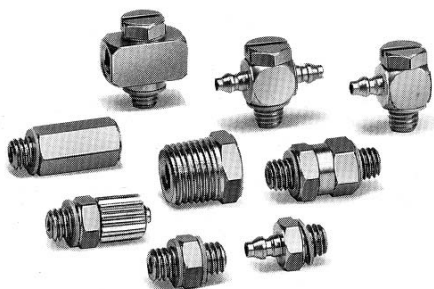

Hose nipple

Barb

Configuration for easy insertion into the tube
Holds the tube tightly.

Body

Stainless steel 316

Gasket

Low tightening torque
Tight seal

Tube

Possible for combination use of nylon tubing and polyurethane tubing.

Cap nut

Certainly hold the tube by manual clamping
Easy removal of tube by loosening
Stainless steel 316

Barb fitting

Barb

Configuration for easy insertion into the tube
Holds the tube tightly.

Body

Stainless steel 316

Tube

Gasket

Low tightening torque
Tight seal

Specifications

Applicable tubing material		Nylon	Soft nylon		Polyurethane
Applicable tubing diameter		ø4, ø2.5 ø6, ø4	ø3.18, ø2.18	ø4, ø2.5 ø6, ø4	ø3.18, ø2, ø4 ø2.5, ø6, ø4
Maximum operating pressure		1.5 MPa	1.0 MPa		0.8 MPa
Connection size		M5 (JIS B 0209 Class 2 metric coarse thread)			
Material	Body	Stainless steel 316			
	Gasket	PVC, Nylon 66, GF30%			

Series MS

Bushing: MS-5B

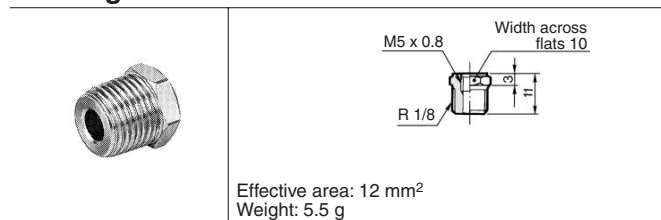

Plug: MS-5P

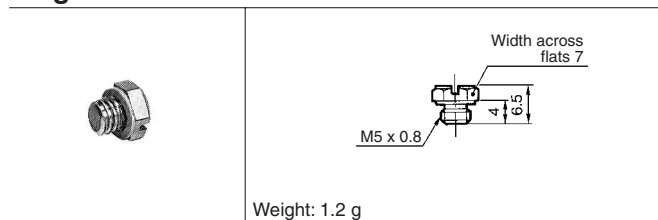

Extension Fitting: MS-5J

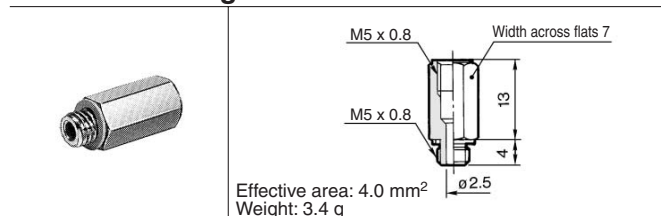

Nipple: MS-5N

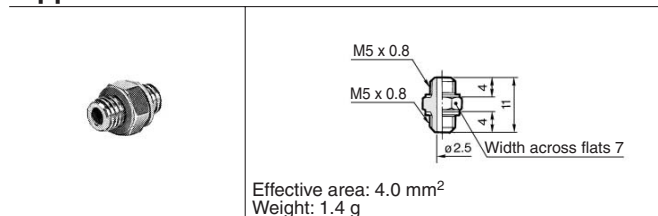

Barb Tee for Soft Tube: MS-5ATHU-3/4/6

Model	A1	A2	C	øD	Effective area (mm ²)	Weight (g)
MS-5ATHU-3	8	8.3	4.5	1.6	1.1	3.4
MS-5ATHU-4	8.8	8.8	5.0	1.8	1.4	3.6
MS-5ATHU-6	10.8	10.8	7.0	2.5	2.4	4.2

MS-5ATHU-3/4

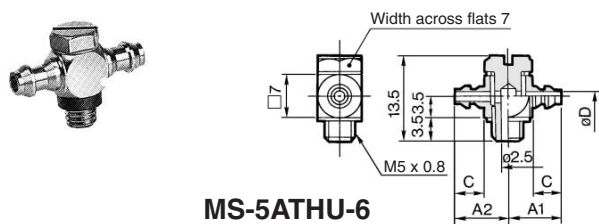

MS-5ATHU-6

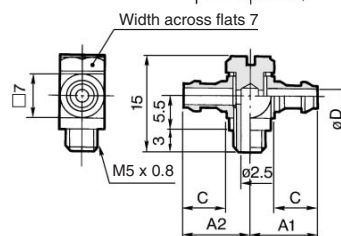

Universal Nipple: MS-5UN

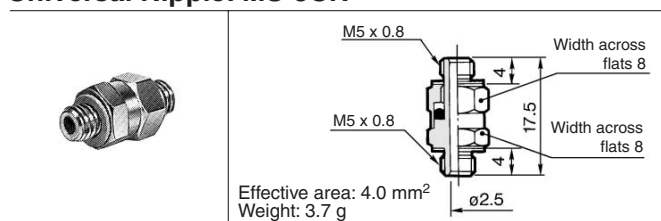

Gasket: M-5G1, M-5GH

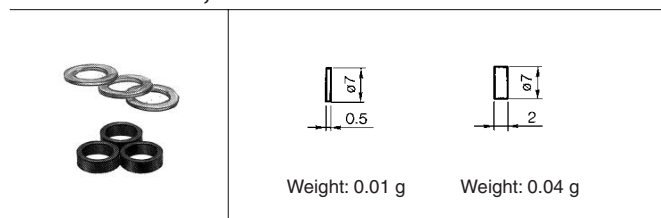

⚠ Precautions

Be sure to read before handling. Refer to pages 15-8-3 to 15-8-4 for Safety Instructions and Common Precautions on the products mentioned in this catalog, and refer to pages 15-1-10 to 15-1-11 for Precautions on every series.

Tightening of M5 Thread

⚠ Caution

1. Tighten by hand, and give it an additional 1/4 rotation with a wrench. (The additional rotation should be doubled to 1/2 when using the universal elbow, universal tee, etc. which have two gaskets.) If tightened excessively, thread portion may be damaged and gasket may be deformed. This will cause air leakage. On the contrary, if tightened insufficiently, thread may loosen causing air leakage.

Use of Tube with Hose Nipple

⚠ Caution

1. Cut the tube perpendicularly to the tube axis to a little longer length than required (use tube cutter "TK-1", "TK-2" or "TK-3").
2. Pass the tube through the cap nut.
3. Push the tube until it comes to the end of the barb portion, or it may cause air leakage or hose releasing.
4. Tighten the cap nut firmly by hand on the fitting.

Use of Tube with Barb Fitting

⚠ Caution

1. Cut the tube perpendicularly to the tube axis to a little longer length than required (use tube cutter "TK-1", "TK-2" or "TK-3").
2. Push the tube until it comes to the end of the barb portion, or it may cause air leakage or release hose.