

# Related Products:

## Tube Releasing Tool

# Series TG

- For attaching and dettaching tubes for One-touch fittings mounted in a narrow space or on manifolds.
- Easy one-hand operation
- Available for two sizes of applicable tubes. Exchangeable easily with one hand.

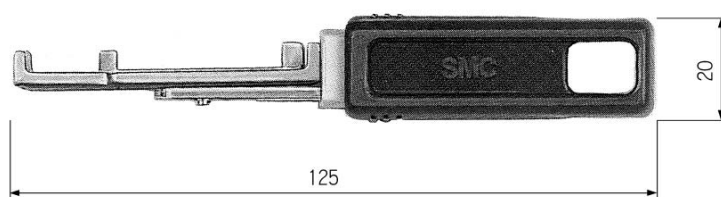

Model	Applicable tubing size		Applicable tubing material	Color	Weight
TG-1	Metric size	ø4, ø6	Nylon, Soft nylon Polyurethane	Blue	33 g
TG-2	Inch size	ø1/8", ø1/4"		Red	

### How to Use

#### ⚠ Caution

##### Process

1. Tool edge should be pushed straightforward into the edge of the release button along with the tube in the axial fitting direction.

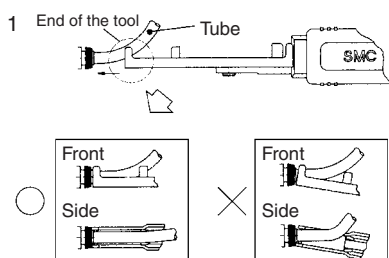

2. After inserting, grasp the handle tightly and insert the end of the tubing to the stroke end.

[Note) Insert firmly to the guard against an accidental tube release.]

3. After inserting end of tube, relax your grip on the tool. Returning force of spring releases the tube.

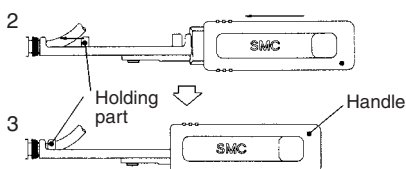

##### Size change

Push both sides at once to release. Reverse and fix at the same position as before.

Applicable tube size is indicated on the back side.

