

- Four-pin Connectors ideal for power supply lines.
- Complies with IP67.
- Product line includes T-branch Connectors and cables with Connectors.

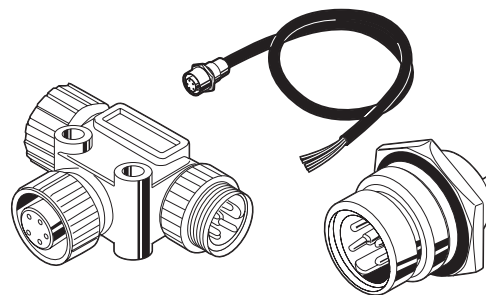

### ■ Ratings and Characteristics

Item	XS4□-D421-1□□-A Cables with Connector	XS4R-D424-5 T-branch Connectors	XS4P-D421-1C5-A Panel Mounting Cables	XS4M-D421-1 Panel Mounting Cables
Rated current	10 A			
Rated voltage	125 VDC			
Contact resistance (See note 1.)	30 mΩ max. (at 20 mVDC, 100 mA max.)			
Insulation resistance	1,000 MΩ min. (at 500 VDC)			
Dielectric strength (See note 2.)	1,500 VAC for 1 min (leakage current: 1 mA max.)			
Operating temperature	-20 to 65°C			
Storage temperature	-25 to 70°C			
Enclosure rating	IEC IP67			
Insertion durability	200 times			
Cable holding strength	98 N/15 s	---	98 N/15 s	---
Vibration	No break in current for simple harmonic motion (10 to 500 Hz, 1.52-mm amplitude or 100 m/s <sup>2</sup> whichever has the smallest amplitude) for more than 1 μs min.			

- Note:**
1. The contact resistance of the Connector.
  2. The dielectric strength of the Connector.
  3. The rated current between heavy gauge wires is 8 A.

### ■ Materials and Finish

XS4□ (4-pin Type for Power Supplies)		
Connector	Contact block	Polyester elastomer (UL94V-0)/light gray
	Contact	Brass/1.5-μm nickel base, 0.4-μm gold plating
	Anchor	Copper/nickel plated
	Body (See note.)	Brass/nickel plated
	Cover	Polyester elastomer (UL94V-0)/black
	O ring	Rubber
Cable	Model (manufacturer)	UL STO cable (Shinagawa Densen) or the equivalent
	Cores	AWG16 × 4 cores (black, white, red, and green)
	Diameter	Approximately 11 dia.
	Sheath color	Black

**Note:** Only panel-mounted bodies are used.

## ■ Ordering Information

### For Power Supplies (4-pin Type)

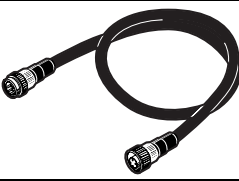
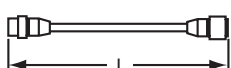
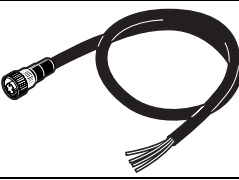
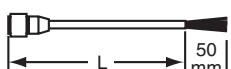
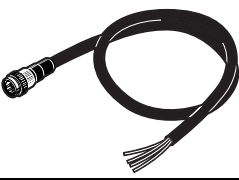
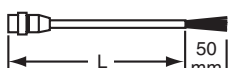
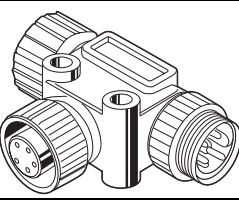
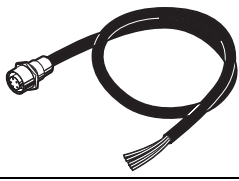
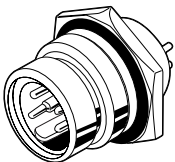
Appearance	Type	Cable length (m)	Model
		1	XS4W-D421-101-A
		2	XS4W-D421-102-A
		5	XS4W-D421-105-A
		10	XS4W-D421-110-A
		1	XS4F-D421-101-A
		2	XS4F-D421-102-A
		5	XS4F-D421-105-A
		10	XS4F-D421-110-A
		1	XS4H-D421-101-A
		2	XS4H-D421-102-A
		5	XS4H-D421-105-A
		10	XS4H-D421-110-A
	T-branch Connectors	---	XS4R-D424-5
	Panel-mounted Connectors (Sockets) with 50-cm cable	---	XS4P-D421-1C5-A
	Panel-mounted Connectors (Plugs) with DIP terminals	---	XS4M-D421-1

# ■ Dimensions

## XS4W-D421-1□□-A Cables with Connectors at Both Ends (4-pin Type for Power Supplies)

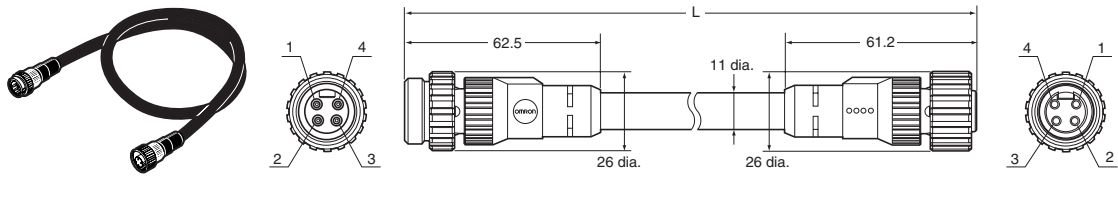

### Wiring

Terminal No.	Color
1	Black
2	White
3	Red
4	Green

## XS4F-D421-1□□-A Cables with a Connector on One End (4-pin Sockets for Power Supplies)

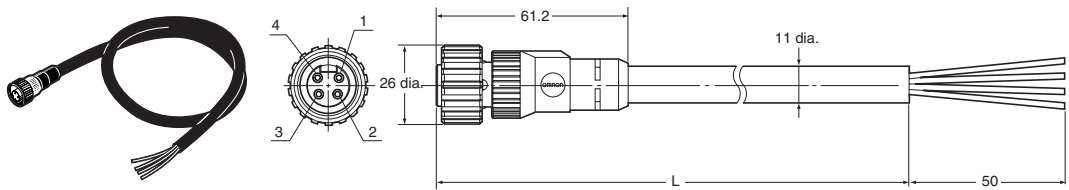

### Wiring

Terminal No.	Color
1	Black
2	White
3	Red
4	Green

## XS4H-D421-1□□-A Cables with a Connector on One End (4-pin Plugs for Power Supplies)

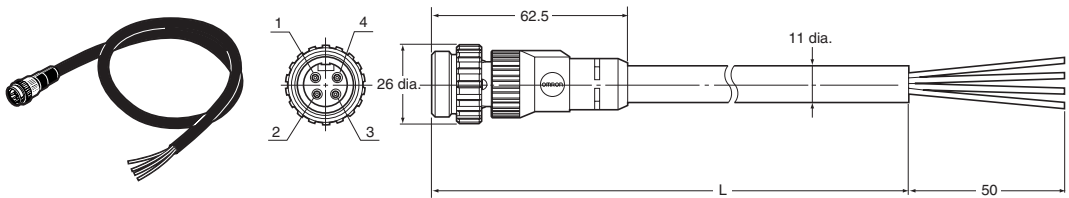

### Wiring

Terminal No.	Color
1	Black
2	White
3	Red
4	Green

## XS4P-D421-1C5-A Panel Mounting Connectors (4-pin Sockets for Power Supplies)

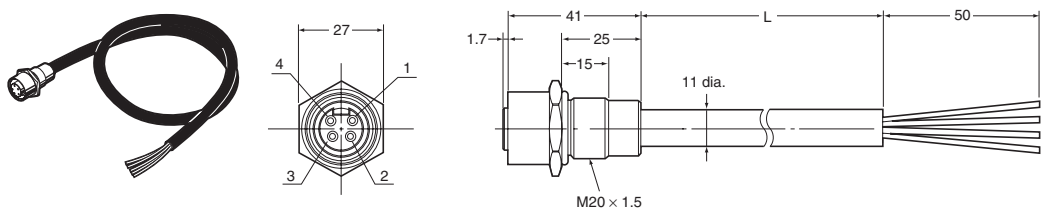

### Panel dimensions

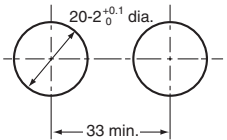

**Note:** The rubber bushing and nut used for in-panel mounting are supplied.

### Wiring

Terminal No.	Color
1	Black
2	White
3	Red
4	Green

## XS4R-D424-5 T-branch Connectors (4-pin Type for Power Supplies)

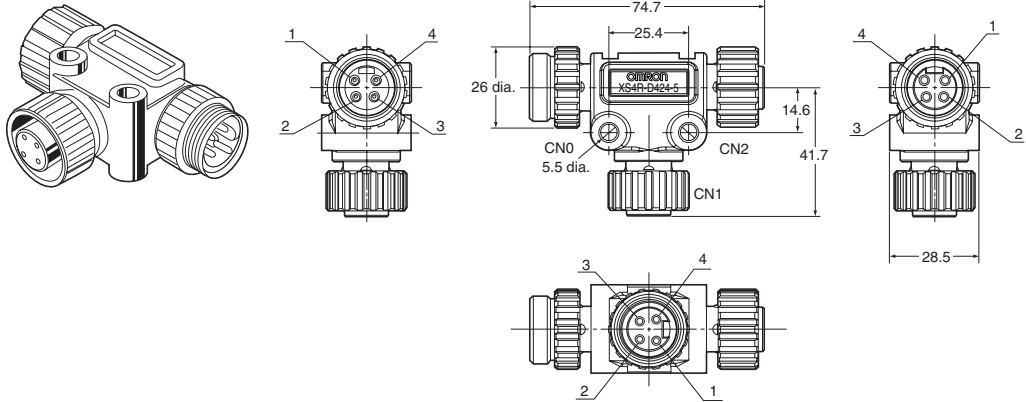

### Wiring Diagram

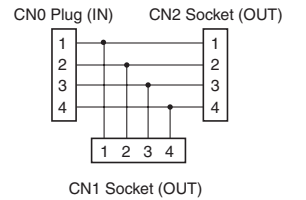

## XS4M-D421-1 Panel Mounting Connectors (4-pin Plugs for Power Supplies)

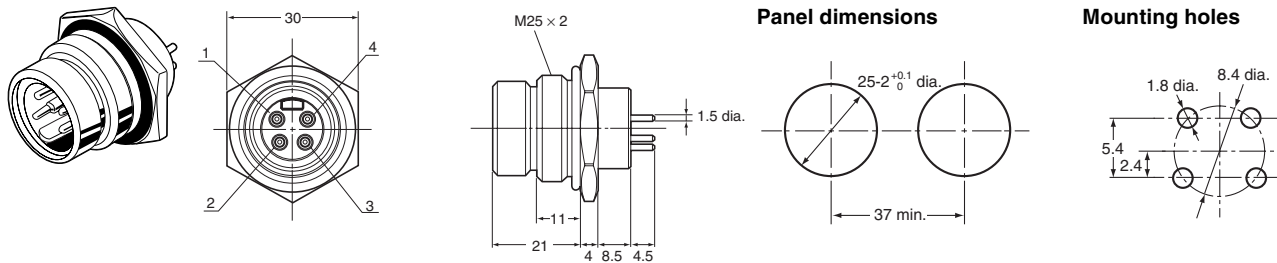

**Note:** The rubber bushing and nut used for in-panel mounting are supplied.

## XS4Z-11 Waterproof Caps (for Plugs)

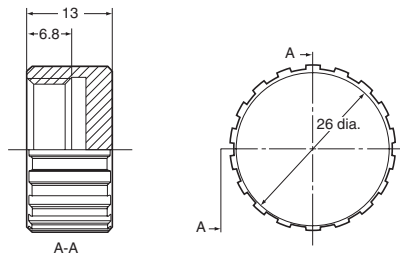

## XS4Z-12 Waterproof Caps (for Sockets)

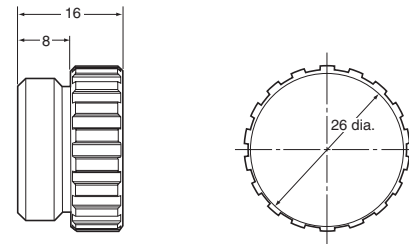

## ■ Precautions

### Correct Use

#### Handling

- Do not connect or disconnect Connectors with the power turned ON.
- Hold the Connector when connecting or disconnecting Connectors.
- Never pull on the cable to disconnect a Connector.
- Before mating Connectors, insert the matable parts fully. Use a torque of 0.7 to 0.8 N·m to tighten the Anchor, and do so carefully to prevent damage to the threads.  
Do not use pliers or other tools because they may damage the Anchor. Anchors that are not properly tightened cannot maintain the enclosure rating and may become loose with vibration.
- The body is made of molded resin. Do not step on it or place heavy objects on top of it.

#### Enclosure Rating

- The IP67 enclosure rating is not completely waterproof. Do not use the product in locations where it will be continually under water.

#### Storage

Observe the following long-term storage precautions.

1. Make sure the storage location is dust- and moisture-proof.
2. Do not store near locations generating ammonia gas, sulfurized gas, or other harmful gases.